

CABLINE®-CA II Connector Plug Housing Assembly

Part No. 20680-0**T-01

Part No. 21067-0**T-01

Packing Standard

7	S25017	December 27, 2024	K.Hara	T.Tanigawa	H.Ikari
6	S20445	August 26, 2020	A.Koyanagi	T.Kurachi	Y.Shimada
5	S20244	April 30, 2020	A.Koyanagi	T.Kurachi	Y.Shimada
4	S18090	April 16, 2018	M.Nakamura	T.Kurachi	Y.Shimada
Rev.	ECN	Date	Prepared by	Checked by	Approved by

1. Product Name(s) and Parts Number(s)

CABLINE-CA II Connector Plug Housing Assembly, 20680-0**T-01 / 21067-0**T-01

2. Packing Material

Pos.	TRAY				SHIPPING CARTON	PACKING CARTON
	MEASURE	POCKET WIDTH (REFER FIG.2)	DEPTH	POCKET QTY.		
20P	360×165	29.0×8.0	3.5	100 (TOTAL)	385×175×90 OUTER	406×406×214 OUTER
30P						
40P						
50P						
60P		32.0×8.0				

Pos.	PLASTIC BAG	DESICCANT
	SIZE	QUANTITY (1 BAG)
20P	460×305	3g×1
30P		
40P		
50P		
60P		

3. Packing Quantity

Pos.	QTY. PER DITCH	QTY. PER TRAY	QTY. PER SHIPPING CARTON (TRAY QTY.)	QTY. PER PACKING CARTON (S CARTON QTY.)
20P	1	100	2000 (20 TRAYS)	8000 (4 BOXES)
30P				
40P				
50P				
60P				

4. Label

The diagram shows a rectangular label with the following layout:

- Top Left:** Fields for P/N (1), QTY (2), and LOT (3).
- Top Right:** CHECK field (6).
- Bottom Left:** QR Code (5) and a small '10' callout below it.
- Bottom Middle:** NAME field (4) containing a 'RoHS Compliant' logo, and MADE IN ***** (7) with a '9' callout below it.
- Bottom Right:** REMARK field.
- Far Right:** A circular Recycle Mark (8) with '05 PP' and the Chinese characters '托盘' (Tray) above it, and an 'HF' logo below it.

- ① Part Number
- ② Quantity
- ③ Ten Digits Product Lot Number

Y	Y	M	M	D	D	#	#	#	#
Year		Month		Day		Four Digit Code for I-PEX usage			

- ④ Product Name
- ⑤ QR Code
- ⑥ Check Stamp
- ⑦ Country of Origin
- ⑧ Recycle Mark and Compliance Mark
- ⑨ Logo Mark
- ⑩ Manufacture Name

5. Packing Method

Direction of products putting in tray.

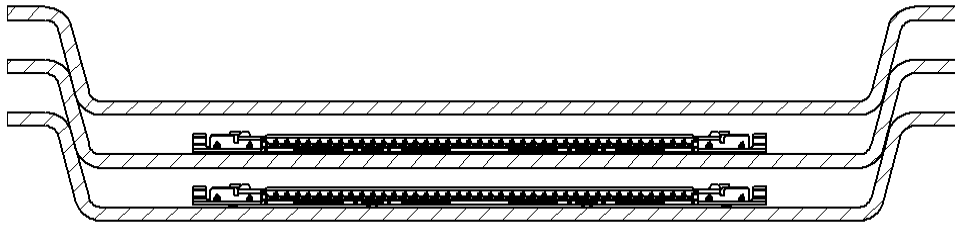

Fig.1

[NOTE] Piling the tray to the same direction and putting a lid on the tray with empty tray.

※ Move metal shell downward, and pack it.

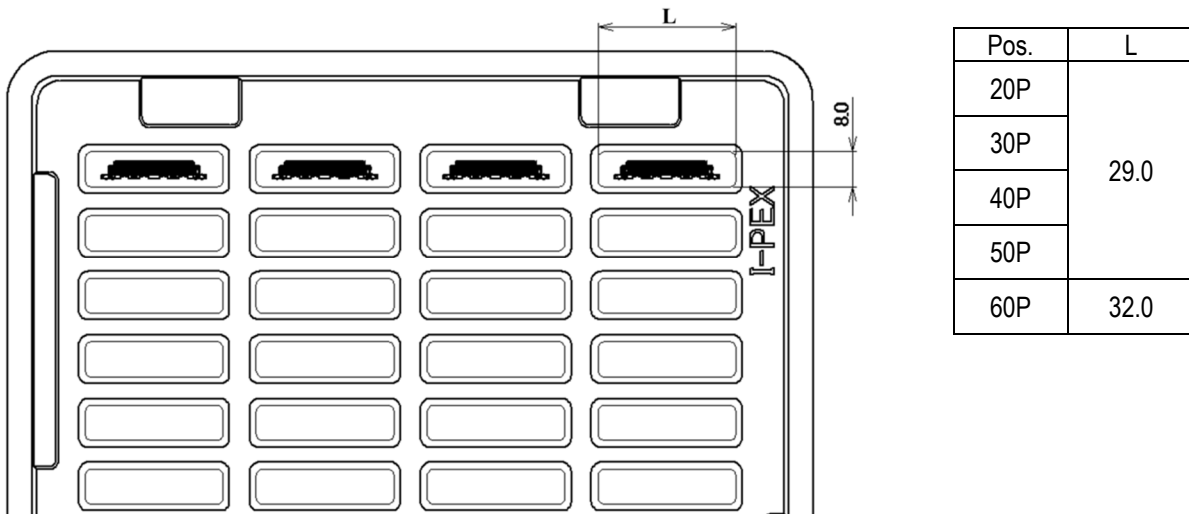
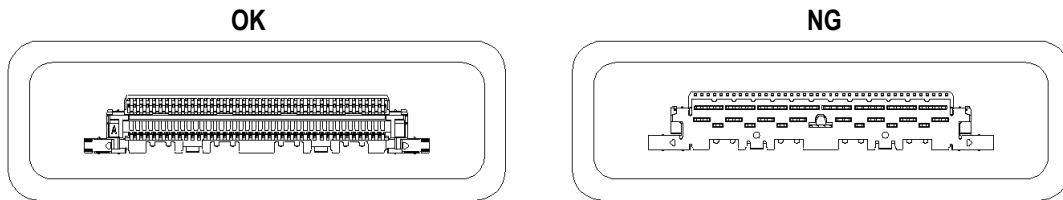

Fig.2

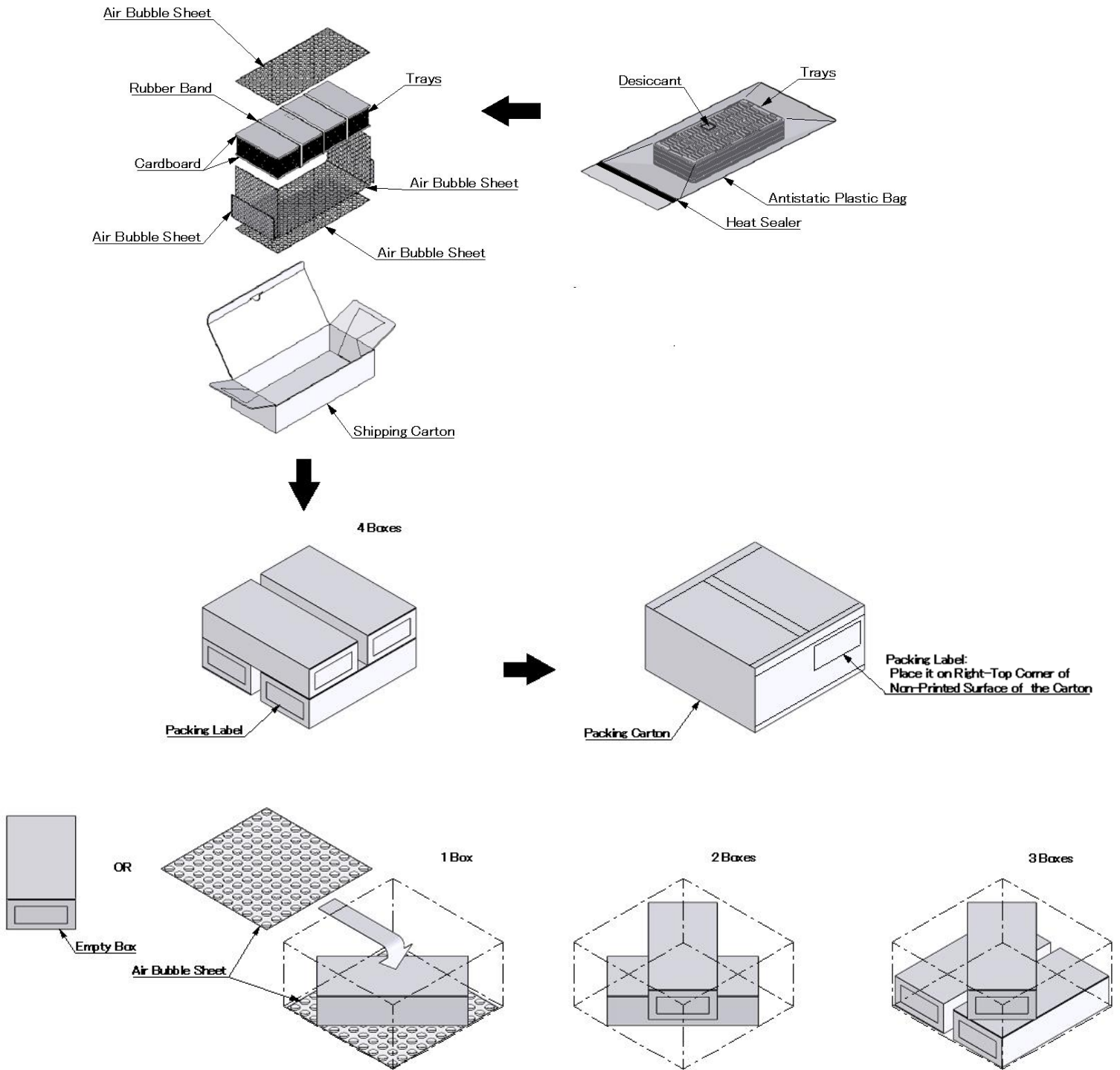

Fig.3

※If operator pulls up the rubber band when they take out parts, there is possibility that tray bundle loosen and the parts drop out.

Please note the taking up method.

