



- ✓ Rugged, secure and reliable I/O connector for multiple applications
- ✓ Durable up to 5,000 mating cycles
- ✓ Wide selection of mating directions and circuit sizes

Pin counts:

Range	Up to 240
Available	80, 100, 120, 160, 200, 240

*Please inquire for pin counts not listed or outside of the pin count range.

Receptacle P/N		30***-**0T-F, **F
Plug P/N		30***-**0T-F, **F
Board pitch (mm)		0.635
Size (mm)	Height	9.9 ~ 16.9 mm (Plug) 11.13 ~ 22.53 mm (Rece)
	Depth	9.9 ~ 17.8 mm (Plug) 11.13 ~ 22.53 mm (Rece)
	Width	36.0 ~ 96.10 mm (Plug / Rece)
Rating	Amperage	0.5 A AC/DC (Per a Contact))
	Voltage	250 V AC/DC (Per a contact)
	Service Temperature	-65 °C +85 °C

Rugged, secure and reliable I/O connector for multiple applications

Slim Type Plug :

Part Number	Pin Count	Mating Type	Contact Type	Appearance
30029	80	Right Angle	2 Sequence	
30046	160		2 Sequence	

Slim Type Receptacle :

Part Number	Pin Count	Mating Type	Appearance
30030	80	Right Angle	
30047	160		
30056	160	Vertical	

Durable up to 5,000 mating cycles

Right Angle Plug – Right Angle Receptacle pair

Part Number

- Plug 30029, 30046
- Receptacle 30030, 30047

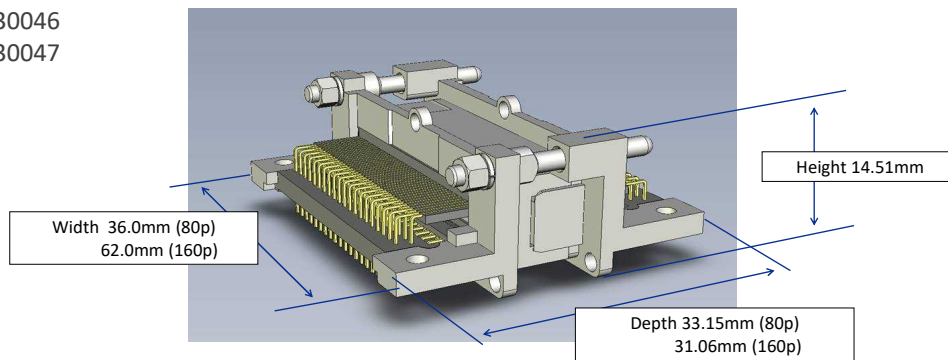

Wide selection of mating directions and circuit sizes

Right Angle Plug – Vertical Receptacle pair

Part Number

- Plug 30046
- Receptacle 30056

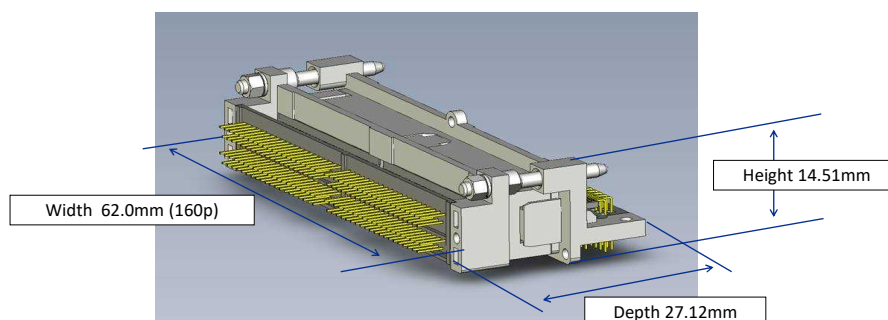

MINIDOCK™ SLIM

Component Parts Detail

Plug Assembly :

Recommended P/N		30029-080T-01F		BOSS	NOTES
PART NO.	CIRCUIT No./CONTACT LENGTH				
	LONG PIN	MIDDLE PIN			
30029-080T-F	1, 2, 79, 80	OTHERS	WITHOUT BOSS	WITH SCREW	
30029-080T-01F			WITHOUT SCREW		
30029-080T-02F			WITH SCREW		
30029-080T-03F			WITHOUT SCREW		

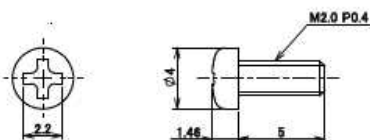
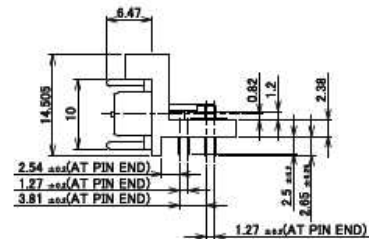
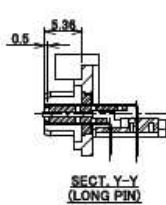
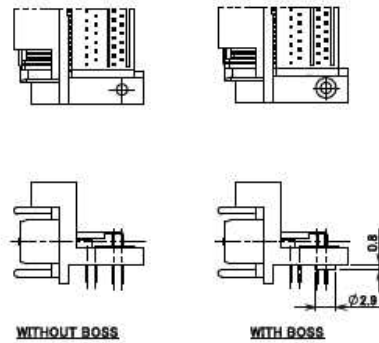
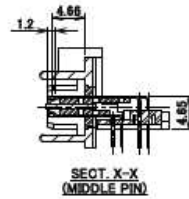
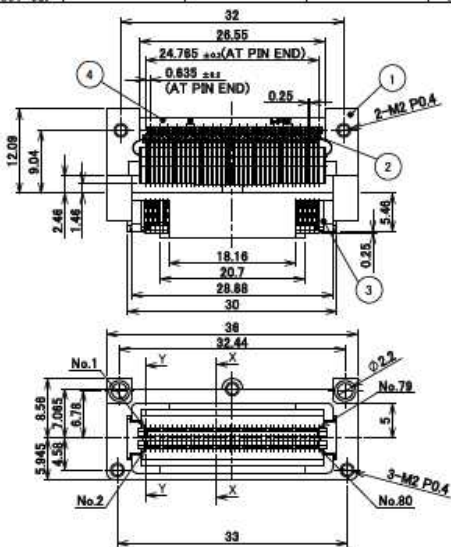

SCREW 90042-001
(S = 5/1)

NO.	DISCRPTION	MATERIAL	FINISH, REMARKS
4	LOCATOR PLATE	PA	BLACK UL94V-0
3	PLUG INSULATOR	PPS	BLACK UL94V-0
2	PLUG CONTACT	COPPER ALLOY	CONTACT PART Au FLASH OVER Pd/Ni SOLDER TAIL Au FLASH
1	PLUG SHELL	Zn ALLOY	NI PLATING

NOTE
1. CONNECTOR TO BE MATED: 30030

Rev. 14

Plug Assembly :

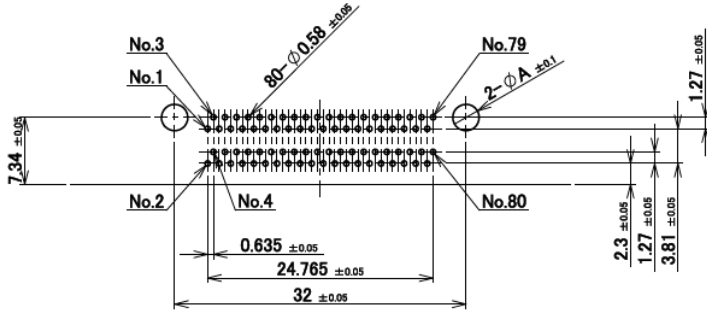

RECOMMENDED FOOTPRINT PATTERN $t=1.6$

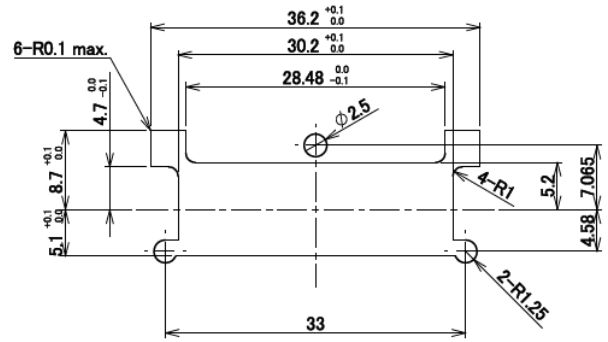

RECOMMENDED PANEL

Rev. 14

Plug Assembly :

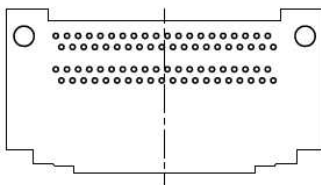

CONNECTOR ON RECOMMENDED FOOTPRINT PATTERN

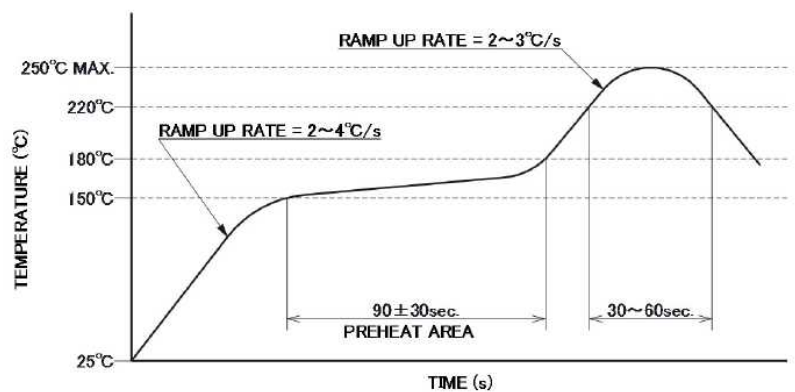

REFLOW TEMPERATURE PROFILE
SENJU METAL INDUSTRY CO., LTD. : M705-SHF(Sn96.5 Ag3.0 Cu0.5)

Rev. 14

Plug Assembly :

ITEMS	SPECIFICATION
RATING VOLTAGE	250V AC (PER A CONTACT)
RATING AMPERAGE (FOR CONTACT)	0.5A AC/DC (PER A CONTACT)
OPERATING TEMPERATURE	208~358K(-65°C~+85°C)
OPERATING HUMIDITY	85% MAX.(NON-CONDENSING)
CONTACT RESISTANCE (FOR CONTACT)	INITIAL : 70mohm MAX. / AFTER TEST : \leq 25mohm MAX.
INSULATION RESISTANCE	INITIAL : 10,000Mohm MIN. / AFTER TEST : 1,000Mohm MIN.
DIELECTRIC WITHSTANDING VOLTAGE	AC500V 1min
DURABILITY	5,000 CYCLES
MATING FORCE (INITIAL)	0.9N/pos. MAX.
UNMATING FORCE (AFTER TEST)	0.059N/pos. MIN.
COPLANARITY	-
PRODUCT SPECIFICATION	PRS-1011
TEST REPORT	TR-9020
PACKING STANDARD	300-141
INSTRUCTION MANUAL	-
APPEARANCE CRITERIA No.	QLS-A***

Rev. 14

Plug Assembly :

Recommended P/N		30046-160T-F		CIRCUIT No./L=CONTACT LENGTH		NOTES
PART NO.	NO. OF POS.	Y (MATING TRAVEL OF C/T)	L=5.36	L=4.86		
30046-160T-F	160P	1.4, 2.1	No.1, 2, 79, 80, 81, 82, 159, 160	OTHERS	-	WITH SCREW
30046-160T-01F						NO SCREW
30046-160T-02F						WITH SCREW
30046-160T-03F						WITH SCREW

◆ MARK MEANS NOT AVAILABLE.

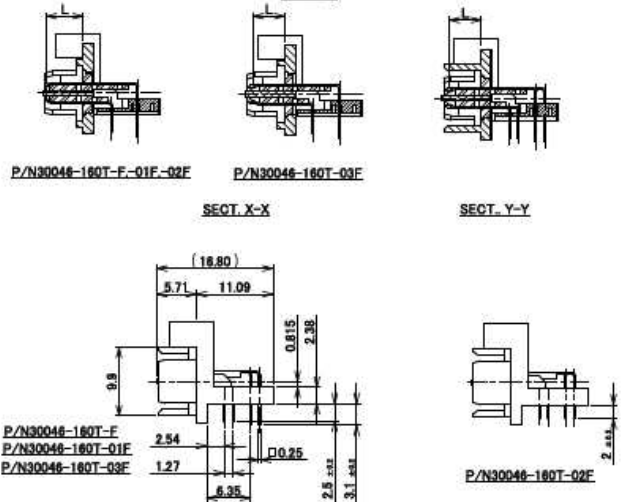
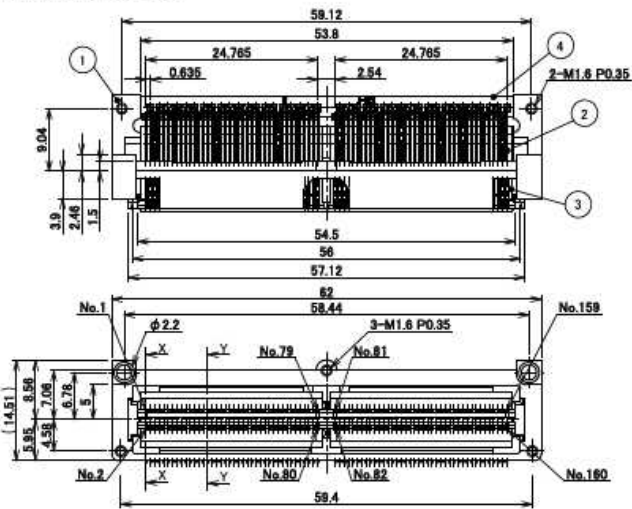
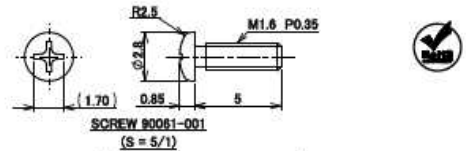

NO.	DESCRIPTION	MATERIAL	FINISH, REMARKS
4	LOCATOR PLATE	PA	BLACK UL94V-0
3	PLUG INSULATOR	PPS	BLACK UL94V-0
2	PLUG CONTACT	COPPER ALLOY	Au PLATING
1	PLUG SHELL	Zn ALLOY	NI PLATING

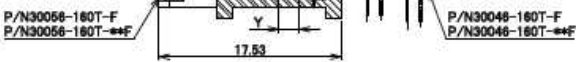

- NOTES
- CONNECTOR TO BE MATED : 30047, 30058
 - ALLOWANCE DIMENSION OF GUIDE PIN : 0.8 mm

Rev. 14

Plug Assembly :

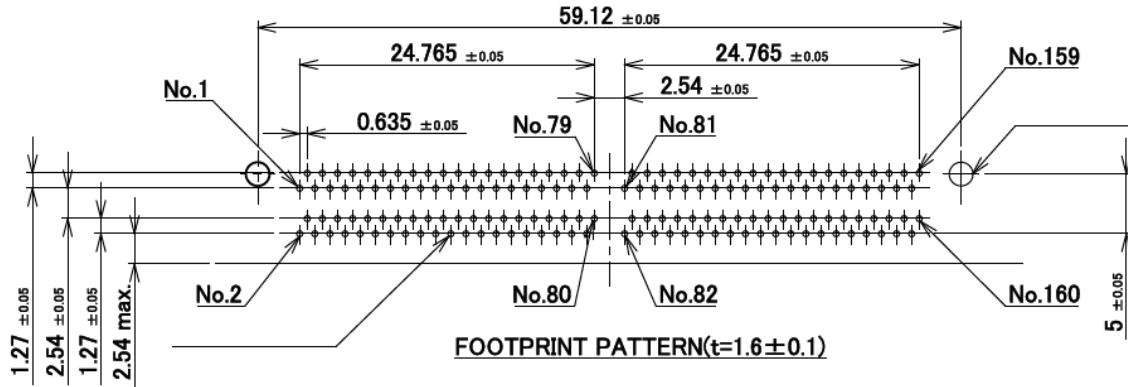

Rev. 14

Plug Assembly :

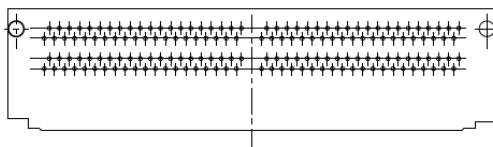

CONNECTOR ON RECOMMENDED FOOTPRINT PATTERN

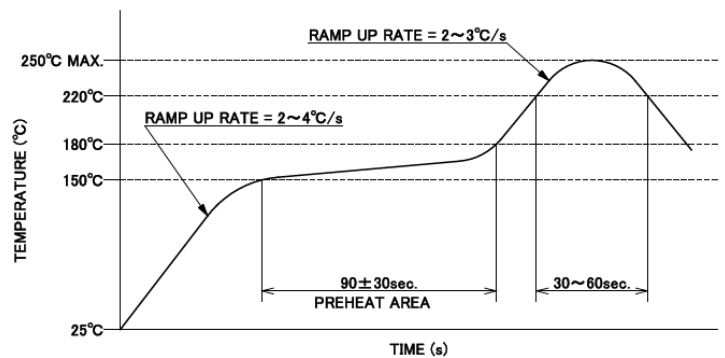

REFLOW TEMPERATURE PROFILE
SENJU METAL INDUSTRY CO., LTD. : M705-SHF(Sn96.5 Ag3.0 Cu0.5)

Rev. 14

Plug Assembly :

ITEMS	SPECIFICATION
RATING VOLTAGE	250V AC (PER A CONTACT)
RATING AMPERAGE (FOR CONTACT)	0.5A AC/DC (PER A CONTACT)/ **A AC/DC(TOTAL)
OPERATING TEMPERATURE	208~358K(-65°C~+85°C)
OPERATING HUMIDITY	85% MAX.(NON-CONDENSING)
CONTACT RESISTANCE (FOR CONTACT)	INITIAL : 70mohm MAX. / AFTER TEST : \leq 25mohm MAX.
INSULATION RESISTANCE	INITIAL : 10,000Mohm MIN. / AFTER TEST : 1,000MIN.
DIELECTRIC WITHSTANDING VOLTAGE	AC500V 1min
DURABILITY	5,000 CYCLES
MATING FORCE (INITIAL / AFTER TEST)	0.9N/pos. MAX.
UNMATING FORCE (INITIAL / AFTER TEST)	0.059N/pos. MIN.
COPLANARITY	-
PRODUCT SPECIFICATION	PRS-1011
TEST REPORT	TR-9020
PACKING STANDARD	300-106
INSTRUCTION MANUAL	-

Rev. 14

Receptacle Assembly :

Recommended P/N 30030-080T-03F

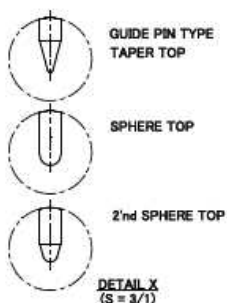
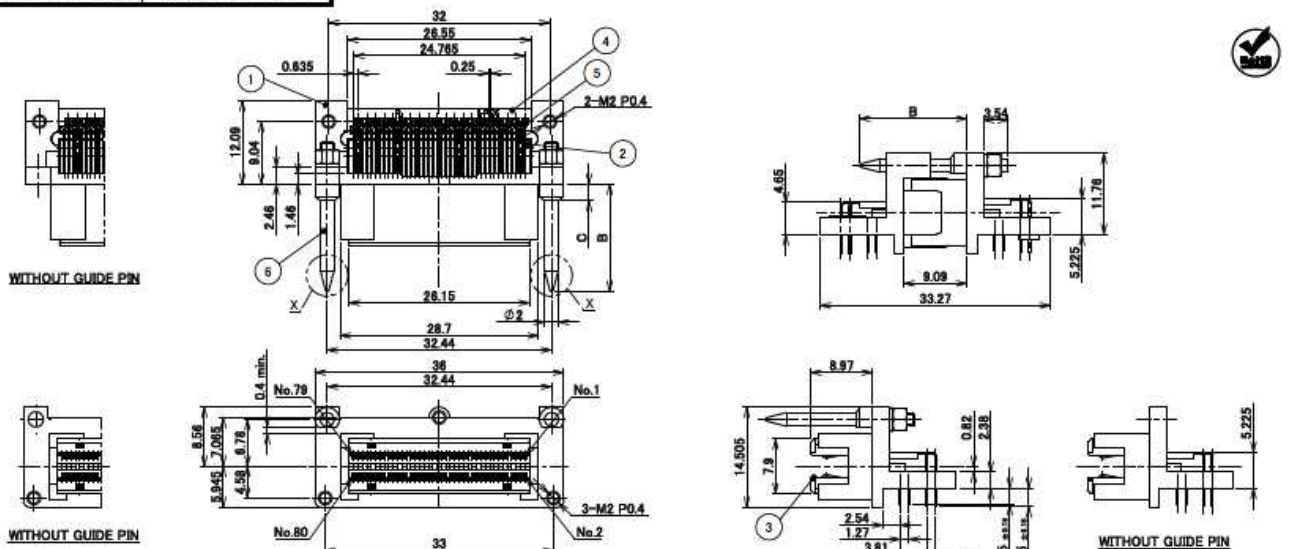

6	GUIDE PIN	STAINLESS STEEL (30030-080T-017*/018*) STEEL (EXCEPT 30030-080T-017*/018*)	NO PLATING
5	CONTACT	COPPER ALLOY	CONTACT AREA: Au FLASH OVER Pd/Ni SOLDER TAIL: Au FLASH
4	LOCATOR PLATE	PA	BLACK, UL94V-0
3	CONTACT GUIDE	PPS	BLACK, UL94V-0
2	INSULATOR	PPS	BLACK, UL94V-0
1	SHELL	Zn ALLOY	Ni PLATING
NO.	DISCRIPTION	MATERIAL	FINISH , REMARKS

NOTES
1. CONNECTOR TO BE MATED: 30029

Rev. 17

Receptacle Assembly :

PART No.	GUIDE PIN TYPE	BOSS	A	B	C	NOTES
30030-080T-F	TAPER TOP	WITHOUT BOSS	2.3	15.5	2.4	WITH SCREW
30030-080T-01F	SPHERE TOP					WITHOUT SCREW
30030-080T-02F	TAPER TOP					WITH SCREW
30030-080T-03F	SPHERE TOP					WITHOUT SCREW
30030-080T-04F	WITHOUT GUIDE PIN (1413-00*)					WITH SCREW
30030-080T-05F	(WITHOUT NUT, WASHER)	WITHOUT SCREW				
30030-080T-06F	TAPER TOP	WITH BOSS	3.1	15.5	2.4	WITH SCREW
30030-080T-07F	SPHERE TOP					WITHOUT SCREW
30030-080T-08F	TAPER TOP					WITH SCREW
30030-080T-09F	SPHERE TOP					WITHOUT SCREW
30030-080T-10F	WITHOUT GUIDE PIN (1413-00*)					WITH SCREW
30030-080T-11F	(WITHOUT NUT, WASHER)	WITHOUT SCREW				
30030-080T-12F	2 nd SPHERE TOP	WITHOUT BOSS	2.3	15.5	2.4	WITH SCREW
30030-080T-13F		WITH BOSS	3.1			WITHOUT SCREW
30030-080T-14F	SPHERE TOP	WITHOUT BOSS	2.3	13.0	2.4	WITH SCREW
30030-080T-15F	TAPER TOP (MTL : STAINLESS STEEL)	WITHOUT BOSS	2.3	15.5		WITHOUT SCREW
30030-080T-16F	SPHERE TOP (MTL : STAINLESS STEEL)	WITHOUT BOSS	2.3	15.5		WITHOUT SCREW
30030-080T-17F	SPHERE TOP (MTL : STAINLESS STEEL)	WITHOUT BOSS	2.3	15.5	2.4	WITHOUT SCREW
30030-080T-18F	SPHERE TOP (MTL : STAINLESS STEEL)	WITHOUT BOSS	2.3	15.5		WITHOUT SCREW
30030-080T-19F	SPHERE TOP	WITH BOSS	3.1	14.0	4.0	WITH SCREW

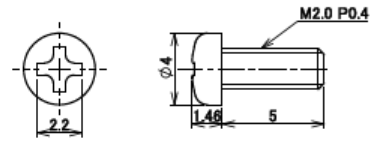

SCREW 90042-001 (S = 5/1)

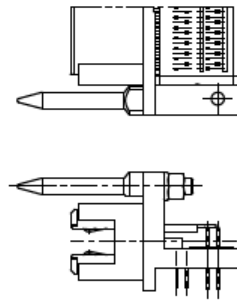

WITHOUT BOSS

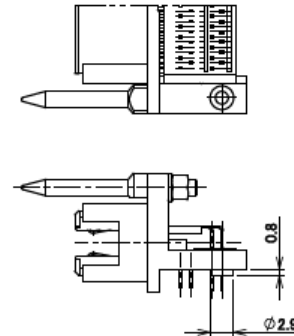

WITH BOSS

Rev. 17

Receptacle Assembly :

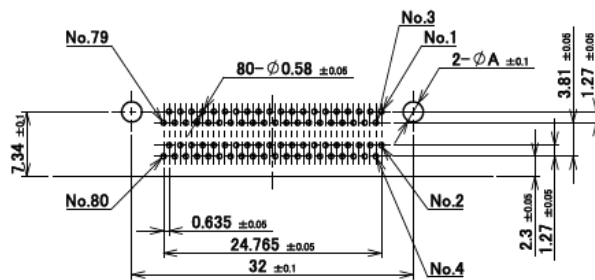

RECOMMENDED FOOTPRINT PATTERN t=1.6

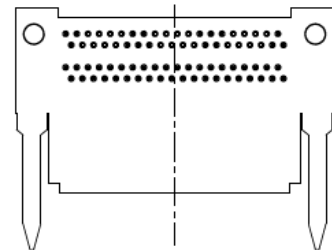

CONNECTOR ON RECOMMENDED FOOTPRINT PATTERN

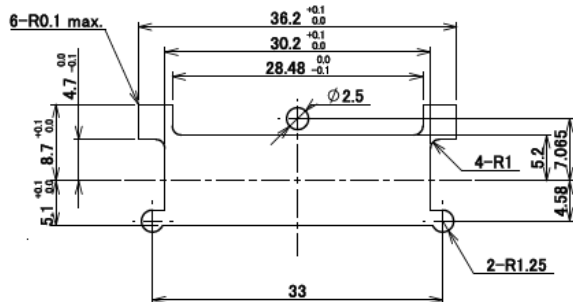

RECOMMENDED PANEL DIMENSIONS

Rev. 17

Receptacle Assembly :

ITEMS	SPECIFICATION
RATING VOLTAGE	250V AC (PER A CONTACT)
RATING AMPERAGE (FOR CONTACT)	0.5A AC/DC (PER A CONTACT)
OPERATING TEMPERATURE	208~358K(-65°C~+85°C)
OPERATING HUMIDITY	85% MAX.(NON-CONDENSING)
CONTACT RESISTANCE (FOR CONTACT)	INITIAL : 70mohm MAX. / AFTER TEST : \leq 25mohm MAX.
INSULATION RESISTANCE	INITIAL : 10,000Mohm MIN. / AFTER TEST : 1,000Mohm MIN.
DIELECTRIC WITHSTANDING VOLTAGE	AC500V 1min
DURABILITY	5,000 CYCLES
MATING FORCE (INITIAL)	0.9N/pos. MAX.
UNMATING FORCE (AFTER TEST)	0.059N/pos. MIN.
COPLANARITY	-
PRODUCT SPECIFICATION	PRS-1011
TEST REPORT	TR-9020
PACKING STANDARD	300-071
INSTRUCTION MANUAL	-
APPEARANCE CRITERIA No.	QLS-A***

Rev. 17

Receptacle Assembly :

Recommended P/N	30047-160T-01F		
PART No.	NO.OF POS.	NOTES	GUIDE PIN P/N
30047-160T-F	160P	WITH SCREW	TAPER TOP
30047-160T-01F		WITHOUT SCREW	
30047-160T-02F		WITH SCREW	SPHERE TOP
30047-160T-03F		WITHOUT SCREW	
30047-160T-04F		WITH SCREW	2'nd SPHERE TOP
30047-160T-05F		WITHOUT SCREW	

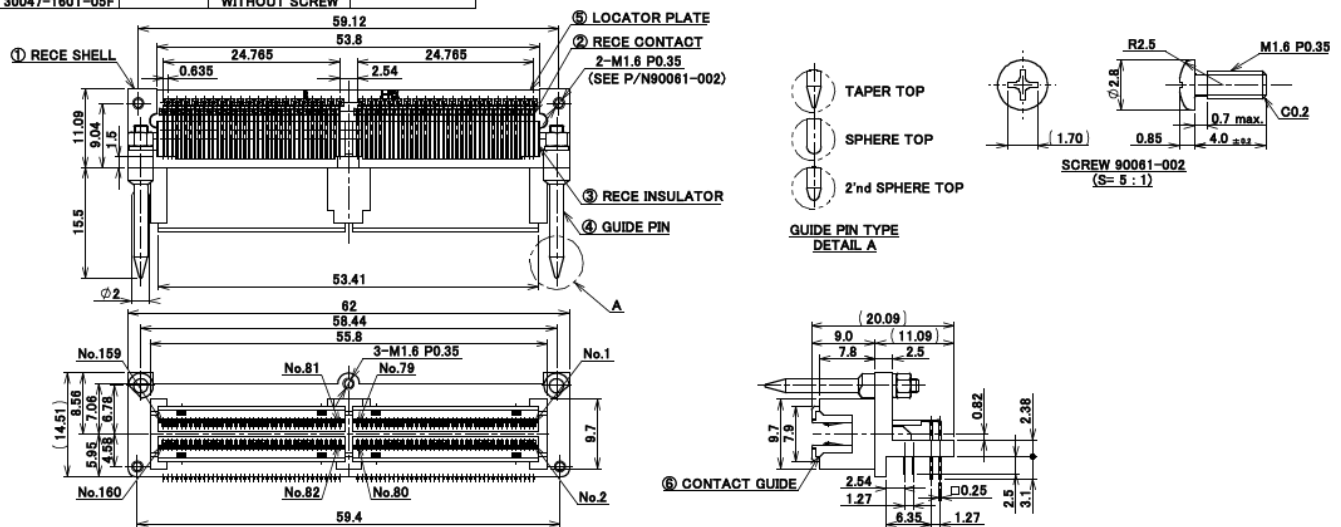

NO.	DISRIPTION	MATERIAL	FINISH , REMARKS
6	CONTACT GUIDE	PPS	BLACK UL94V-0
5	LOCATOR PLATE	PA	BLACK UL94V-0
4	GUIDE PIN	STEEL	Ni PLATING
3	RECE INSULATOR	PPS	BLACK UL94V-0
2	RECE CONTACT	COPPER ALLOY	Au PLATING
1	RECE SHELL	Zn ALLOY	Ni PLATING

NOTE
1. CONNECTOR TO BE MATED: 30046

Rev. 10

Receptacle Assembly :

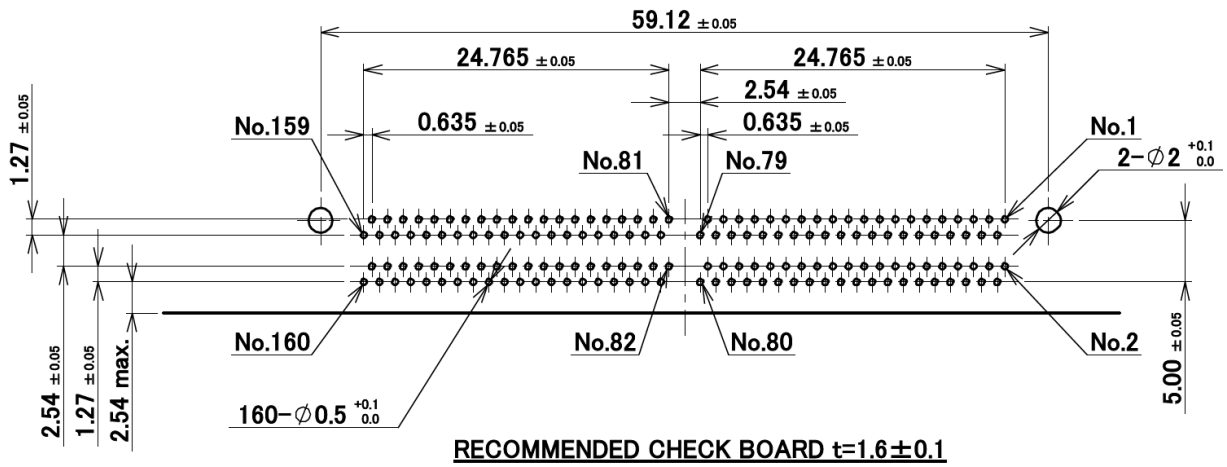

Rev. 10

Receptacle Assembly :

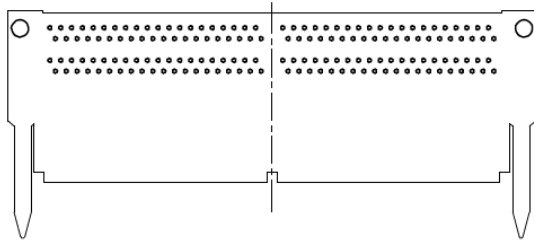

CONNECTOR ON RECOMMENDED FOOTPRINT PATTERN

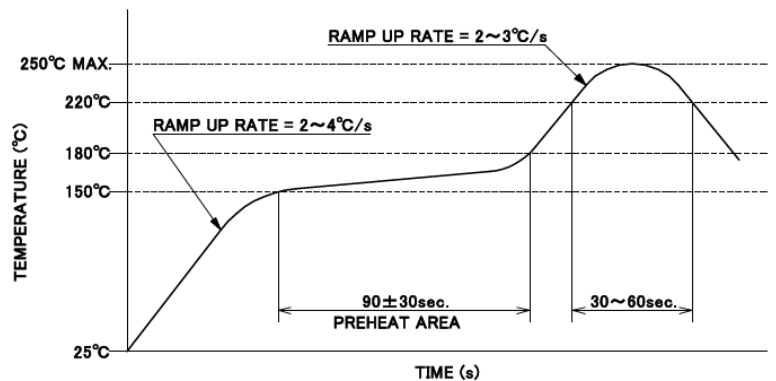

REFLOW TEMPERATURE PROFILE
SENJU METAL INDUSTRY CO., LTD. : M705-SHF(Sn96.5 Ag3.0 Cu0.5)

Rev. 10

Receptacle Assembly :

ITEMS	SPECIFICATION
RATING VOLTAGE	250V AC (PER A CONTACT)
RATING AMPERAGE (FOR CONTACT)	0.5A AC/DC (PER A CONTACT)
OPERATING TEMPERATURE	208~358K(-65°C~+85°C)
OPERATING HUMIDITY	85% MAX.(NON-CONDENSING)
CONTACT RESISTANCE (FOR CONTACT)	INITIAL : 70mohm MAX. / AFTER TEST : \leq 25mohm MAX.
INSULATION RESISTANCE	INITIAL : 10,000Mohm MIN. / AFTER TEST : 1,000Mohm MIN.
DIELECTRIC WITHSTANDING VOLTAGE	AC500V 1min
DURABILITY	5,000 CYCLES
MATING FORCE (INITIAL)	0.9N/pos. MAX.
UNMATING FORCE (AFTER TEST)	0.059N/pos. MIN.
COPLANARITY	-
PRODUCT SPECIFICATION	PRS-1011
TEST REPORT	TR-9020
PACKING STANDARD	300-107
INSTRUCTION MANUAL	-

Rev. 10

Receptacle Assembly :

Recommended P/N 30056-160T-F

PART NO.	LEAD DIMENSION X	NOTES
30056-160T-F	3.3	WITH SCREW
30056-160T-01F		WITHOUT SCREW

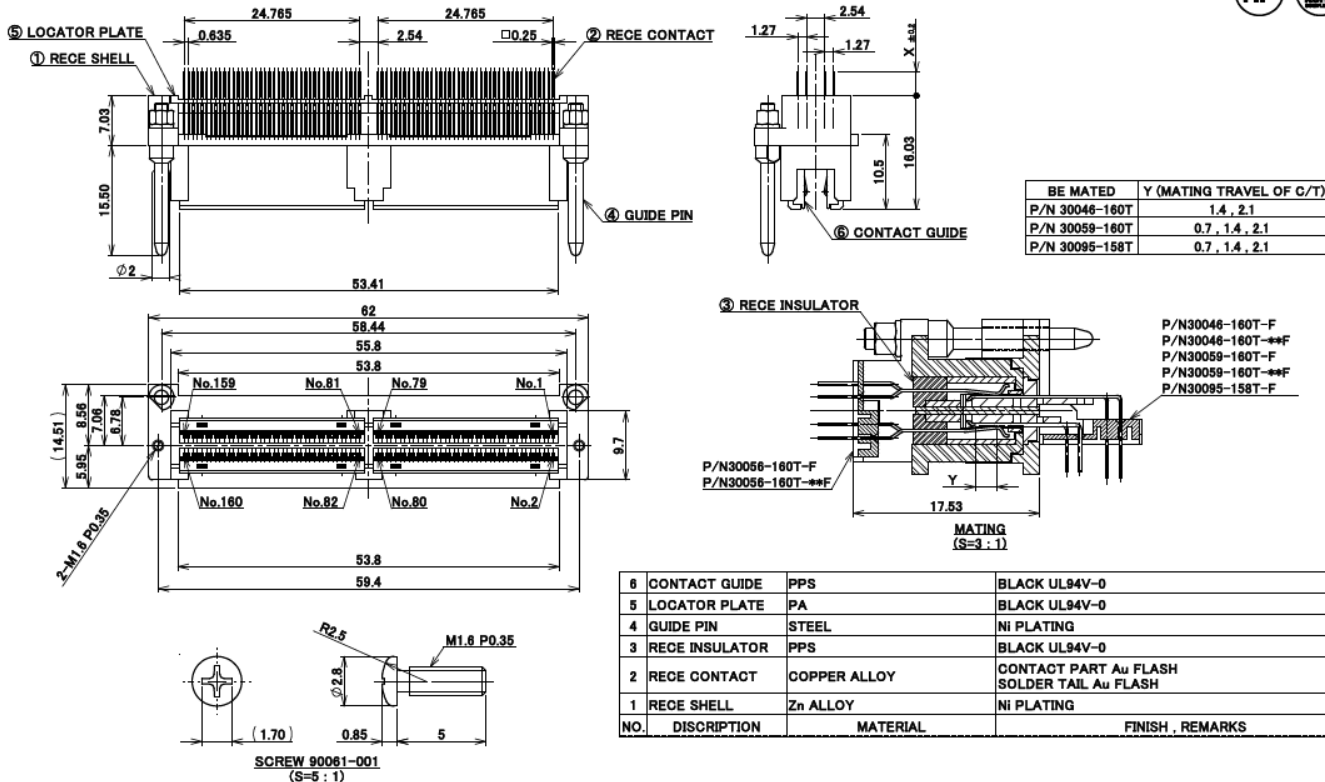

- NOTES
- CONNECTOR TO BE MATED: 30046, 30059, 30095
 - ALLOWANCE DIMENSION OF GUIDE PIN : 0.8 mm

Rev. 11

Receptacle Assembly :

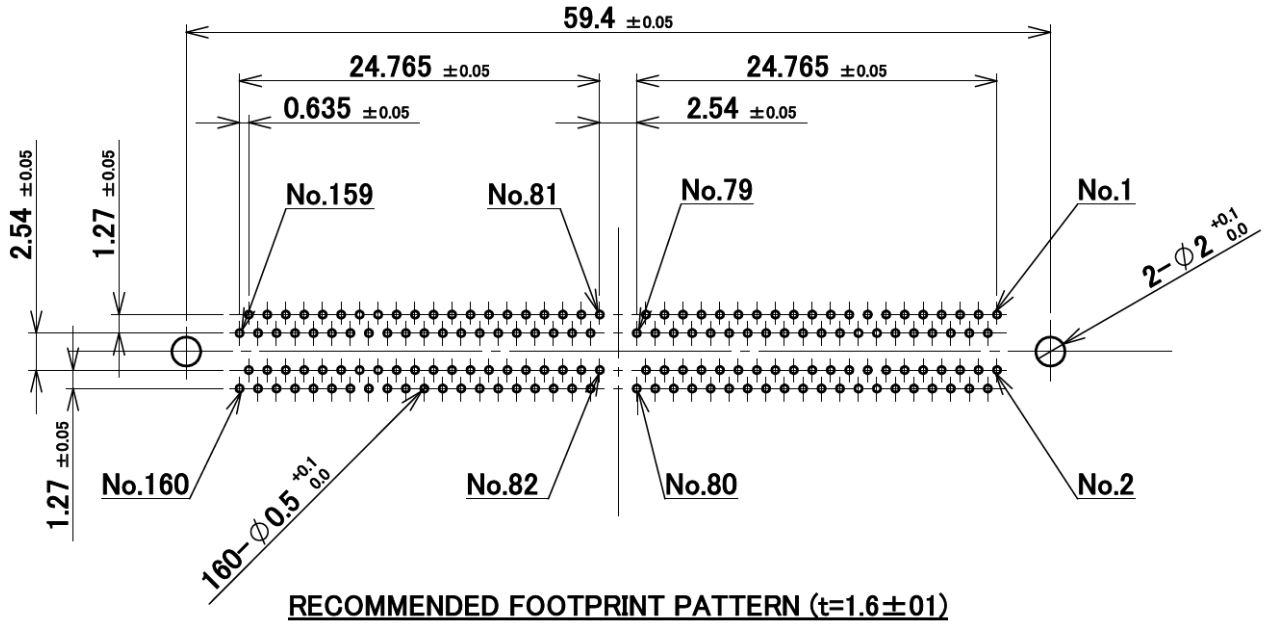

Rev. 11

Receptacle Assembly :

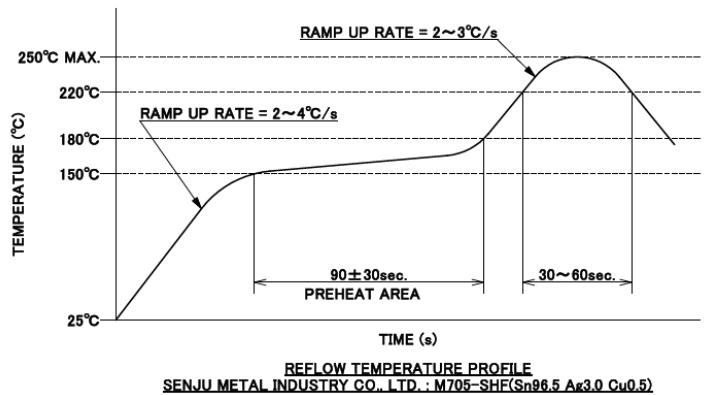
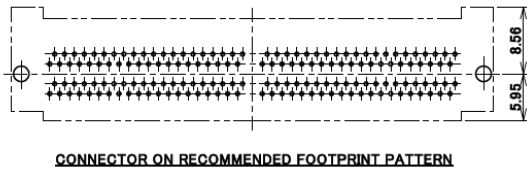

Rev. 11

Receptacle Assembly :

ITEMS	SPECIFICATION
RATING VOLTAGE	250V AC (PER A CONTACT)
RATING AMPERAGE (FOR CONTACT)	0.5A AC/DC (PER A CONTACT)
OPERATING TEMPERATURE	208~358K(-65°C~+85°C)
OPERATING HUMIDITY	85% MAX.(NON-CONDENSING)
CONTACT RESISTANCE (FOR CONTACT)	INITIAL : 70mohm MAX. / AFTER TEST : \leq 25mohm MAX.
INSULATION RESISTANCE	INITIAL : 10,000Mohm MIN. / AFTER TEST : 1,000Mohm MIN.
DIELECTRIC WITHSTANDING VOLTAGE	AC500V 1min
DURABILITY	5,000 CYCLES
MATING FORCE (INITIAL)	0.9N/pos. MAX.
UNMATING FORCE (AFTER TEST)	0.059N/pos. MIN.
COPLANARITY	-
PRODUCT SPECIFICATION	PRS-1011
TEST REPORT	TR-9020
PACKING STANDARD	300-151
INSTRUCTION MANUAL	-

Rev. 11



© I-PEX Inc. 2021. All rights reserved.

I-PEX, MHF, CABLINE, NOVASTACK, EVAFLEX, MINIFLEX, ISH, IARPB, IASLP, ESTORQ, ISFIT, i-Fit and ZenShield are registered trademarks of I-PEX Inc. Please note that the contents in the catalog might be changed without prior notification. I-PEX Inc. assumes no responsibility for any inaccuracies or obligation to update Information on these documents. Please be sure to read and understand the latest "Precautions for Use" and "Instruction Manual" before you use our products. We shall not be responsible for any defects, damages or troubles in case you use our products without following the precautions for use. Please feel free to contact our sales representatives when you use our products for any applications that require very high reliability and safety, or that relate to human life (ex. nuclear power control, aerospace, transportation, medical equipment, safety equipment etc.).

Contact your sales representative for more detailed information. [www.i-pex.com]