

- ✓ Operator friendly auto-locking design, ideal for hand or robotic assembly
- ✓ Vertical mate type using the same FFC option as EVAFLEX® 5-SE-VT
- ✓ Scalable EVAFLEX® family : Auto-lock connector with many other options available

Pin counts:

Range	Up to 60
Available	10, 15, 22, 30, 40, 45, 50, 60

*Please inquire for pin counts not listed or outside of the pin count range.

Part number	20526
Board pitch (mm)	0.5
Height (mm)	2.4 +/- 0.3
Width formula (mm)	13.1+(0.5*?P)
Depth(mm)	5.9
Wiping length(mm)	1.45
FFC/FPC insertion depth (mm)	3.8
FFC/FPC type	Non-shielded FFC/FPC
FFC/FPC thickness(mm)	0.3 +/- 0.05
Contact point	Top
Compatibility (Footprint pattern)	Original
Current rating	0.5A/pin (7.5A/conn)
Supportable standard(Reference only)	LVDS
Operating condition	233 to 398 (-40°C to +125°C) 85%RH max.

Operator friendly auto-locking design, ideal for hand or robotic assembly

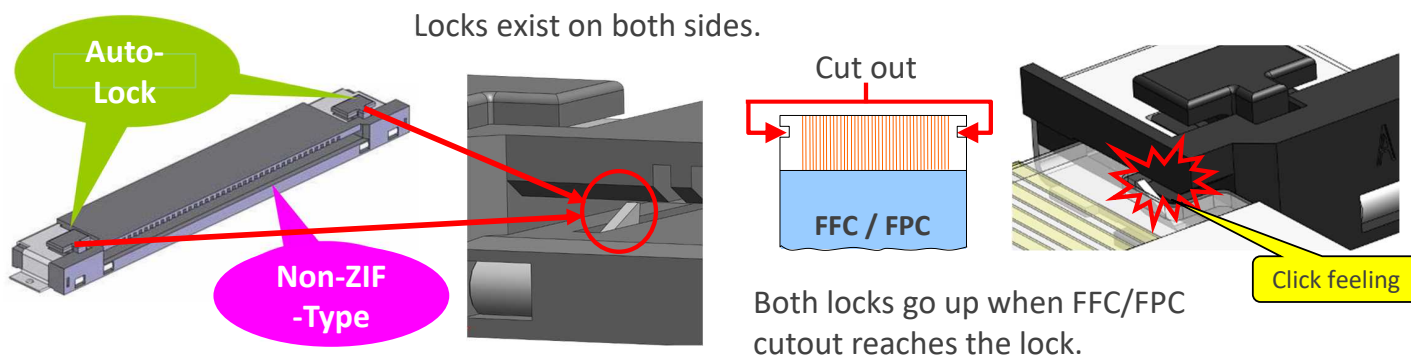

Vertical mate type using the same FFC option as EVAFLEX® 5-SE-VT

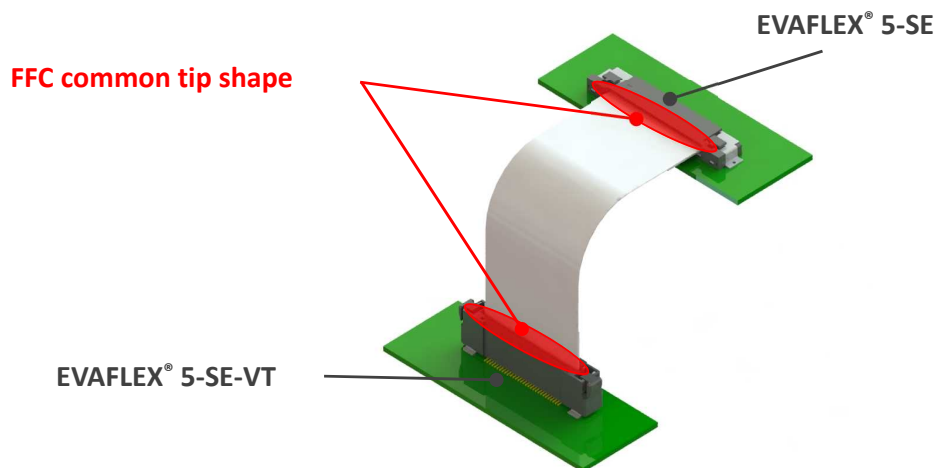

Scalable EVAFLEX® family : Auto-lock connector with many other options available

Higher speed and durable to high temp (125°C) : EVAFLEX® 5-SE-G HT

	EVAFLEX® 5-SE-G HT
Height (mm)	6.60 +/- 01
Operation Temperature	up to 125°C
Reference Performance	V-by-one HS 1.4 (4+ Gbps)

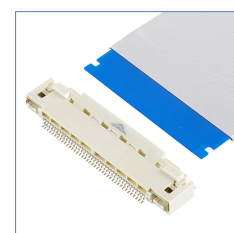

EVAFLEX[®] 5-SE

Component Parts Detail

Connector Assembly :

Recommended P/N	20526-0**E-01					
PART NO.	Pos	A	B	C	D	E
20526-010E-01	10	18.10	10.90	4.50	16.40	8.56
20526-015E-01	15	20.60	13.40	7.00	18.90	11.06
20526-022E-01	22	24.10	16.90	10.50	22.40	14.56
20526-030E-01	30	28.10	20.90	14.50	26.40	18.56
20526-040E-01	40	33.10	25.90	19.50	31.40	23.56
20526-045E-01	45	35.60	28.40	22.00	33.90	26.06
20526-050E-01	50	38.10	30.90	24.50	36.40	28.56
◆20526-055E-01	55	40.60	33.40	27.00	38.90	31.06
20526-060E-01	60	43.10	35.90	29.50	41.40	33.56

◆MARK MEANS NOT AVAILABLE

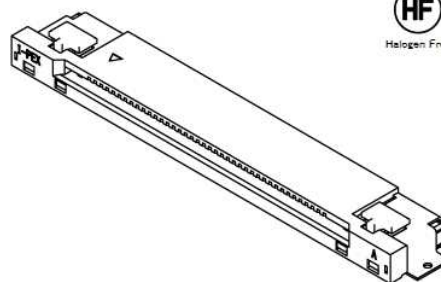
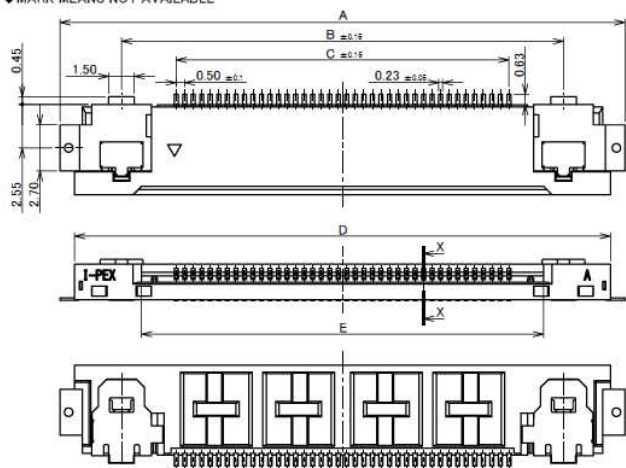

3	HOLD DOWN	PHOSPHOR BRONZE	SOLDERING AREA : Sn 2.00 μm MIN. OVER Ni 1.00 μm MIN.
2	CONTACT	PHOSPHOR BRONZE	CONTACT AREA : Au 0.10 μm MIN. OVER Ni 1.00 μm MIN. SOLDERING AREA : Au 0.03 μm MIN. OVER Ni 1.00 μm MIN.
1	HOUSING	LCP	UL94V-0 BLACK
NO.	DISCRPTION	MATERIAL	FINISH , REMARKS

Connector Assembly :

Recommended P/N		20526-0**E-01	
PART NO.	Pos.	C	F
20526-010E-01	10	4.50	8.50
20526-015E-01	15	7.00	11.00
20526-022E-01	22	10.50	14.50
20526-030E-01	30	14.50	18.50
20526-040E-01	40	19.50	23.50
20526-045E-01	45	22.00	26.00
20526-050E-01	50	24.50	28.50
◆20526-055E-01	55	27.00	31.00
20526-060E-01	60	29.50	33.50

◆MARK MEANS NOT AVAILABLE

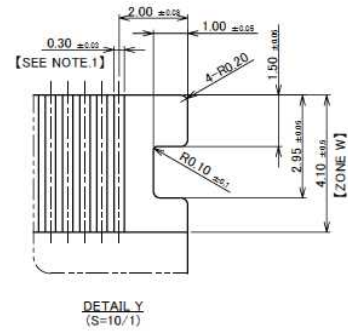
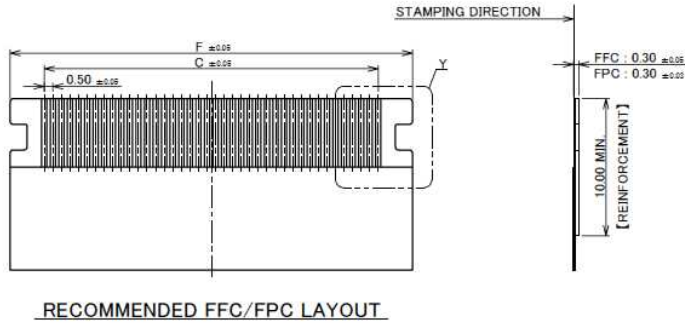

NOTES.
1. CONTROL DIMENSION OF [ZONE W] WITH IN 0.30±0.03

Rev.11

Connector Assembly :

Recommended P/N		20526-0**E-01			
PART NO.	Pos.	B	C	G	H
20526-010E-01	10	10.90	4.50	5.50	17.00
20526-015E-01	15	13.40	7.00	8.00	19.50
20526-022E-01	22	16.90	10.50	11.50	23.00
20526-030E-01	30	20.90	14.50	15.50	27.00
20526-040E-01	40	25.90	19.50	20.50	32.00
20526-045E-01	45	28.40	22.00	23.00	34.50
20526-050E-01	50	30.90	24.50	25.50	37.00
◆20526-055E-01	55	33.40	27.00	28.00	39.50
20526-060E-01	60	35.90	29.50	30.50	42.00

◆MARK MEANS NOT AVAILABLE

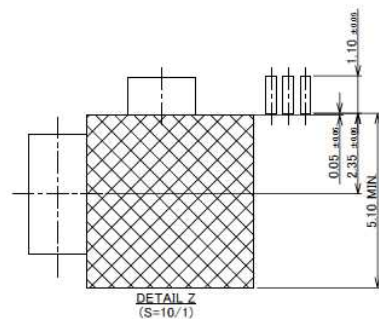
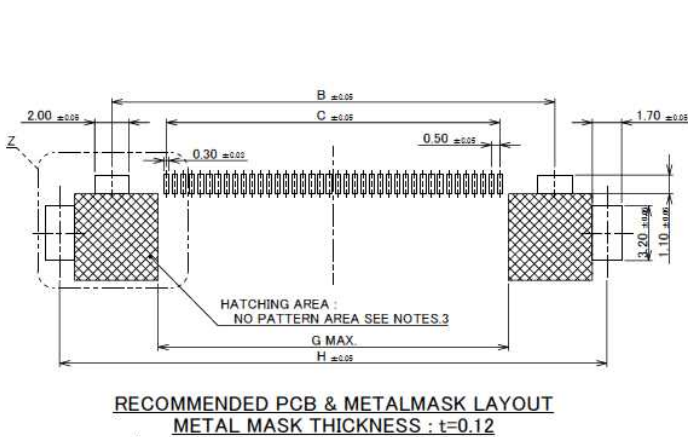

NOTES.
2. HATCHING AREA CANNOT MOUNT ANOTHER COMPONENTS.
3. SOLDER RESIST SHALL BE COATED IN CASE OF RUNNING TRACES ON THIS FOOTPRINT PATTERN PROHIBITION AREA.

Rev.11

Connector Assembly :

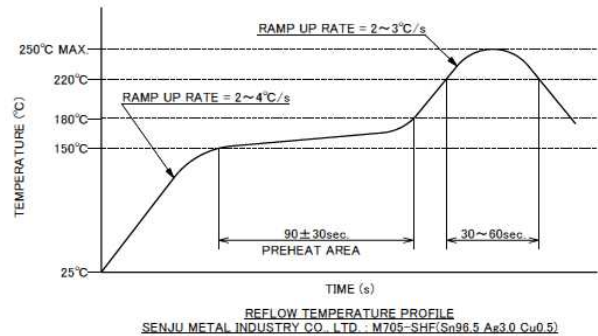

Rev.11

Connector Assembly :

ITEMS	SPECIFICATION
RATING VOLTAGE	50V AC/DC (PER CONTACT)
RATING AMPERAGE (FOR CONTACT)	0.50A AC/DC (PER CONTACT) ※(AVAILABLE UP TO 15PIN) / 0.35A AC/DC(PER CONTACT) ※(AVAILABLE FOR ALL PIN)
OPERATING TEMPERATURE	Using FFC : 233~358K(-40°C~+85°C) Using FPC : 233~398K(-40°C~+125°C)
OPERATING HUMIDITY	85% MAX.(NON-CONDENSING)
CONTACT RESISTANCE	INITIAL : 70mohm MAX. / AFTER TEST : ≦40mohm MAX.
INSULATION RESISTANCE	INITIAL : 500Mohm MIN. / AFTER TEST : 500Mohm MIN.
DIELECTRIC WITHSTANDING VOLTAGE	AC 250V 1min
DURABILITY	30 CYCLES
MATING FORCE (INITIAL / AFTER TEST)	10P : 6.0N MAX. 15P : 9.0N MAX. 22P : 13.2N MAX. 30P : 18.0N MAX. 40P : 24.0N MAX. 45P : 27.0N MAX. 50P : 30.0N MAX. 55P : 33.0N MAX. 60P : 36.0N MAX.
UNMATING FORCE (INITIAL / AFTER TEST)	10P : 0.90N MIN. 15P : 1.35N MIN. 22P : 1.98N MIN. 30P : 2.70N MIN. 40P : 3.60N MIN. 45P : 4.05N MIN. 50P : 4.50N MIN. 55P : 4.95N MIN. 60P : 5.40N MIN.
COPLANARITY	0.10mm MAX.
PRODUCT SPECIFICATION	PRS-1562
TEST REPORT	TR-10048
PACKING STANDARD	300-861
INSTRUCTION MANUAL	HIM-10008
APPEARANCE CRITERIA No.	QLS-A***

Rev.11



© I-PEX Inc. 2021. All rights reserved.

I-PEX, MHF, CABLINE, NOVASTACK, EVAFLEX, MINIFLEX, ISH, IARPB, IASLP, ESTORQ, ISFIT, i-Fit and ZenShield are registered trademarks of I-PEX Inc. Please note that the contents in the catalog might be changed without prior notification. I-PEX Inc. assumes no responsibility for any inaccuracies or obligation to update Information on these documents. Please be sure to read and understand the latest "Precautions for Use" and "Instruction Manual" before you use our products. We shall not be responsible for any defects, damages or troubles in case you use our products without following the precautions for use. Please feel free to contact our sales representatives when you use our products for any applications that require very high reliability and safety, or that relate to human life (ex. nuclear power control, aerospace, transportation, medical equipment, safety equipment etc.).

Contact your sales representative for more detailed information. [www.i-pex.com]