

# CABLINE®-CAF

Mechanical lock with shielding and multi-point ground, suitable for high-data-rate transfer (32 Gbps/lane), 0.4 mm pitch, Horizontal mating type FPC plug connector

## Product Specifications:

Mating type	Horizontal	
Board Pitch (mm)	0.4	
Wiping Length (mm)	0.48	
Mated size (mm)	Height	1.10 Max
	Width	Formula: $5.75 + (0.4 \times ? p)$
	Depth	6.06
Pin Counts	Range	Up to 60
	Available	40, 60

## Applicable FPC

FPC Type	Shielded/Non-shielded FPC
FPC Pitch (mm)	0.4
FPC Contact Point	Top
FPC Thickness (mm)	Contact Area: $0.26 \pm 0.02$
	Ground Area: $0.40 \pm 0.05$

## Applicable Standards (Reference Only):

32 Gbps/ Lane, USB4 Gen4 (40 Gbps/ Lane PAM3)  
Display Port UHBR20 (20 Gbps/Lane)

\* Please inquire for pin counts not listed or outside of the pin count range.



## ► Mechanical locking bar prevents incomplete mating and back-out/unmating

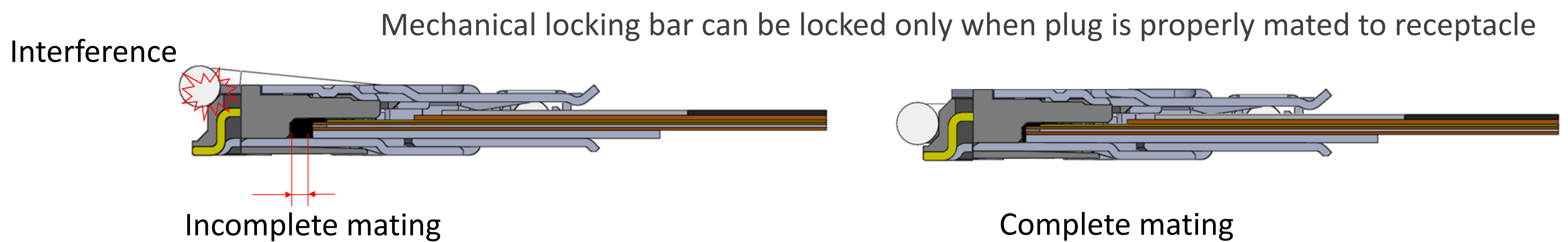
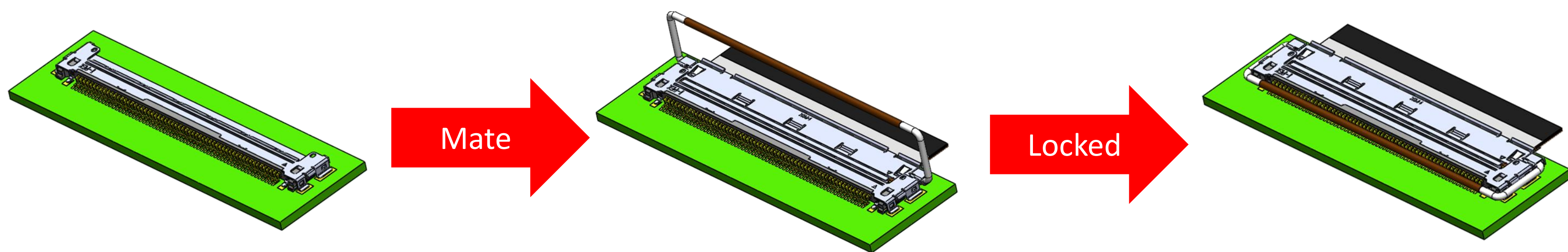

## ► EMI shielding and multi-point ground design

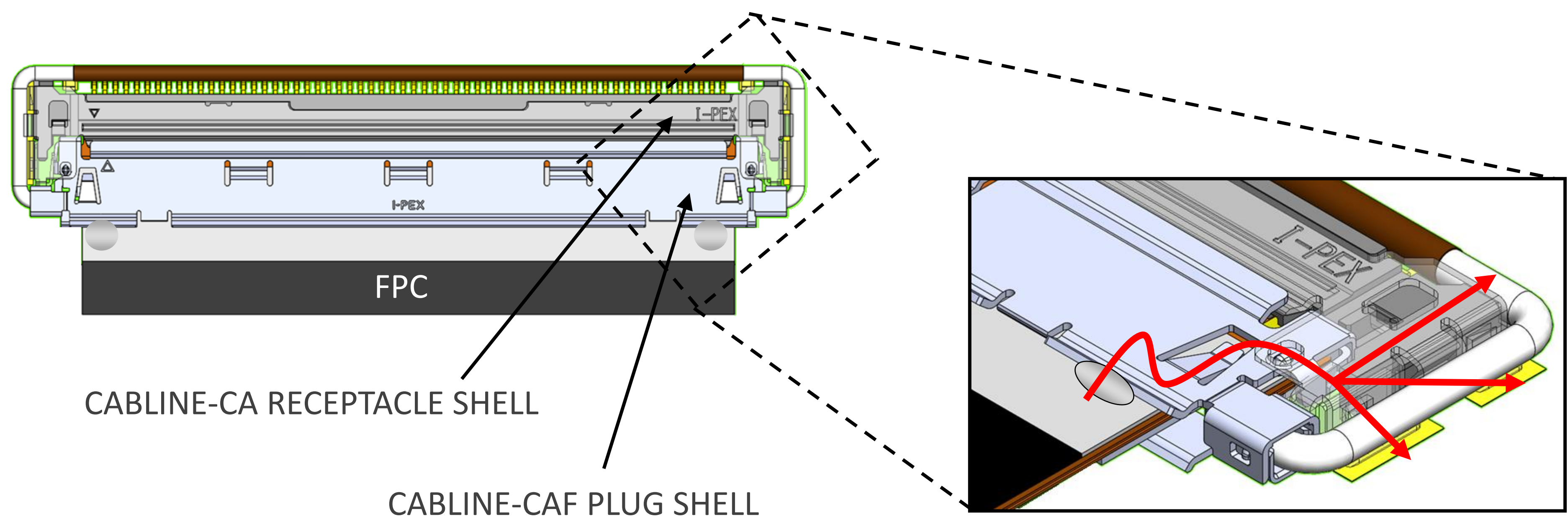

## ► High-data-rate transfer, ideal for 32 Gbps/lane applications

### Measurement results

Connector: CABLINE-CAF 40P

FPC: Shielded FPC,  
Differential 100 ohm, Length : 100 mm

Pin Assignment: GSSGSSG

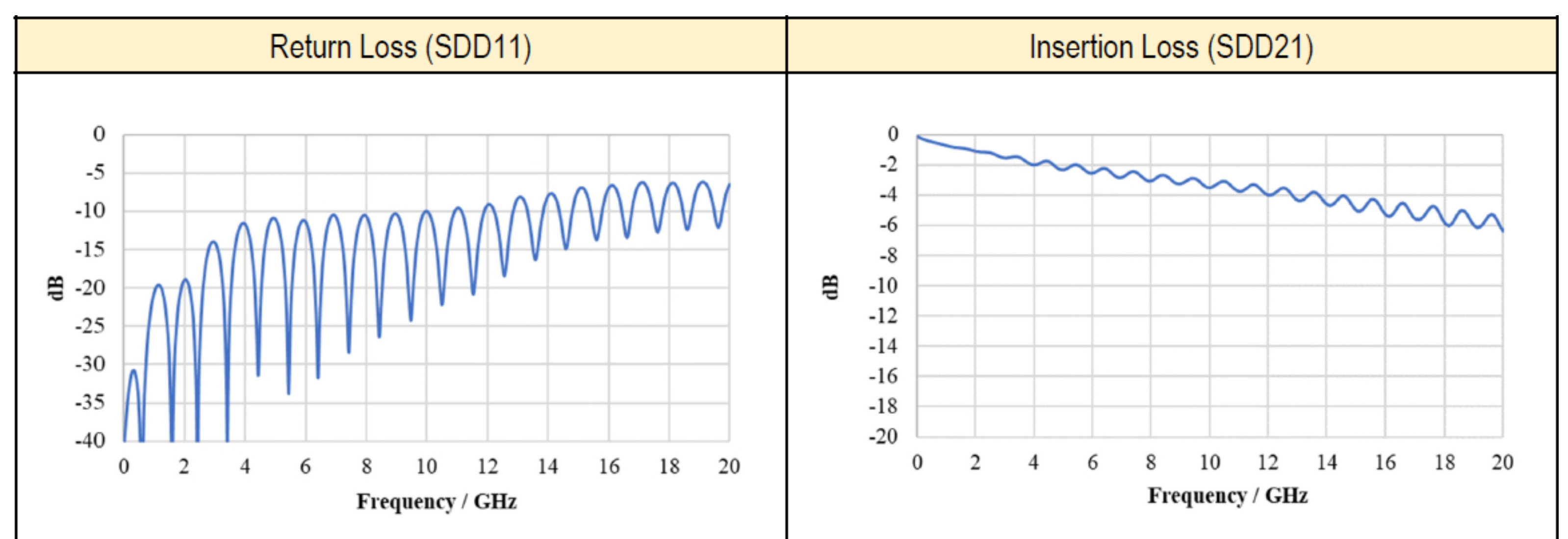



# Component Parts Details

## Component Parts

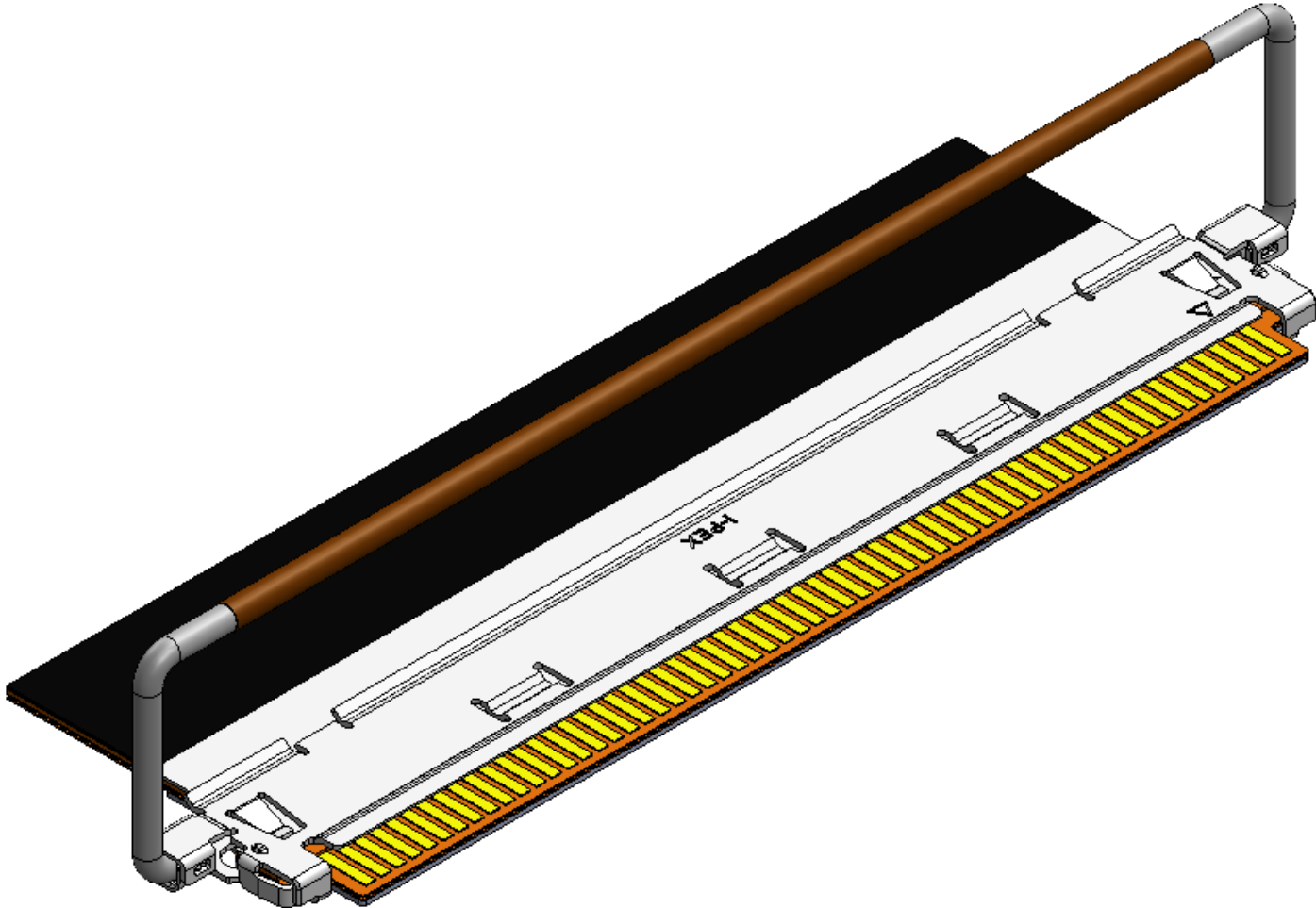
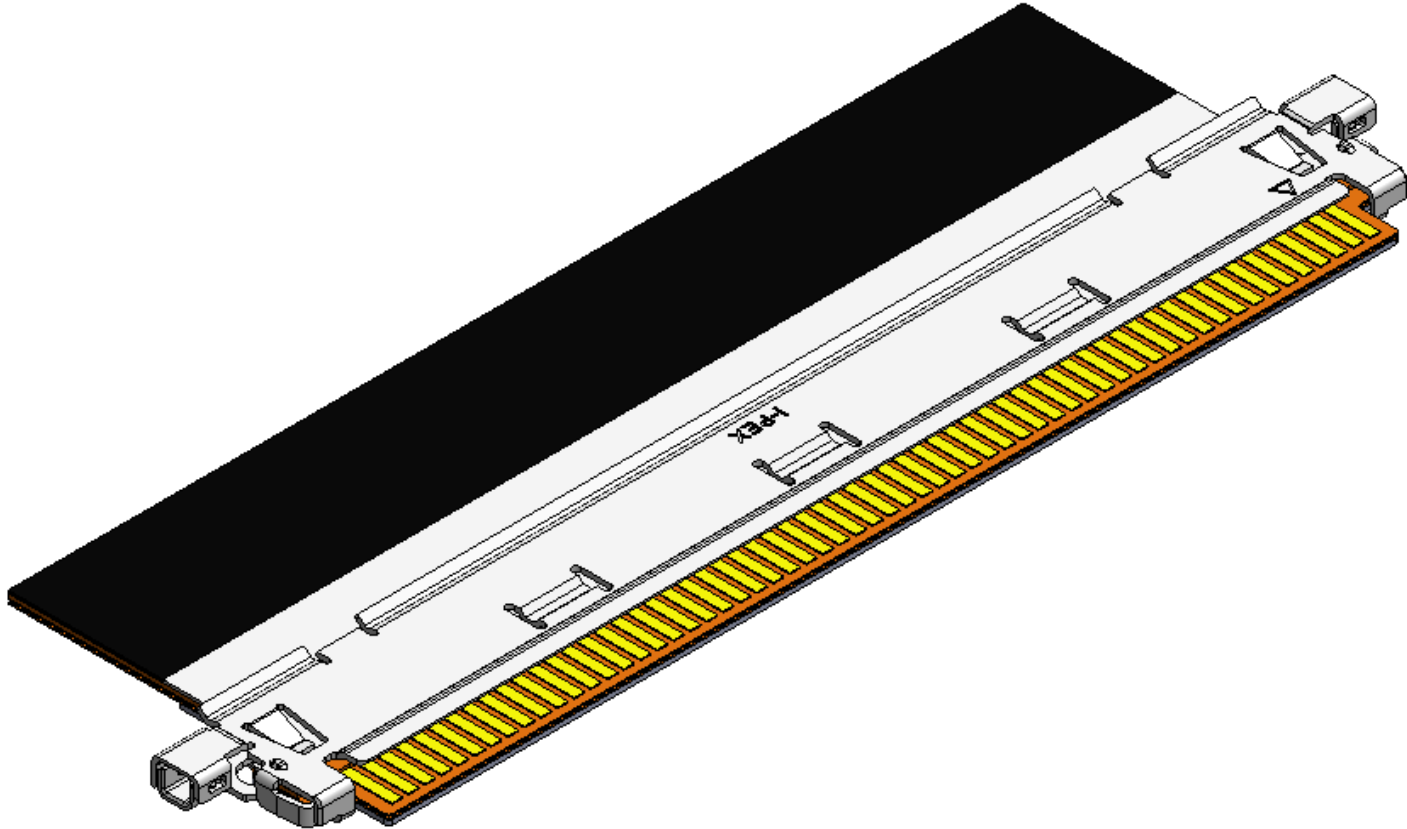
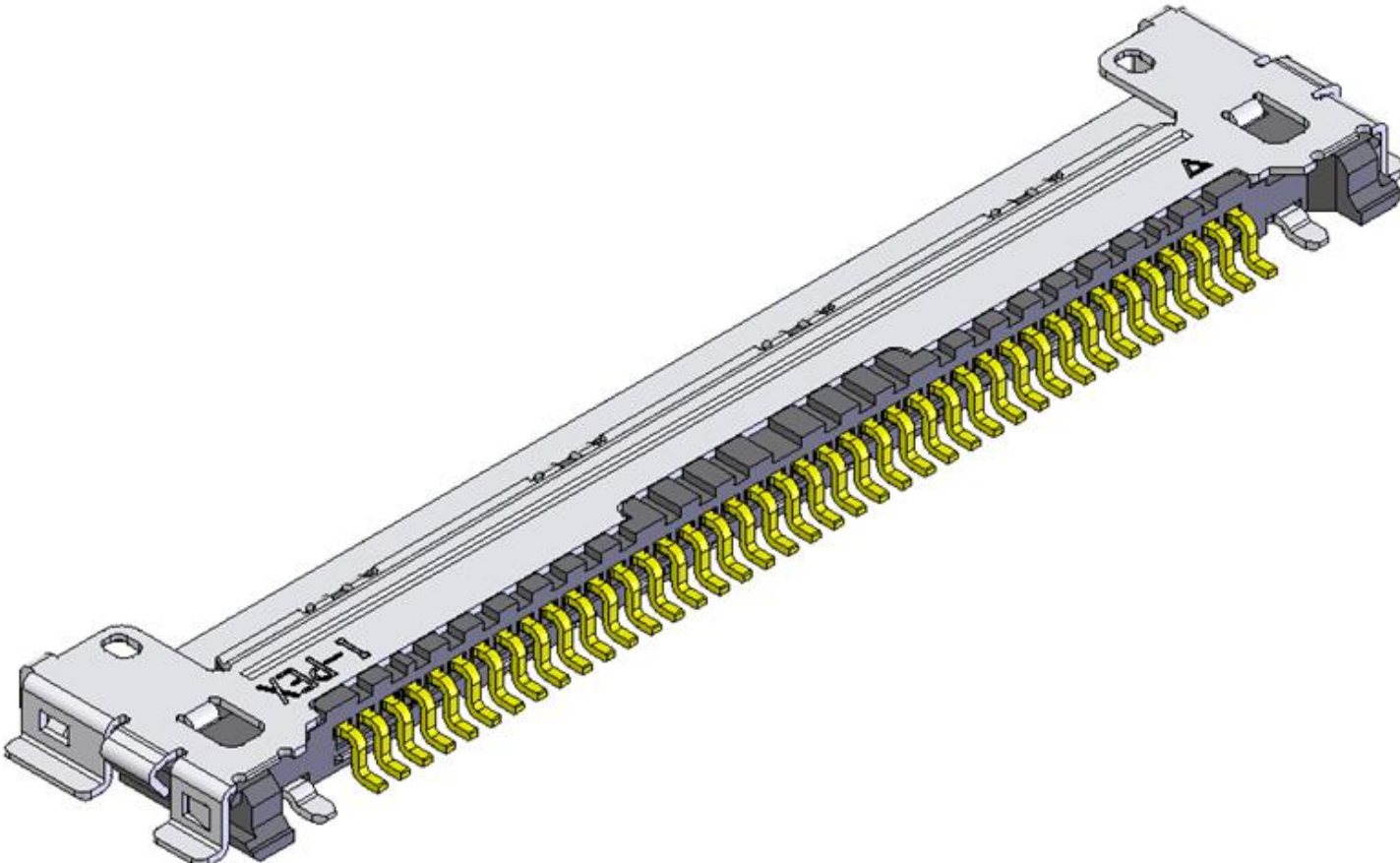
WITH LOCK BAR TYPE	OR	WITHOUT LOCK BAR TYPE
		
		
CABLINE-CA RECEPTACLE		

Shell Assembly

Recommended P/N		20858-0**T-01			
PART NO.	Pos.	A	B	C	
20858-040T-01	40	20.65	18.66	20.40	
20858-060T-01	60	28.65	26.66	28.40	

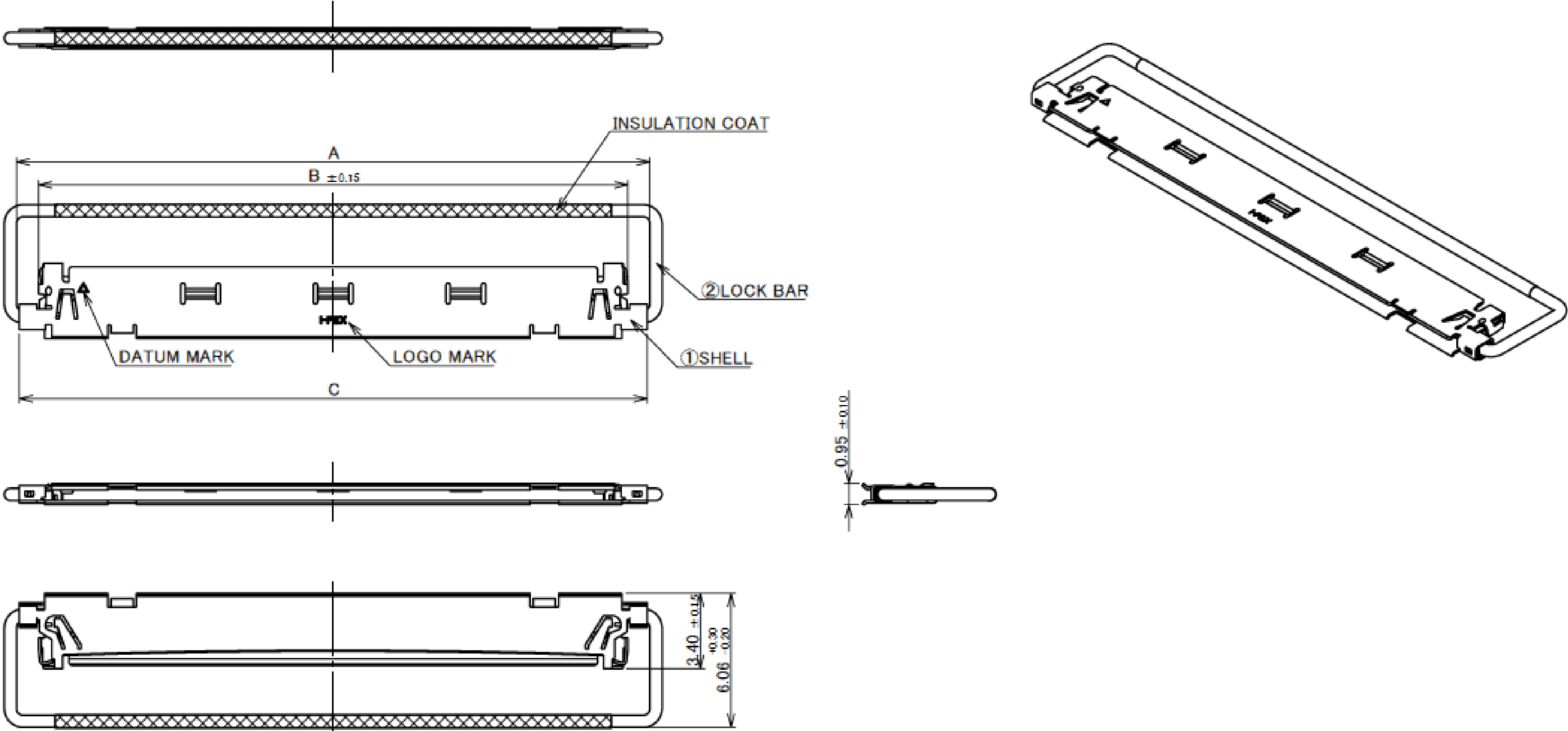
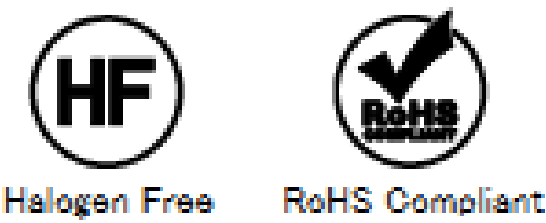

2	LOCK BAR	SUS	-
1	SHELL	PHOSPHOR BRONZE	PARTIAL Au 0.003 μm MIN. OVER Ni 1.00 μm MIN.
NO.	DISCRIPTION	MATERIAL	FINISH , REMARKS

Rev.9

PART NO.	Pos.	B	C	D	E	F
20858-040T-01	40	18.66	20.40	21.75	16.40	15.60
20858-060T-01	60	26.66	28.40	29.75	24.40	23.60

FPC ASSEMBLY STATE

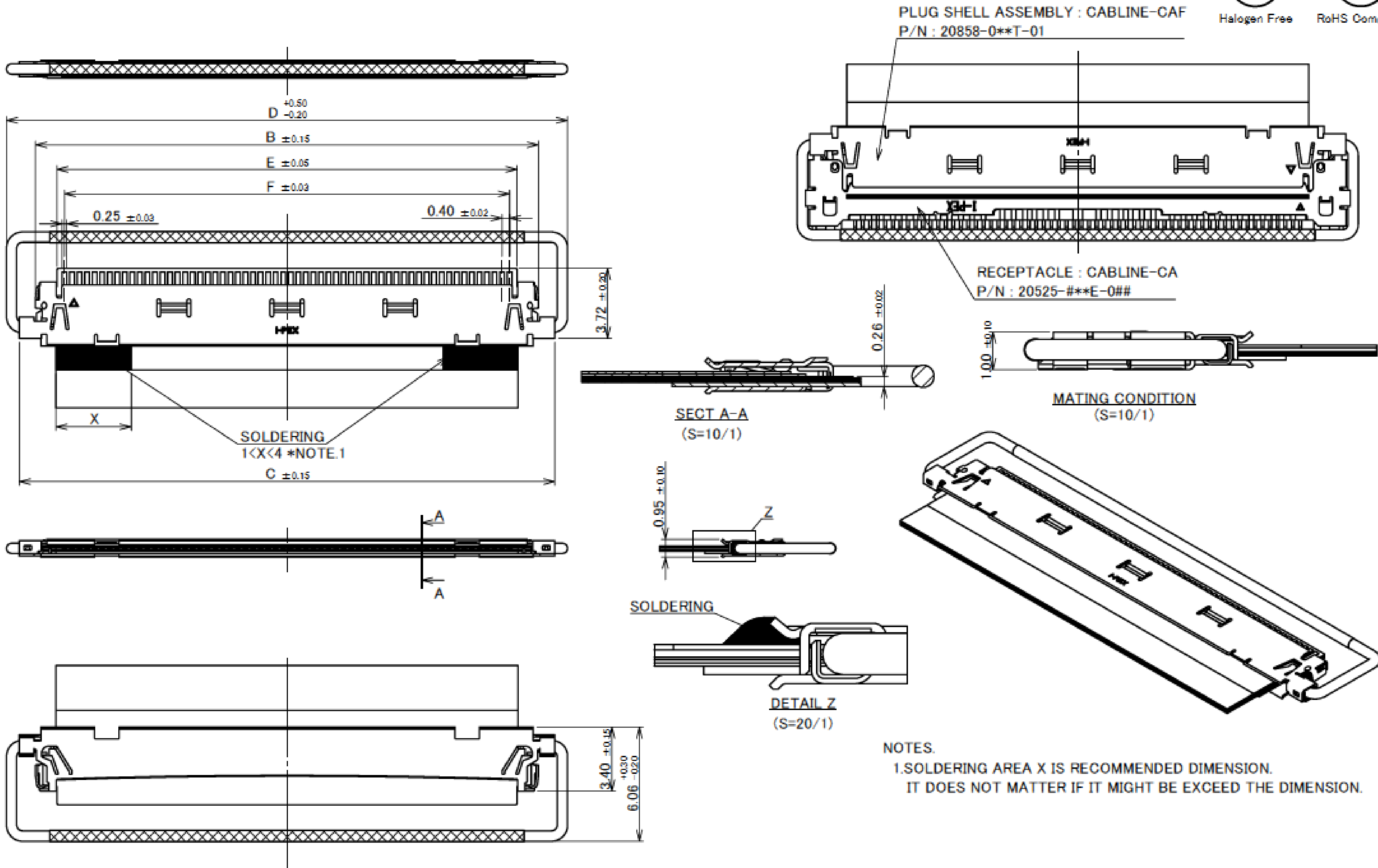
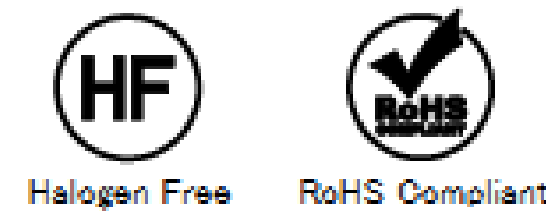

NOTES.  
1.SOLDERING AREA X IS RECOMMENDED DIMENSION.  
IT DOES NOT MATTER IF IT MIGHT BE EXCEED THE DIMENSION.

Rev.9

Shell Assembly

PART NO.	Pos.	E	F	G	H
20858-040T-01	40	16.40	15.60	17.90	16.50
20858-060T-01	60	24.40	23.60	25.90	24.50

RECOMMENDED FPC LAYOUT  
【SHIELDED FPC】

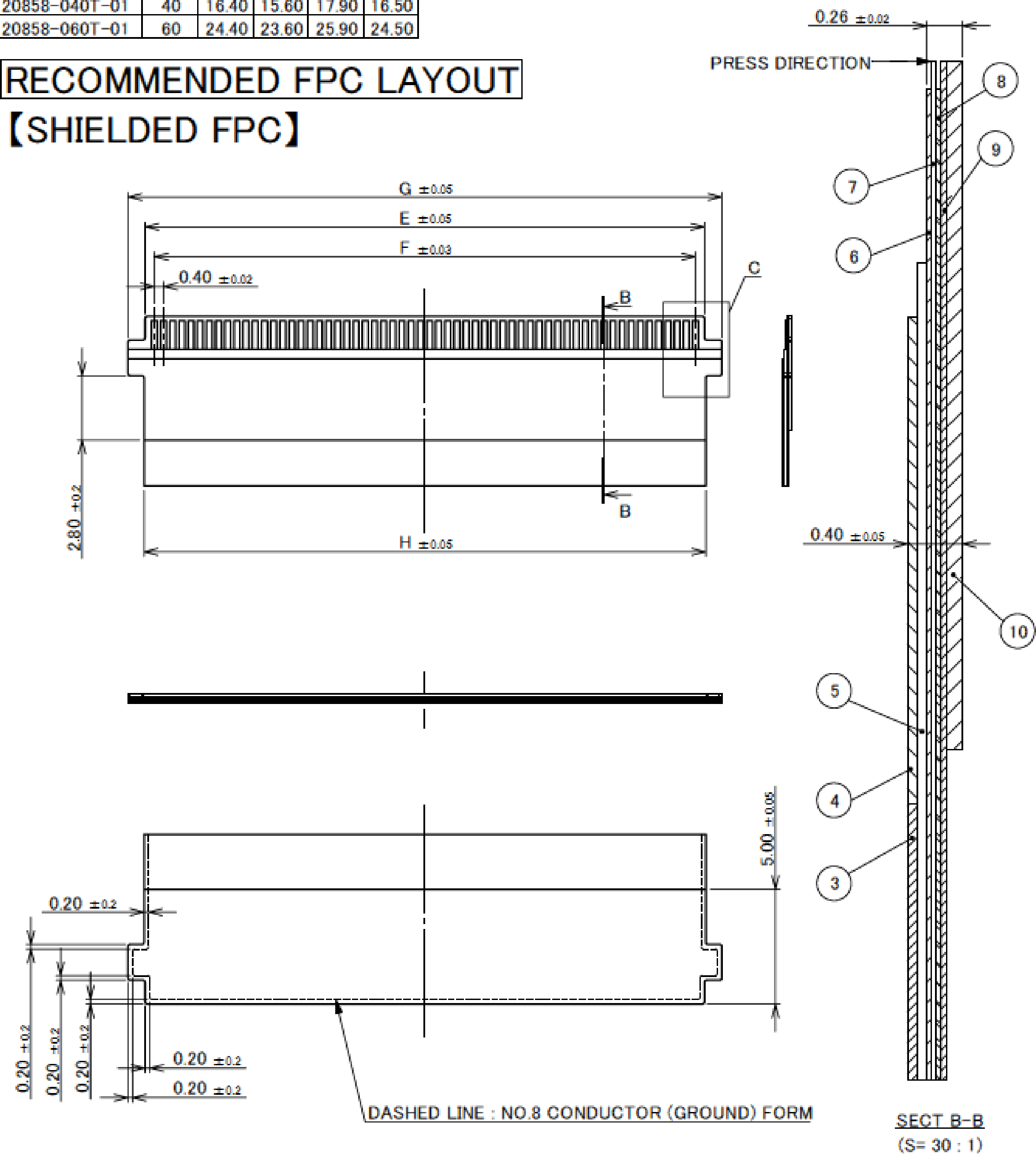

- NOTES.
- 1. ADHESIVE SHOULD USE THERMOSETTING.
  - 2. NO.3 : SHIELD FILM AND NO.4, NO.8 : CONDUCTOR (GROUND) ARE CARRYING OUT THE ELECTRICAL CONNECTION.
  - 3. NO.4 : CONDUCTOR (GROUND) AND NO.8 : CONDUCTOR (GROUND) ARE CARRYING OUT THE ELECTRICAL CONNECTION.
  - 4. NO.3 : SHIELD FILM AND NO.6 : CONDUCTOR (SIGNAL) ARE NOT CONTACTING.
  - 5. NO.4, NO.8 : CONDUCTOR (GROUND) AND NO.6 : CONDUCTOR (SIGNAL) ARE NOT CONTACTING.

3	SHIELD FILM	-	-
4	CONDUCTOR (GROUND)	Cu	Ni, Au
5	INSULATOR	-	-
6	CONDUCTOR (SIGNAL)	Cu	Ni, Au
7	INSULATOR	-	-
8	CONDUCTOR (GROUND)	Cu	Ni
9	INSULATOR	-	-
10	REINFORCING TAPE	-	-
No.	DESCRIPTION	MATERIAL	PLATING

Rev.9

PART NO.	Pos.	E	F	G	H
20858-040T-01	40	16.40	15.60	17.90	16.50
20858-060T-01	60	24.40	23.60	25.90	24.50

RECOMMENDED FPC LAYOUT  
【NON SHIELDED FPC】

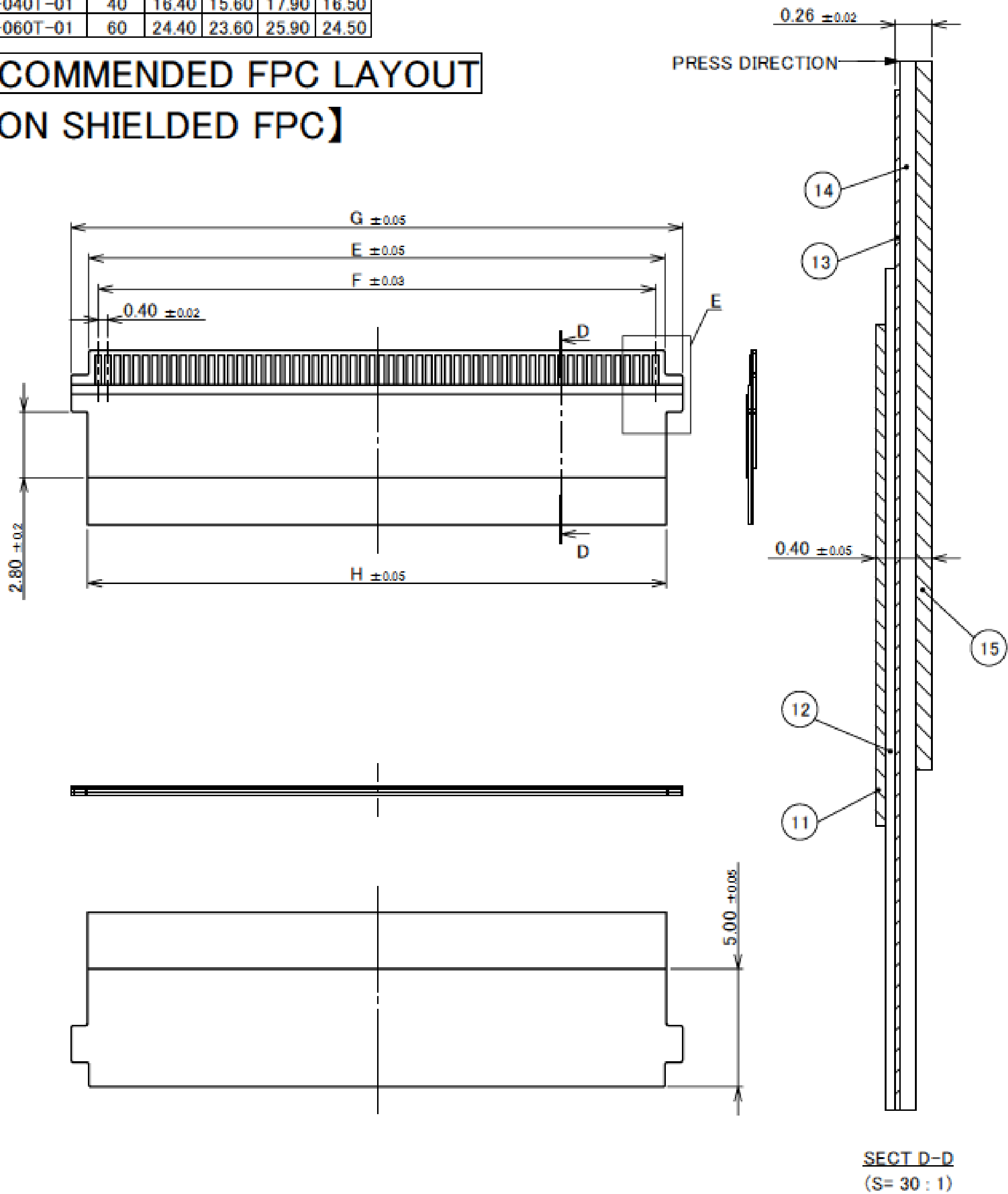

- NOTES.
- 1. ADHESIVE SHOULD USE THERMOSETTING.
  - 2. NO.11 : CONDUCTOR (GROUND) AND NO.1 : SHELL ARE CARRYING OUT THE ELECTRICAL CONNECTION BY SOLDERING.
  - 3. NO.11 : CONDUCTOR (GROUND) AND NO.13 : CONDUCTOR (SIGNAL) ARE NOT CONTACTING.

11	CONDUCTOR (GROUND)	Cu	Ni, Au
12	INSULATOR	-	-
13	CONDUCTOR (SIGNAL)	Cu	Ni, Au
14	INSULATOR	-	-
15	REINFORCING TAPE	-	-
No.	DESCRIPTION	MATERIAL	PLATING

Rev.9

Shell Assembly

ITEMS	SPECIFICATION
RATING VOLTAGE	100V AC (PER CONTACT)
RATING AMPERAGE (FOR SIGNAL CONTACT)	0.5A AC/DC (PER CONTACT) ※AVAILABLE UP TO 14PIN 0.3A AC/DC (PER CONTACT) ※AVAILABLE UP TO ALL PIN
OPERATING TEMPERATURE	233~358K(−40℃~+85℃)
OPERATING HUMIDITY	85% MAX.(NON-CONDENSING)
CONTACT RESISTANCE (FOR SIGNAL CONTACT)	INITIAL : 60mohm MAX. / AFTER TEST : ≦40mohm MAX.
GROUND SHELL RESISTANCE	INITIAL : 60mohm MAX. / AFTER TEST : ≦40mohm MAX.
INSULATION RESISTANCE	INITIAL : 1000Mohm MIN. / AFTER TEST : 500Mohm MIN.
DIELECTRIC WITHSTANDING VOLTAGE	AC250V 1min
DURABILITY	30 CYCLES
MATING FORCE (INITIAL / AFTER TEST)	40P : 11.07N MAX. 60P : 16.61N MAX.
UNMATING FORCE (INITIAL / AFTER TEST)	40P : 1.44N MIN. 60P : 2.16N MIN.
PRODUCT SPECIFICATION	PRS-2465
TEST REPORT	TR-18016
PACKING STANDARD	PST-17138
INSTRUCTION MANUAL	HIM-18016
ASSEMBLY MANUAL	ASM-18005
APPEARANCE CRITERIA No.	QLS-A***

Rev.9

Receptacle Assembly

Recommended P/N		20525-0**E-02(12~60P)					20525-210E-02(10P)				
PART NO.	POS.	A	B	C	D	F					
20525-#10E-02	10	5.40	3.60	8.43	9.20	4.30					
20525-#12E-02	12	6.20	4.40	9.23	10.00	5.10					
20525-#20E-02	20	9.40	7.60	12.43	13.20	8.30					
20525-#30E-02	30	13.40	11.60	16.43	17.20	12.30					
20525-#40E-02	40	17.40	15.60	20.43	21.20	16.30					
20525-#50E-02	50	21.40	19.60	24.43	25.20	20.30					
20525-#60E-02	60	25.40	23.60	28.43	29.20	24.30					

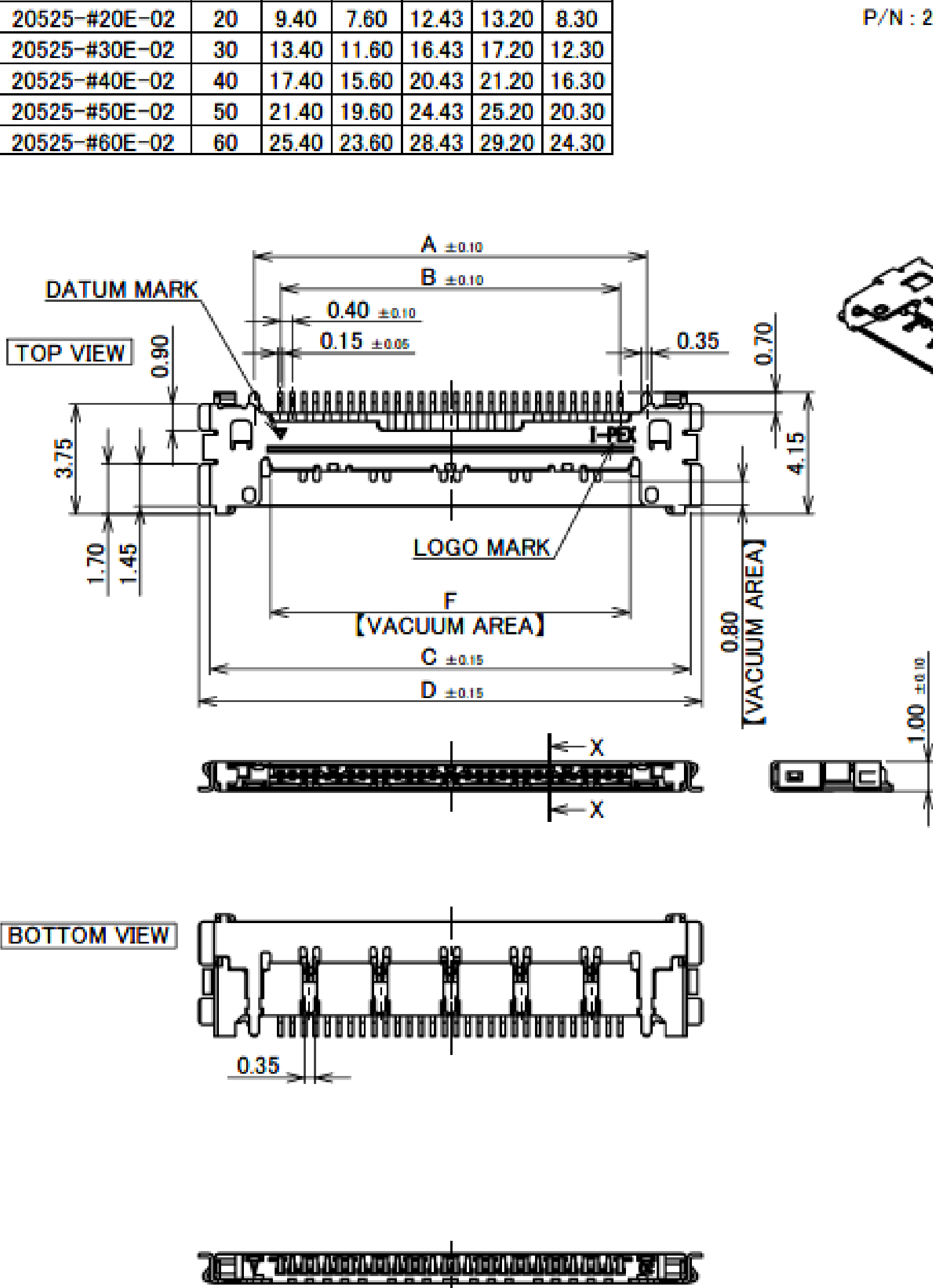

P/N : 20525-#\*\*E-02  
POS. SEE TABLE 1

PATENT REGISTERED



Halogen Free



RoHS Compliant

POS. SEE TABLE 1

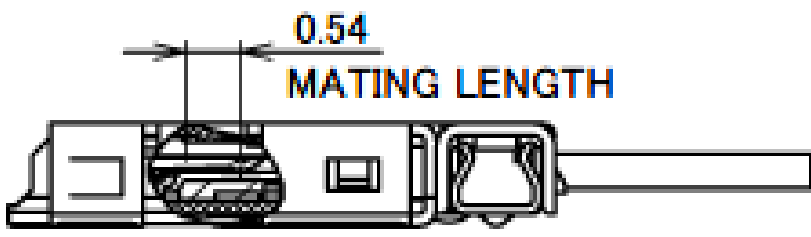

MATING CONDITION

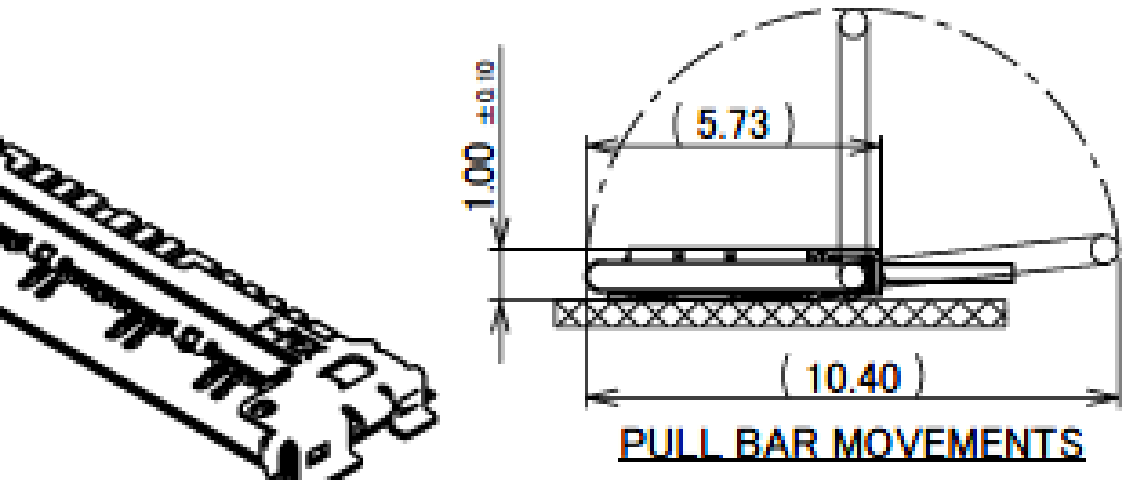

PULL BAR MOVEMENTS

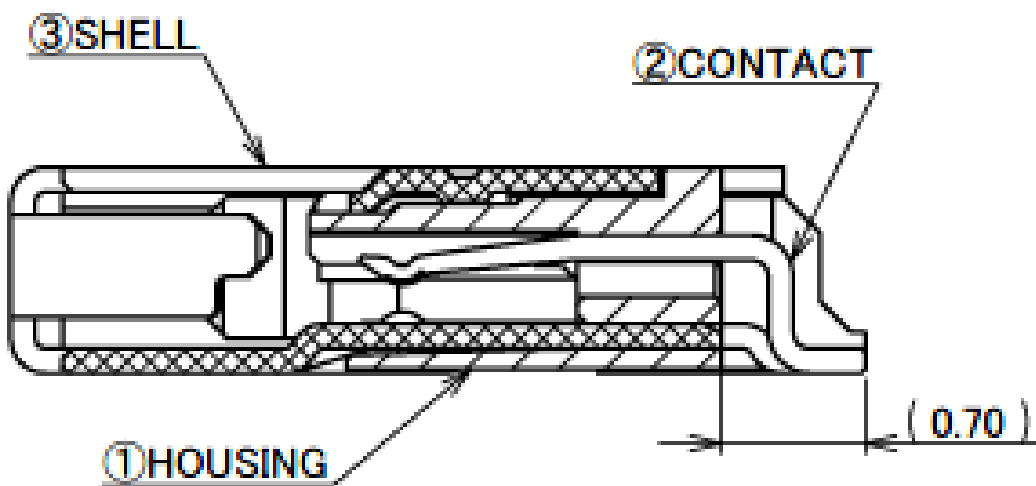

SECT. X-X  
(S=20/1)

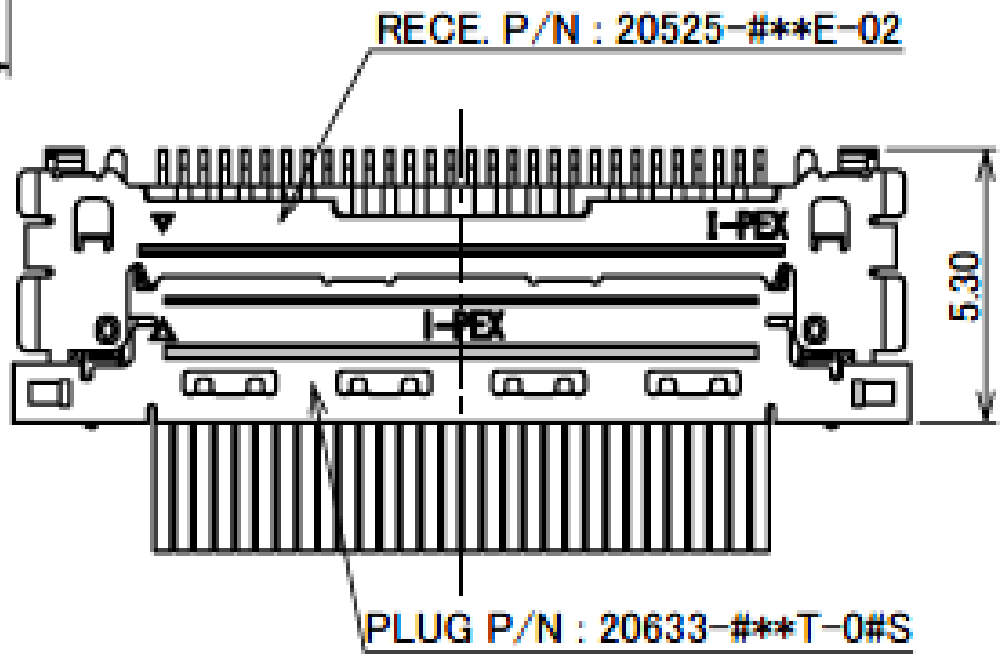

TABLE 1

PART NO.	CONTACT FINISH	SHELL FINISH
20525-0**E-02	CONTACT AREA : Au 0.1 μm MIN. OVER Ni 1.00 μm MIN. SOLDERING AREA : Au 0.03 μm MIN. OVER Ni 1.00 μm MIN.	ALL OVER Au 0.02 μm MIN. OVER Ni 1.00 μm MIN. CONTACT AREA : Au 0.02 μm MIN. OVER Ni 0.80 μm MIN.
20525-2**E-02	CONTACT AREA : Au 0.03 μm MIN. OVER Ni 1.00 μm MIN. SOLDERING AREA : Au 0.03 μm MIN. OVER Ni 1.00 μm MIN.	ALL OVER Ni 1.00 μm MIN. SOLDERING AREA : Au 0.02 μm MIN.

3	SHELL	PHOSPHOR BRONZE	SEE TABLE 1
2	CONTACT	PHOSPHOR BRONZE	SEE TABLE 1
1	HOUSING	LCP	UL94V-0, BLACK
NO.	DISCRIPTION	MATERIAL	FINISH , REMARKS

Rev.33

Receptacle Assembly

PART NO.
20525-***E-02

BOTTOM VIEW

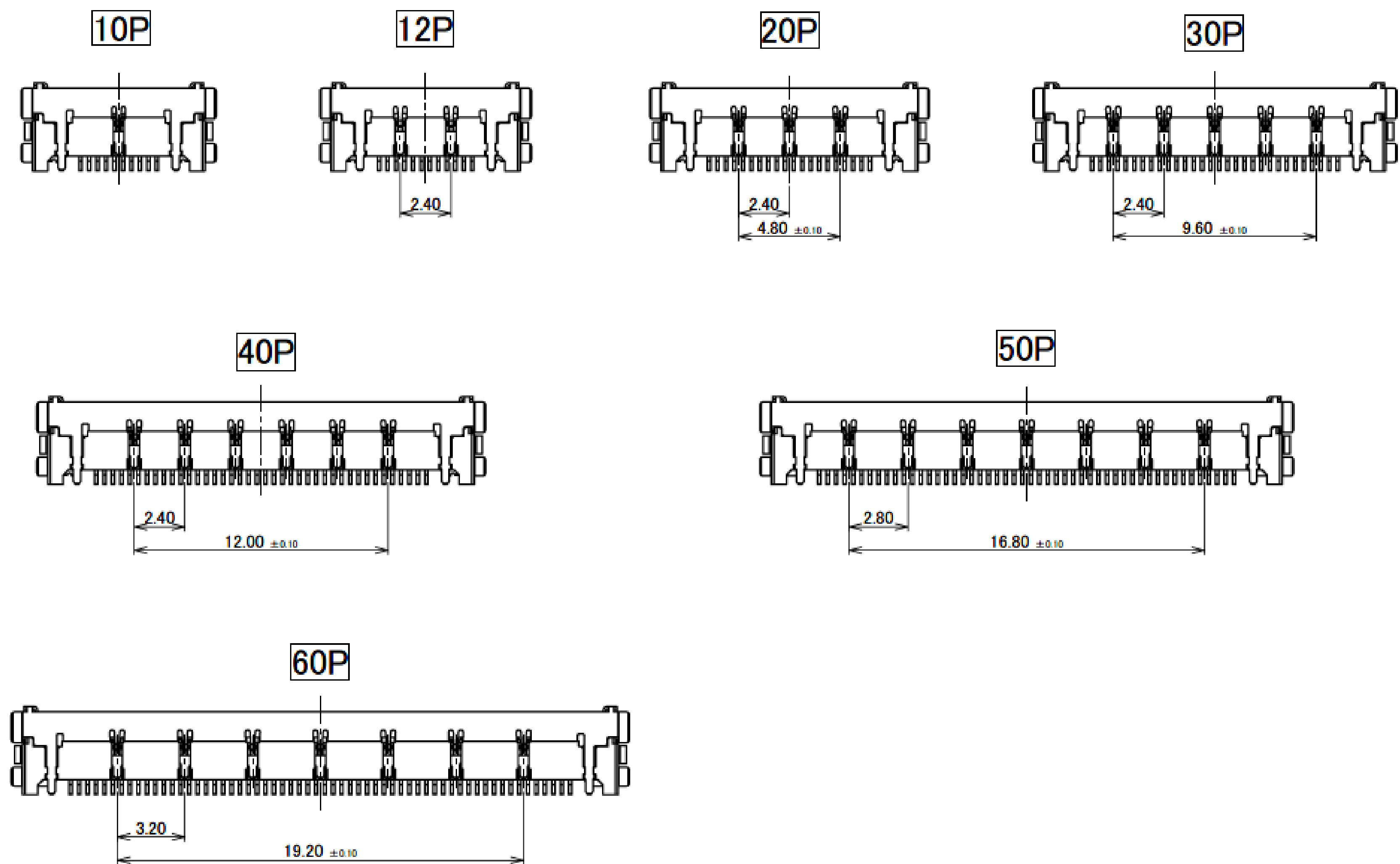

Rev.33

PART NO.	POS.	A	B	E	G	H	J	K
20525-#10E-02	10	5.40	3.60	-	8.18	9.60	11.60	-
20525-#12E-02	12	6.20	4.40	2.40	8.98	10.40	12.40	-
20525-#20E-02	20	9.40	7.60	4.80	12.18	13.60	15.60	2.40
20525-#30E-02	30	13.40	11.60	9.60	16.18	17.60	19.60	2.40
20525-#40E-02	40	17.40	15.60	12.00	20.18	21.60	23.60	2.40
20525-#50E-02	50	21.40	19.60	16.80	24.18	25.60	27.60	2.80
20525-#60E-02	60	25.40	23.60	19.20	28.18	29.60	31.60	3.20

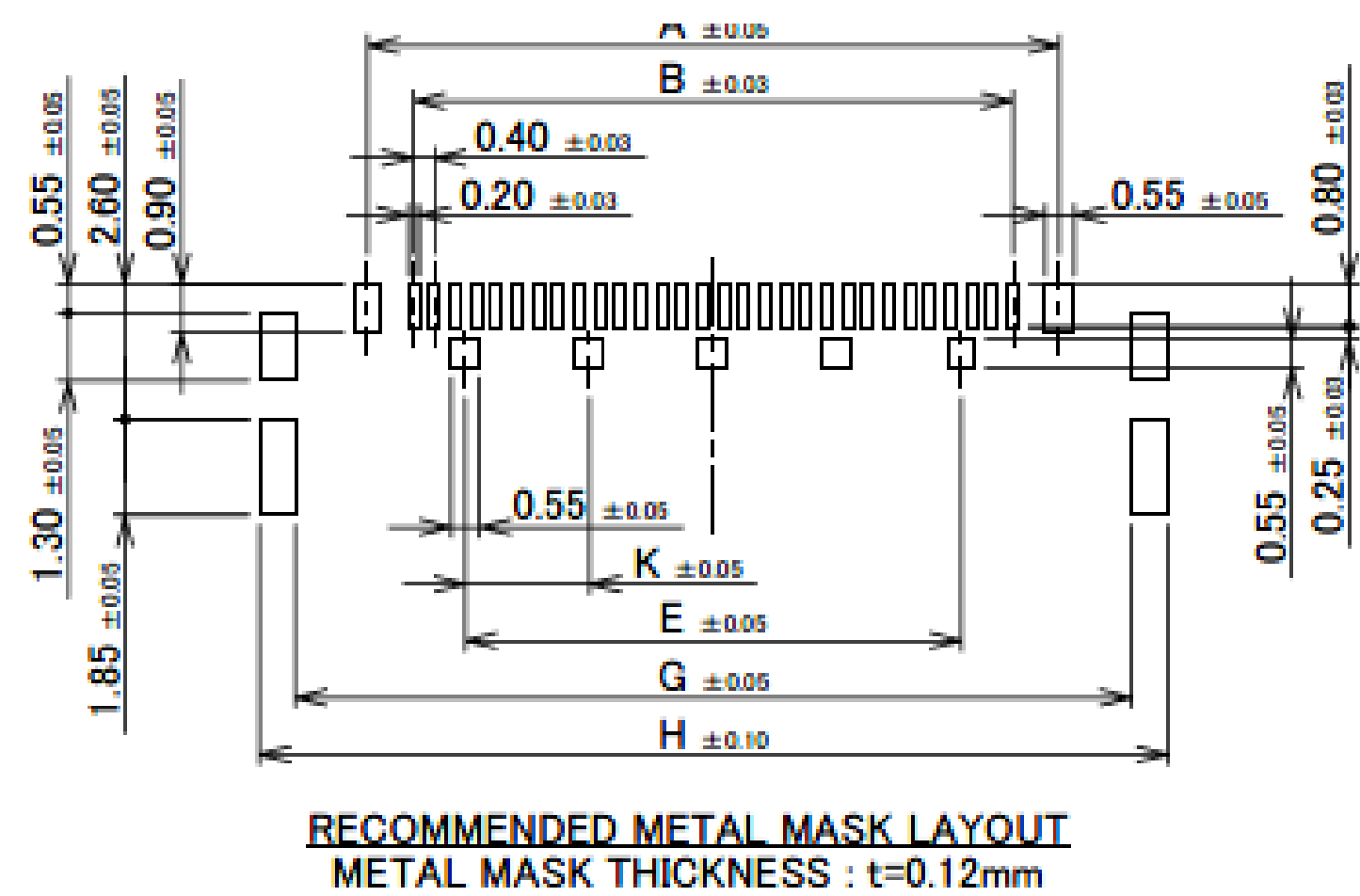
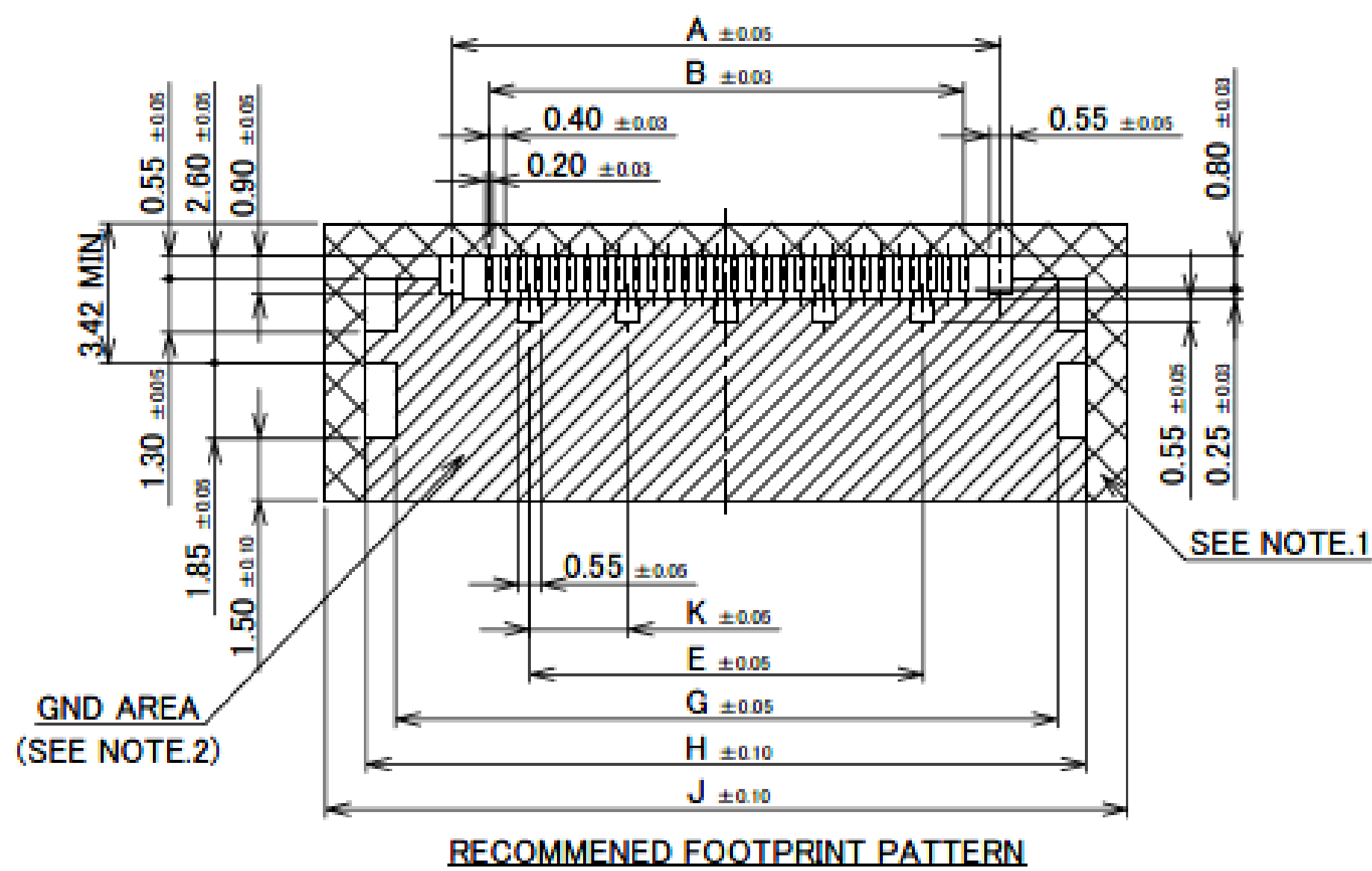

NOTES.  
1. IN CASE OF PLUG WITH PULL BAR(20633-##T-01S), DO NOT MOUNT ANOTHER COMPONENT IN THIS AREA.  
2. SOLDER RESIST MUST BE APPLIED TO THIS AREA.

Rev.33



Receptacle Assembly

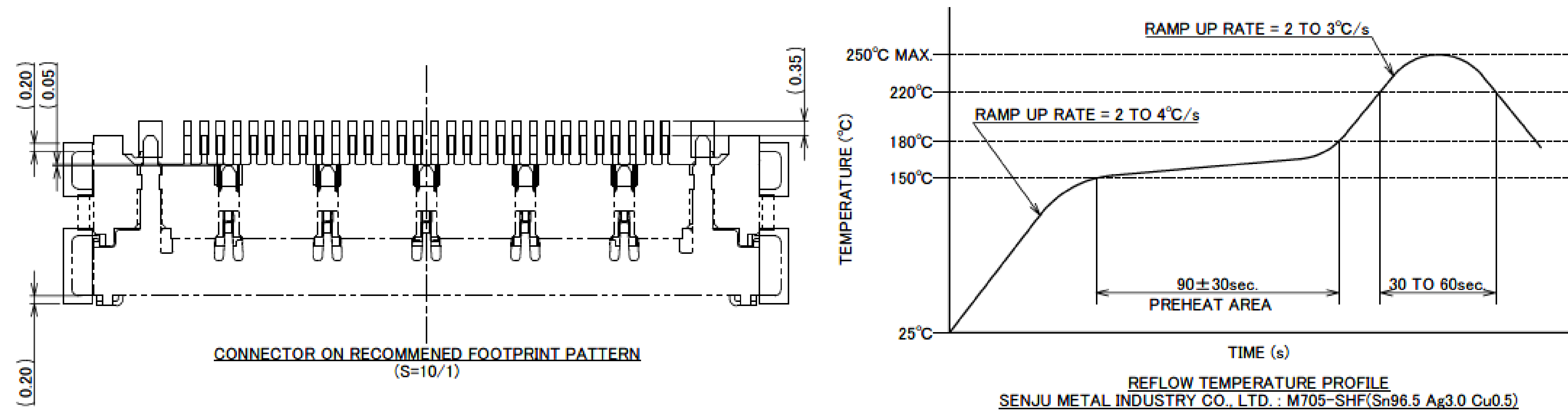

Rev.33

FOR CABLINE-CAF PLUG SHELL ASSEMBLY (DWG NO. 20858)

ITEMS	SPECIFICATION
RATED VOLTAGE	100V AC (PER CONTACT PIN)
RATED AMPERAGE (FOR CONTACT)	0.5A AC/DC (PER CONTACT PIN) ※AVAILABLE UP TO 14PIN 0.3A AC/DC (PER CONTACT PIN) ※AVAILABLE FOR ALL PIN ※TESTING BY A REAL MACHINE IS RECOMMENDED BECAUSE TEMPERATURE RISE MAY AFFECTED BY ACTUAL SITUATION.
OPERATING TEMPERATURE	233 TO 358K (−40°C TO +85°C)
OPERATING HUMIDITY	85% MAX.
CONTACT RESISTANCE (FOR SIGNAL CONTACT)	INITIAL : 60mohm MAX. / AFTER TEST : ∇40mohm MAX.
GROUND SHELL RESISTANCE	INITIAL : 60mohm MAX. / AFTER TEST : ∇40mohm MAX.
INSULATION RESISTANCE	INITIAL : 1000Mohm MIN. / AFTER TEST : 500Mohm MIN.
DIELECTRIC WITHSTANDING VOLTAGE	AC250V 1min
DURABILITY	30 CYCLES
MATING FORCE (INITIAL / AFTER TEST)	40P : 11.07N MAX. 40P : 16.61N MAX.
UNMATING FORCE (INITIAL / AFTER TEST)	30P : 1.44N MIN. 40P : 2.16N MIN.
COPLANARITY	0.10 MAX.
PRODUCT SPECIFICATION	PRS-2465
TEST REPORT	TR-18016
PACKING STANDARD	300-824
INSTRUCTION MANUAL	HIM-18016
APPEARANCE CRITERIA NO.	QLS-A***

Rev.33



# Custom Connectors Available

 RF  
Connectors

MHF® series



CABLINE® series



Micro-Coaxial/Twinaxial  
Connectors

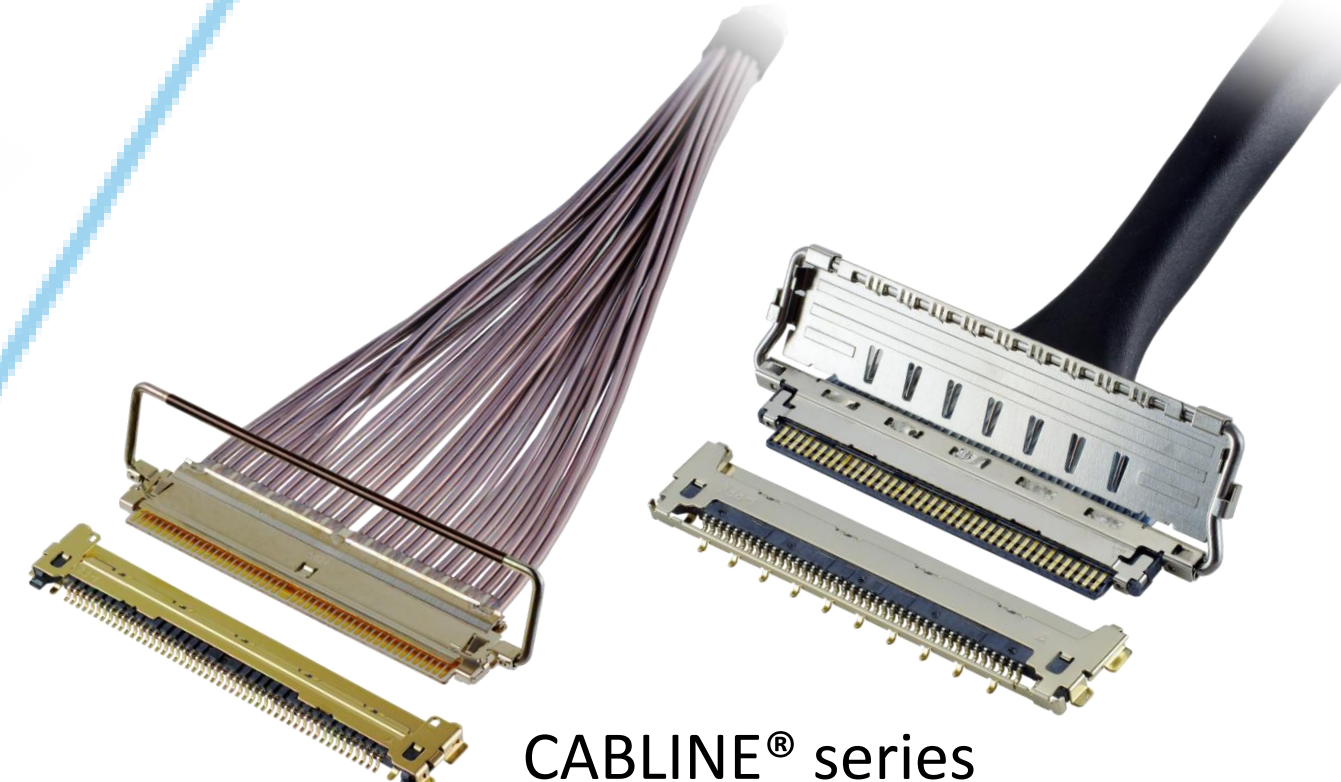

Wire-to-Board  
Connectors/  
Terminals

AP series

ISH® series

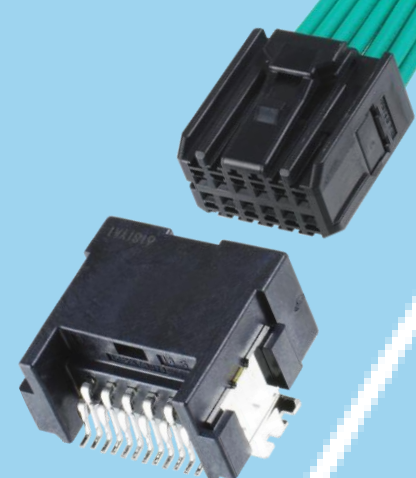
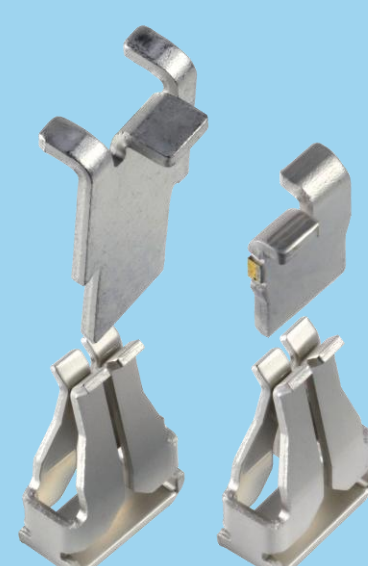

NOVASTACK® series



Board-to-Board  
Connectors

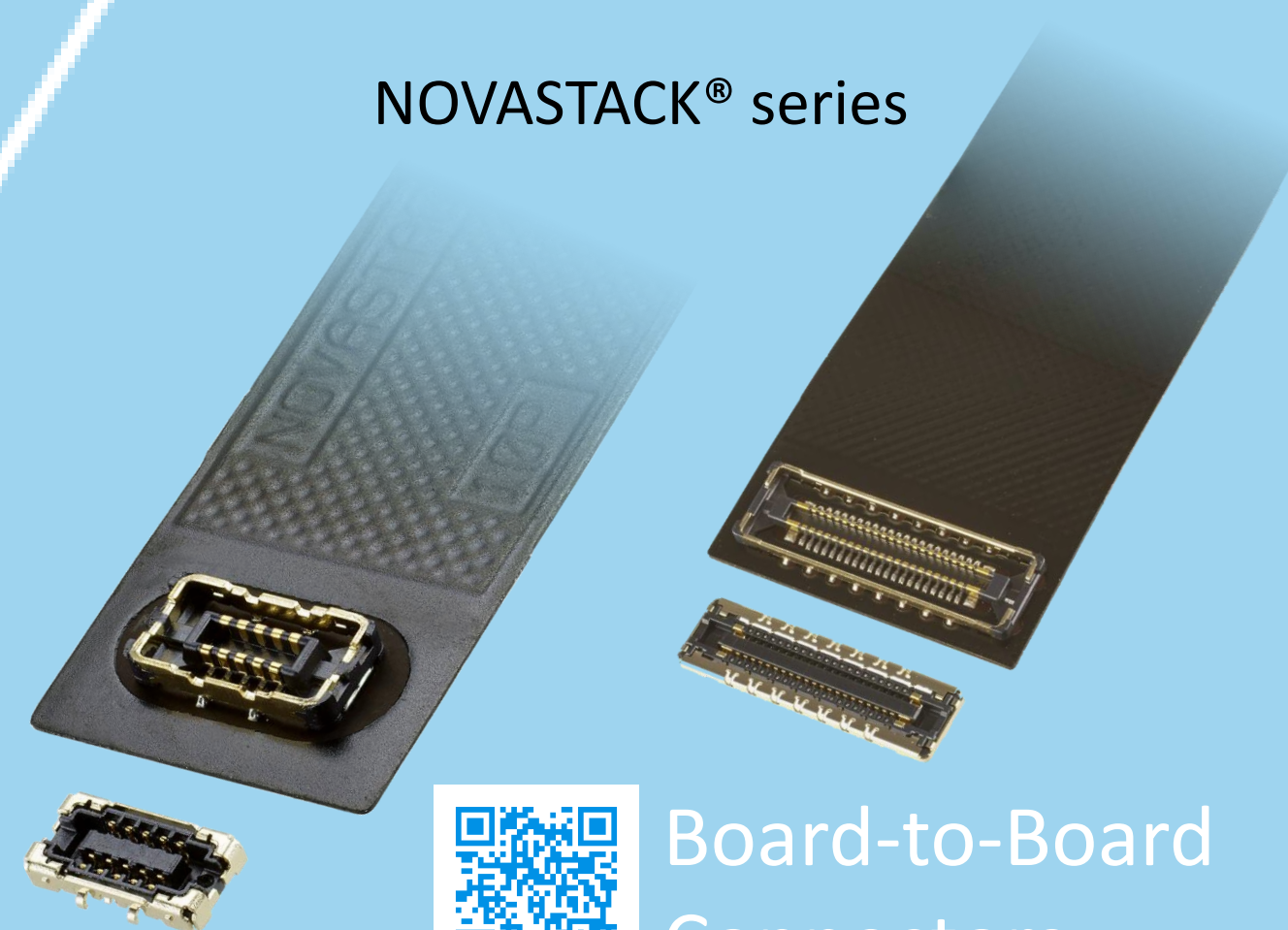

I/O  
Connectors

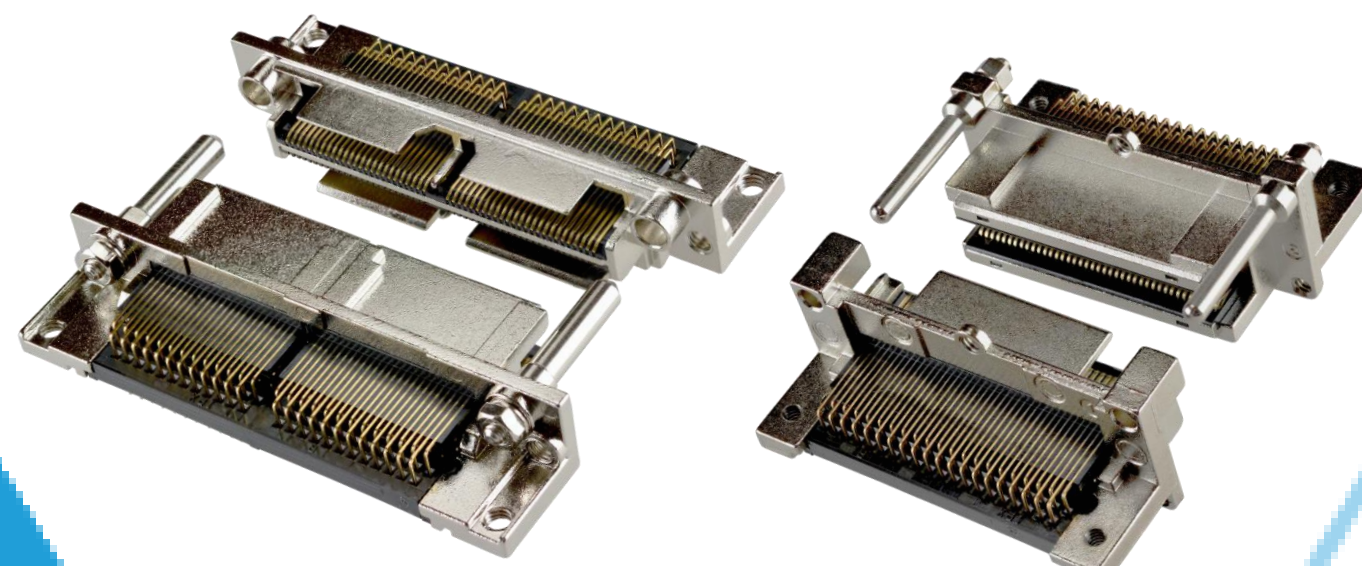

MINIDOCK™ series

MINIFLEX® series

EVAFLEX® series



FPC/FFC  
Connectors

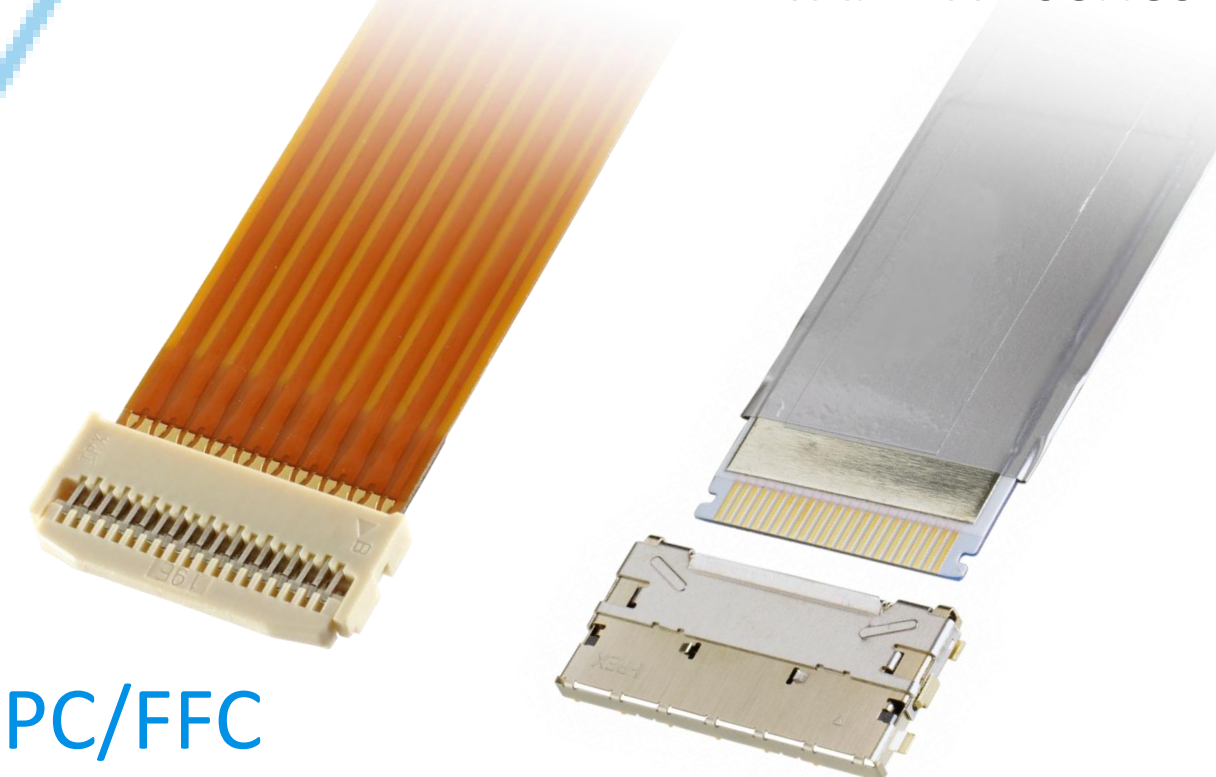

Inquiry



I-PEX, MHF, CABLINE, NOVASTACK, ISH, IARPB, MINIFLEX, EVAFLEX, MINIDOCK and ZenShield are registered trademarks of I-PEX Inc. Please note that the contents in the catalog might be changed without prior notification. I-PEX Inc. assumes no responsibility for any inaccuracies or obligation to update information on these documents. Please be sure to read and understand the latest "Precautions for Use" and "Instruction Manual" before you use our products. We shall not be responsible for any defects, damages or troubles in case you use our products without following the precautions for use. Please feel free to contact our sales representatives when you use our products for any applications that require very high reliability and safety, or that relate to human life (ex. nuclear power control, aerospace, transportation, medical equipment, safety equipment etc.).

Contact your sales representative  
or more detailed information.

[www.i-pex.com](http://www.i-pex.com)

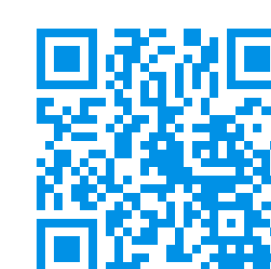

# I-PEX

© I-PEX Inc. 2025  
All rights reserved