

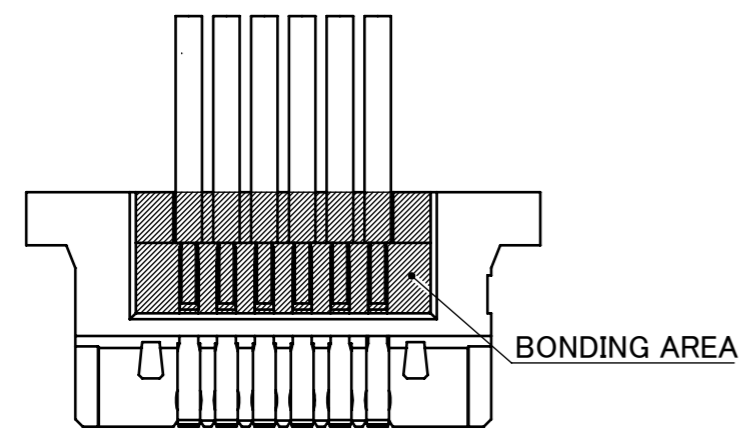

CAUTION VISIT OUR WEBSITE FOR LATEST VERSIONS OF INSTRUCTION MANUAL NO. HIM-14010 TO HANDLE THE PRODUCT PROPERLY AND SAFELY.

PART No.	POS.	A	B	C	D	E
20598-006T-02	6	6.80	5.50	3.50	2.50	4.50
20598-008T-02	8	7.80	6.50	4.50	3.50	5.50
20598-010T-02	10	8.80	7.50	5.50	4.50	6.50
◆20598-020T-02	20	13.80	12.50	10.50	9.50	11.50

◆MARK MEANS NOT AVAILABLE

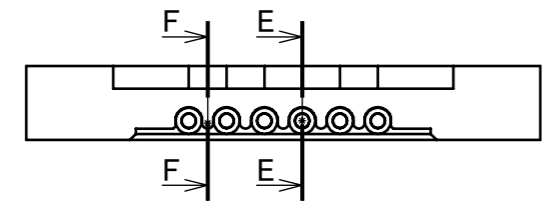
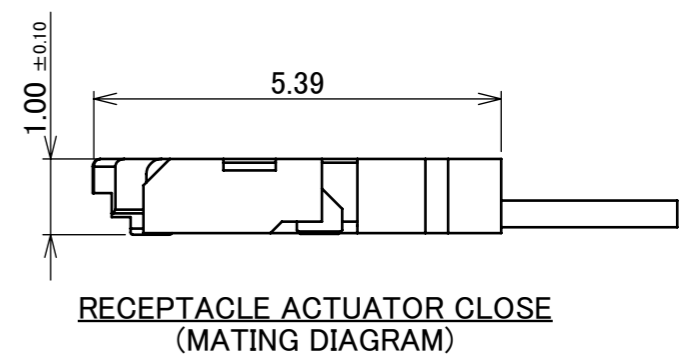
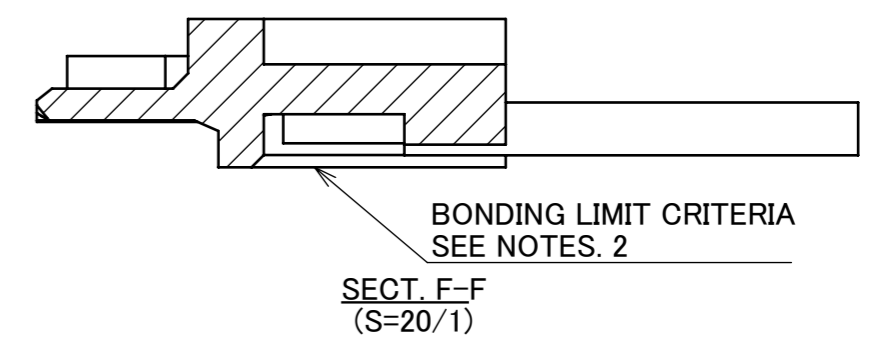
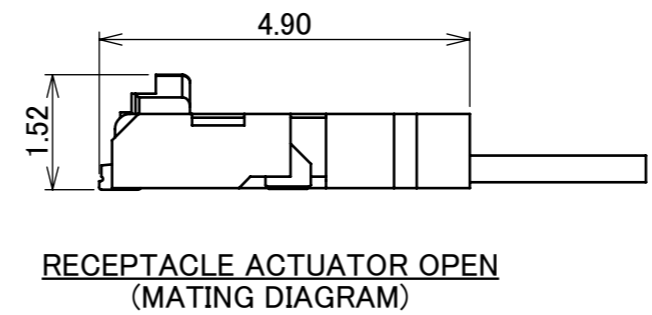
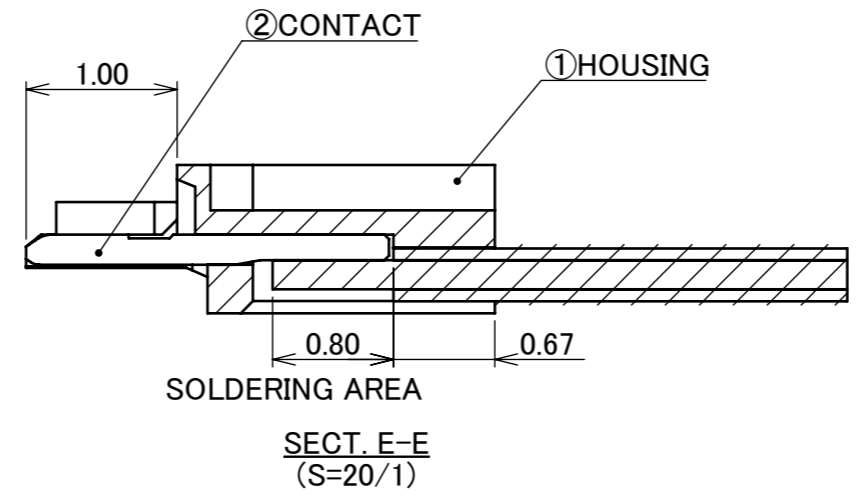
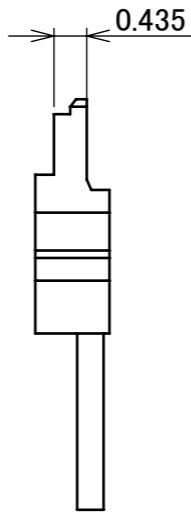
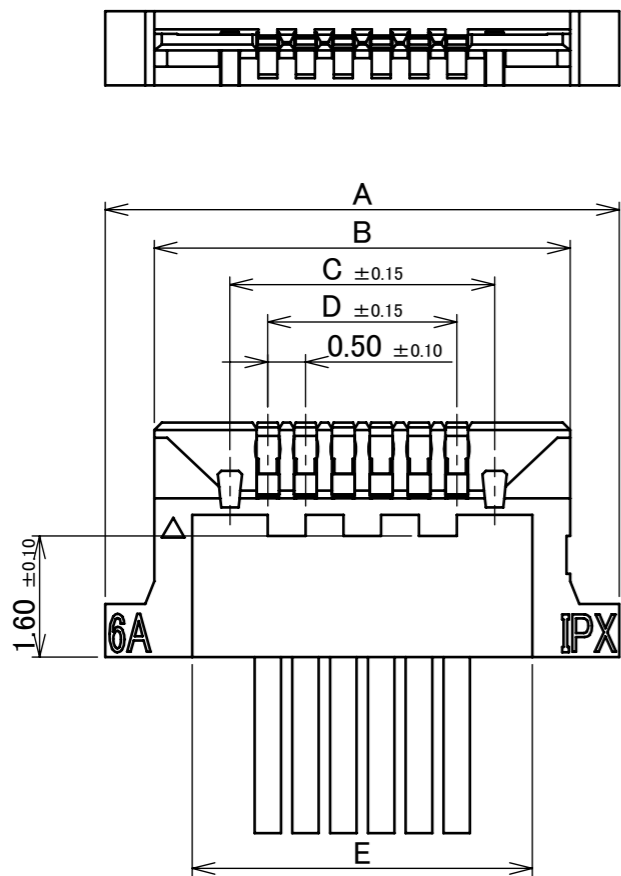

NOTES.
 1. DO NOT PULL THE CABLE WHEN UN-MATING CONNECTORS
 2. BONDING MUST NOT EXCEED THE LIMIT CRITERIA

TABLE. 1

PART NO.	FINISH
20598-0**T-02	CONTACT AREA : Au 0.1 μm MIN. OVER Ni 1.0 μm MIN. SOLDERING AREA : Au 0.03 μm MIN. OVER Ni 1.0 μm MIN.

NO.	DISCRIPTION	MATERIAL	FINISH , REMARKS
2	CONTACT	PHOSPHOR BRONZE	SEE TABLE. 1
1	HOUSING	LCP	UL94V-0, BLACK

REV.	ECN	BY	DATE	APP.	ANGLE	6 OVER 30 MAX.	±0.3	PROJECTION	SERIES No.	CUSTOMER COPY
3	Z191358	R.F	Oct./08/'19	H.I	6 MAX.	±0.2	30 OVER 120 MAX.	±0.5	R2	DW 5 PLUG CABLE ASS'Y I-PEX
2	Z181301	K.T	Oct./03/'18	Y.S	GENERAL TOLERANCE.		TITLE		SCALE	
1	Z170516	Y.O	May./02/'17	TAK	DWG.	DATE	DW 5		10:1	
0	Z150395	Y.F	Apr./07/'15		Y.Fukumoto	Apr./07/'15	PLUG CABLE ASS'Y		UNIT	
REV.	ECN	BY	DATE	APP.	CHK.	DATE	DWG. No.		mm	
REVISION RECORD					T.Takano	Apr./07/'15	20598		SIZE	SHEET 1/4 REV. 3

ITEMS	SPECIFICATION
APPLICABLE CABLE	DISCRETE : AWG#34
RATING VOLTAGE	50V AC (PER CONTACT)
RATING AMPERAGE	0.7A DC [AWG#34] (PER CONTACT)
OPERATING TEMPERATURE	233~358K(-40°C~85°C)
OPERATING HUMIDITY	80% MAX.(NON-CONDENSING)
CONTACT RESISTANCE	INITIAL : 40mohm MAX. / AFTER TEST : \triangleleft 20mohm MAX.
INSULATION RESISTANCE	INITIAL : 1000Mohm MIN. / AFTER TEST : 500Mohm MIN.
DIELECTRIC WITHSTANDING VOLTAGE	AC200V 1min
DURABILITY	20TH CYCLES
ACTUATOR LOCKING FORCE (INITIAL / 20TH CYCLES)	INITIAL/ 20TH CYCLES : 0.6N(61gf) \times (n + 2) MAX.
ACTUATOR UNLOCKING FORCE (INITIAL / 20TH CYCLES)	INITIAL/ 20TH CYCLES : 0.05N(5gf) \times (n + 2) MIN.
PLUG RETENTION FORCE (INITIAL / AFTER TEST)	INITIAL : 0.15N(15gf) \times n + 2.0N MIN. / AFTER TEST : 0.15N(15gf) \times n + 1.0N MIN.
PRODUCT SPECIFICATION	PRS-1880
TEST REPORT	TR-13103
PACKING STANDARD	PST-14006
INSTRUCTION MANUAL	HIM-14010
ASSEMBLY MANUAL	ASM-12002
APPEARANCE CRITERIA No.	QLS-A***

※ "n" IS THE NUMBER OF PIN

ANGLE	$\pm 2^\circ$	6 OVER 30 MAX.	± 0.3	PROJECTION 	SERIES No. R2	CUSTOMER COPY
6 MAX.	± 0.2	30 OVER 120 MAX.	± 0.5			
GENERAL TOLERANCE.				TITLE DW 5 PLUG CABLE ASS'Y	SCALE	UNIT mm
DWG.	DATE					
CHK.	DATE					
APP.	DATE					
				DWG. No.	20598	SIZE A3
				SHEET 2/4		REV. 3

PART No.	POS.	D
20598-006T-02	6	2.50
20598-008T-02	8	3.50
20598-010T-02	10	4.50
◆20598-020T-02	20	9.50

◆MARK MEANS NOT AVAILABLE

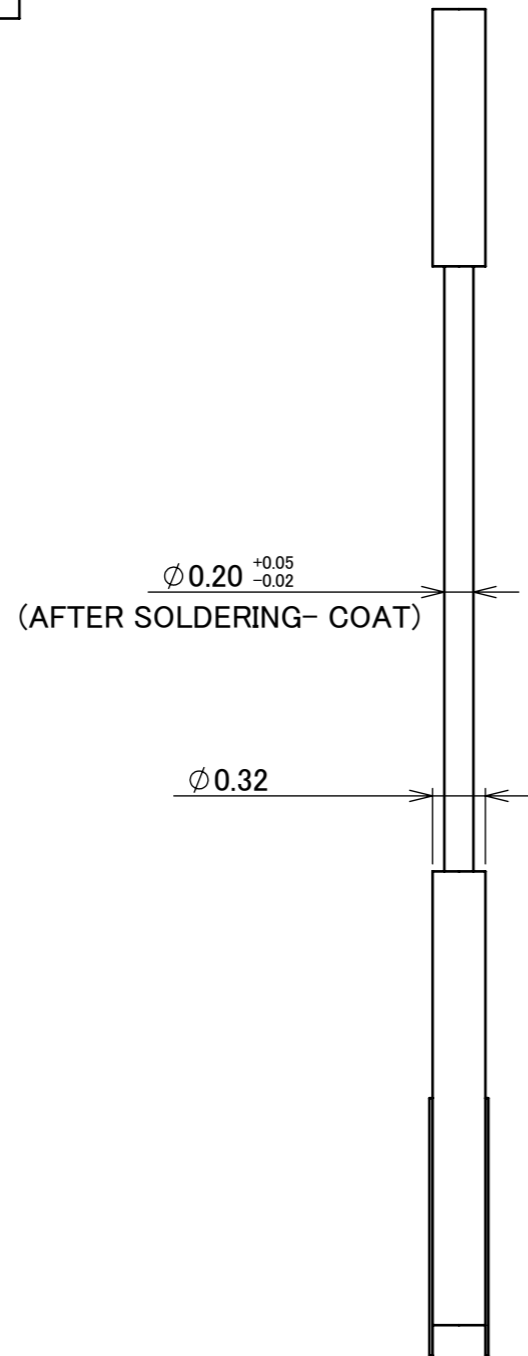

DISCRETE CABLE AWG#34

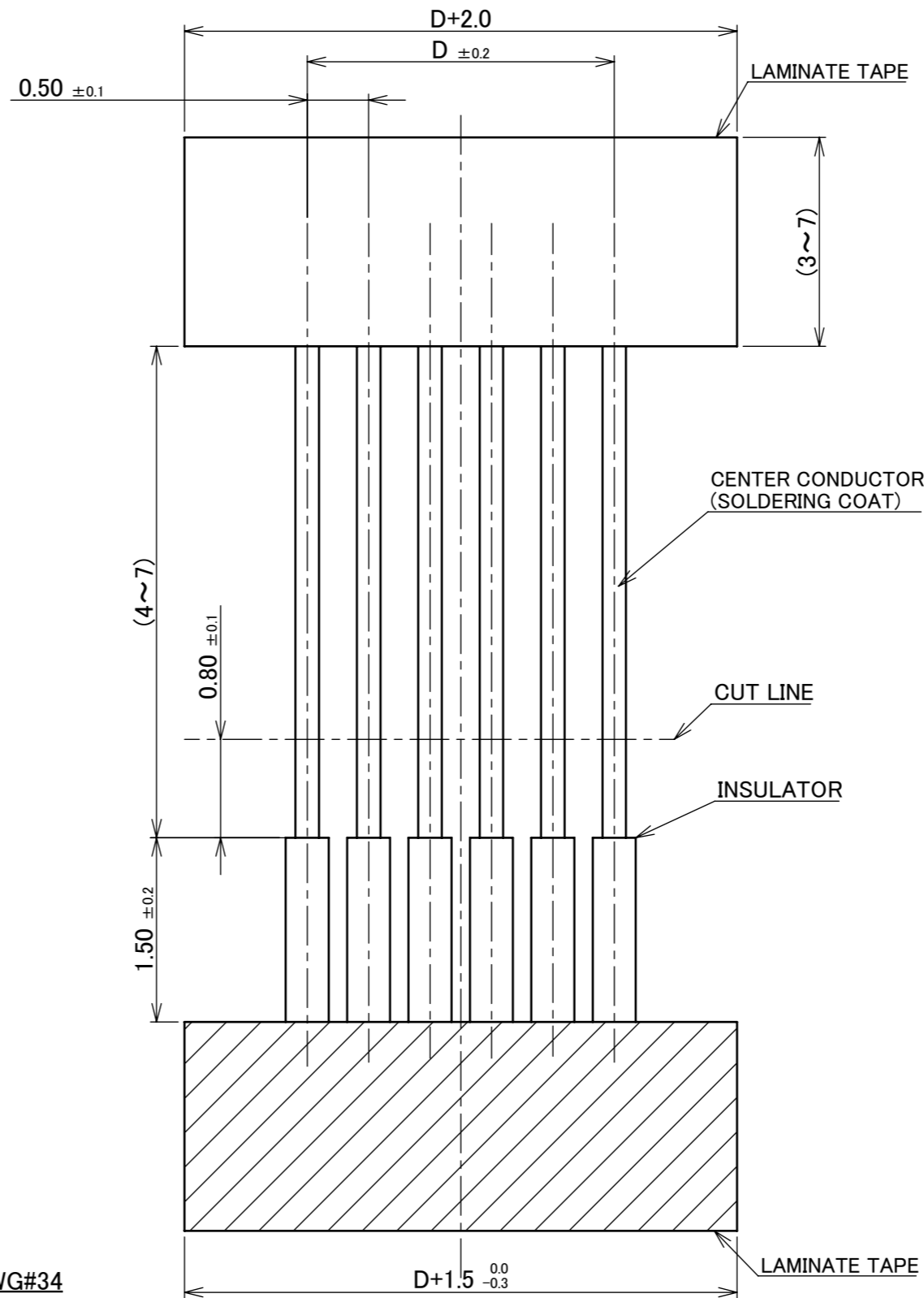

RECOMMENDED DISCRETE CABLE DIMENSION

ANGLE	$\pm 2^\circ$	6 OVER 30 MAX.	± 0.3	PROJECTION ①	SERIES No. R2	CUSTOMER COPY
6 MAX.	± 0.2	30 OVER 120 MAX.	± 0.5			
GENERAL TOLERANCE.				TITLE DW 5 PLUG CABLE ASS'Y	SCALE 20:1	UNIT mm
DWG.	DATE		DWG. No. 20598			
CHK.	DATE					
APP.	DATE					
				SIZE A3	SHEET 3/4	REV. 3

PART No.	QTY. IN DITCH (PIECES / DITCH)	QTY. IN TRAY (PIECES / TRAY)	QTY. PER SHIPPING CARTON (TRAYS / CARTON)	QTY. PER PACKING CARTON (TRAYS / CARTON)
20598-006T-02	1	250	20 / CARTON = 5000	20000 (4BOXES)
20598-008T-02				
20598-010T-02				
◆20598-020T-02				

◆MARK MEANS NOT AVAILABLE

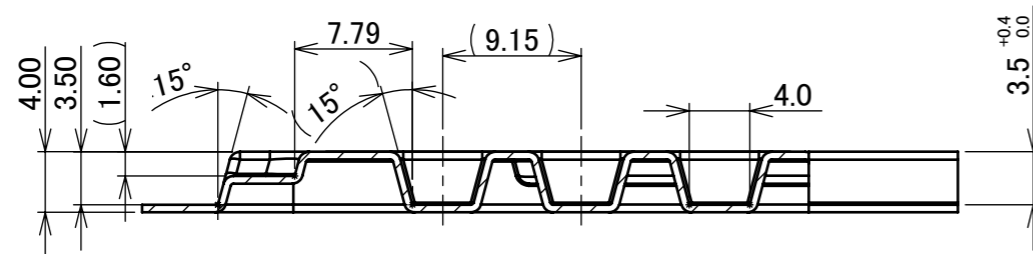
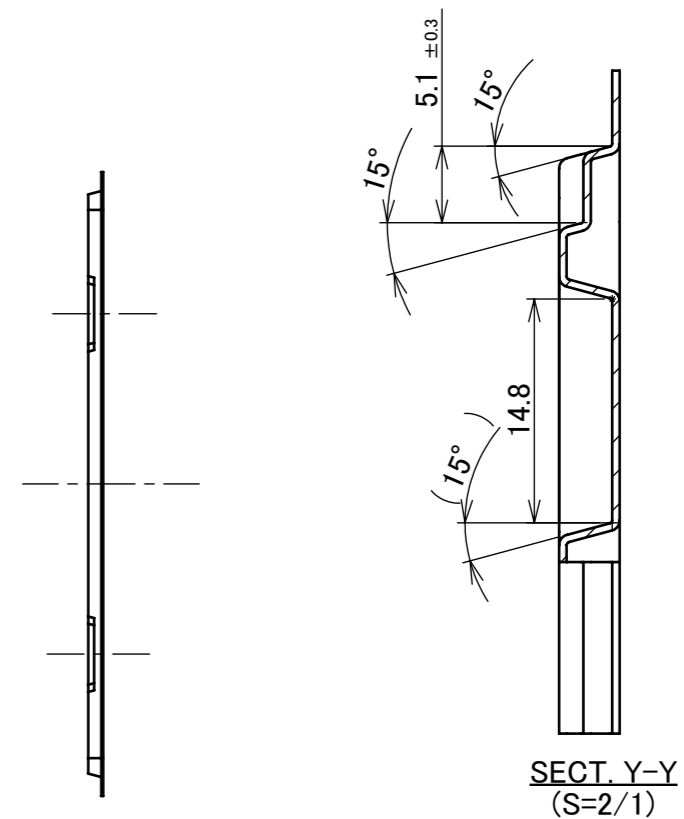
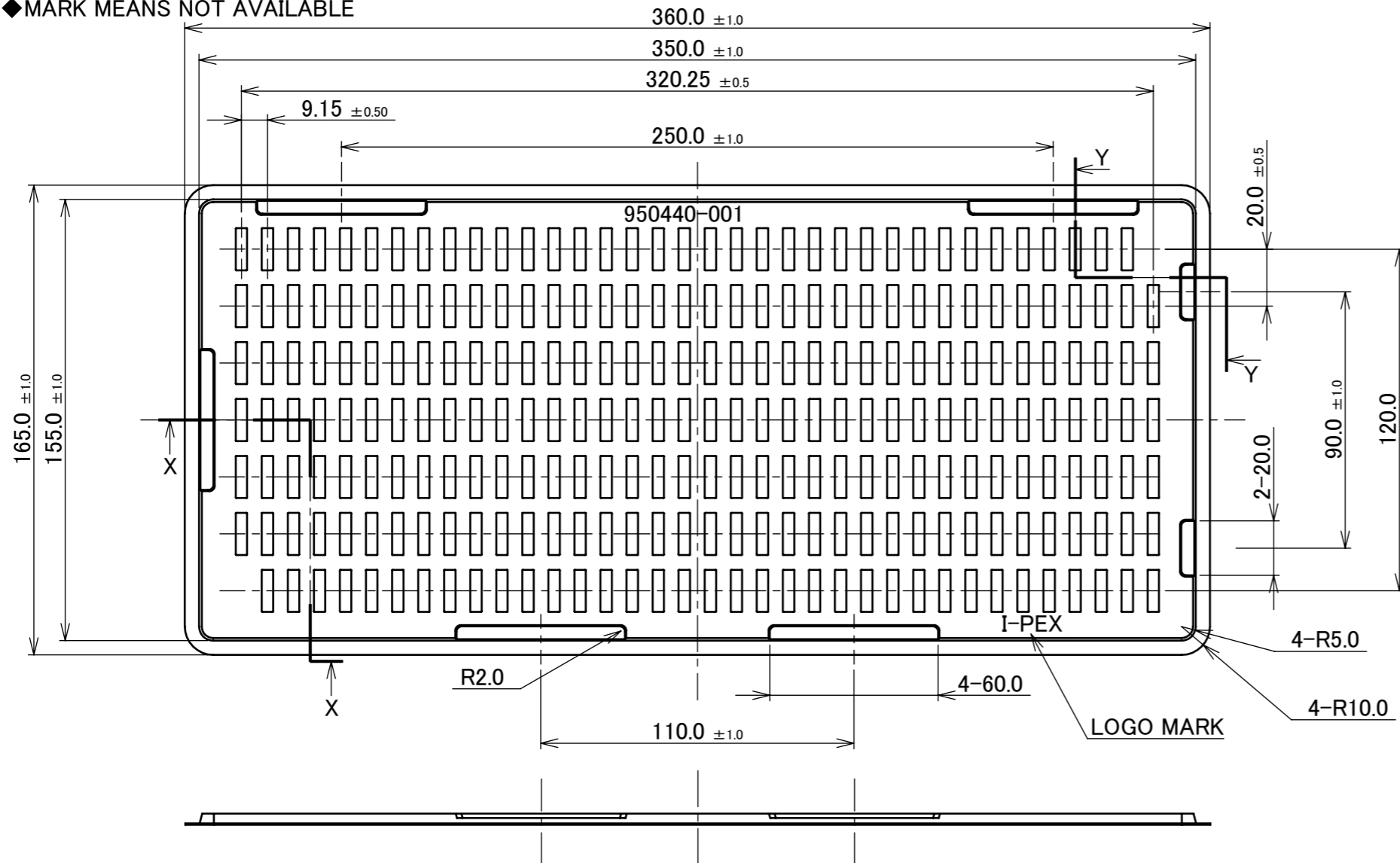

SECT. X-X
(S=2/1)

NOTES.

3. THE TRAY IS MADE BY VACUUM MALE TYPE MOLD.
4. UNLESS OTHERWISE SPECIFIED, USE DRAFT ANGLE 5° MAX.
5. UNLESS OTHERWISE SPECIFIED, USE R0.2 MAX.
6. THE DIMENSIONS ON THE DRAFT ANGLE PART : THE POINT OF INTERSECTION.
7. DRAFT ANGLE IS OMITTED ON THE FRONT VIEW.

NO.	DISCRIPTION	MATERIAL	FINISH , REMARKS
3	TRAY	PS t=0.5	ANTI-STATIC TYPE

ANGLE	±2°	6 OVER 30 MAX.	±0.3	PROJECTION	SERIES No.	CUSTOMER COPY
6 MAX.	±0.2	30 OVER 120 MAX.	±0.5		R2	
GENERAL TOLERANCE.				TITLE	SCALE	
DWG.	DATE	DW 5 PLUG CABLE ASS'Y		UNIT		
CHK.	DATE	DWG. No.		mm		
APP.	DATE	20598		SIZE		
					A3	SHEET 4/4 REV. 3