



Halogen Free



RoHS Compliant



CAUTION

VISIT OUR WEBSITE FOR LATEST VERSIONS OF INSTRUCTION MANUAL NO. HIM-14010 AND HIM-12019 TO HANDLE THE PRODUCT PROPERLY AND SAFELY.

PART No.	POS.	A	B	C	D	E	F	G
20597-006E-02	6	6.70	3.50	2.50	5.80	4.80	5.56	6.15
20597-008E-02	8	7.70	4.50	3.50	6.80	5.80	6.56	7.15
20597-010E-02	10	8.70	5.50	4.50	7.80	6.80	7.56	8.15
◆20597-020E-02	20	13.70	10.50	9.50	12.80	6.80	12.56	13.15

◆MARK MEANS NOT AVAILABLE

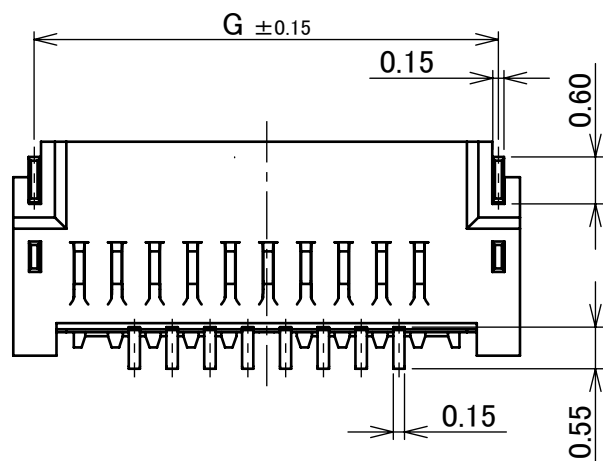
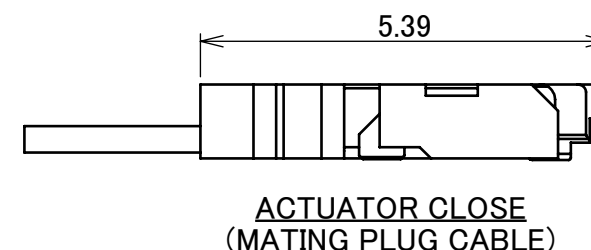
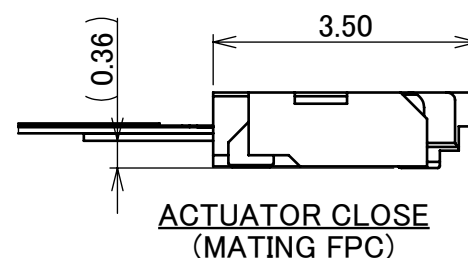
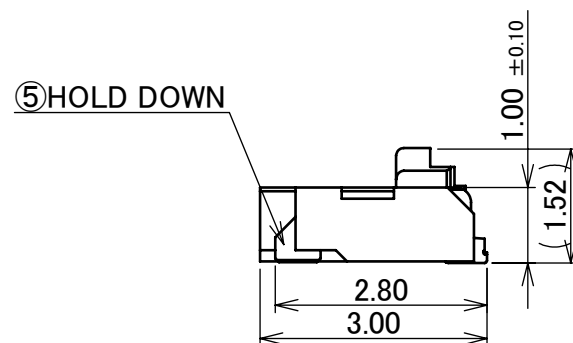
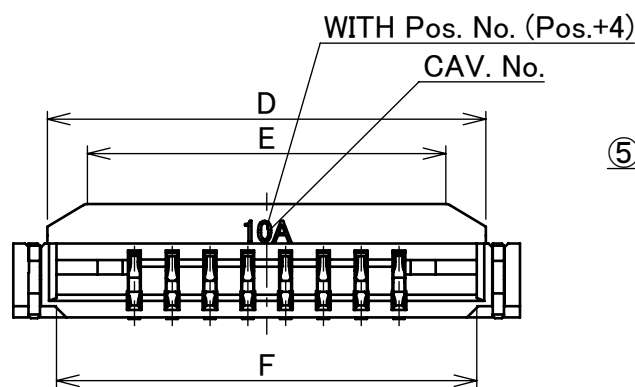
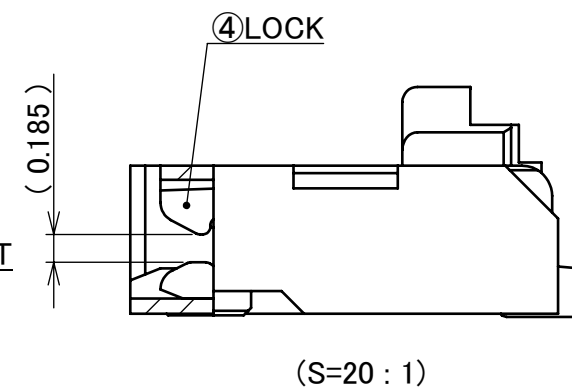
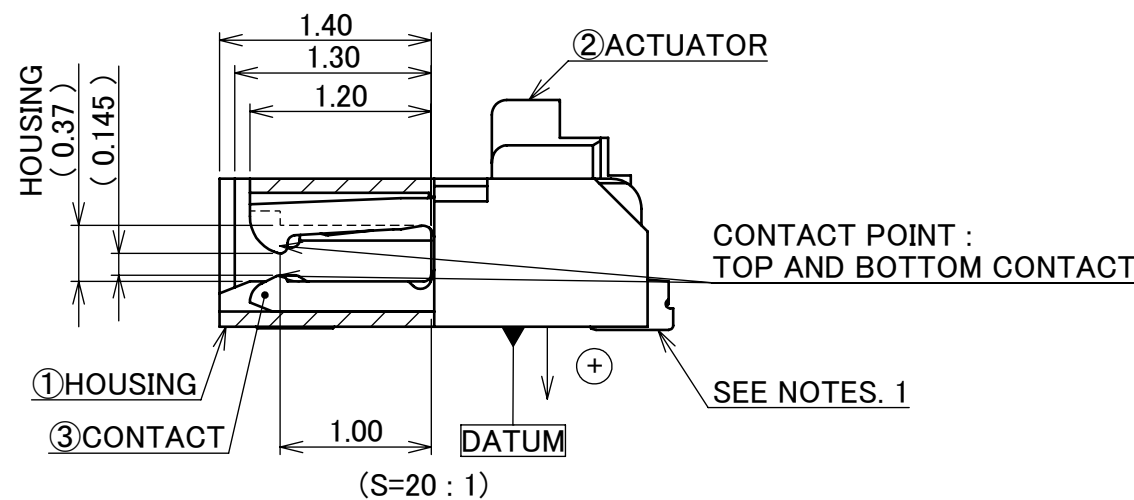
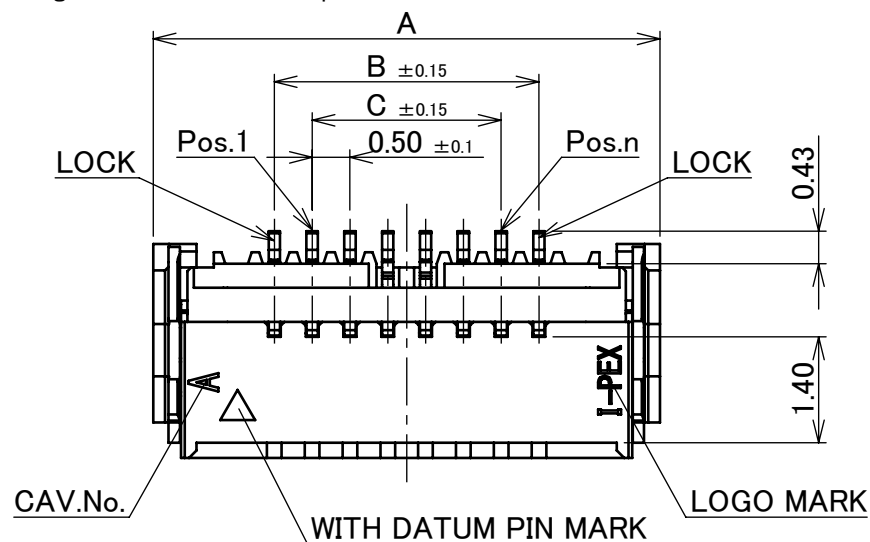

5	HOLD DOWN	PHOSPHOR BRONZE	Sn 2~6 μm MIN.OVER Ni 1.0 μm MIN.
4	LOCK	PHOSPHOR BRONZE	Au 0.03 μm MIN. OVER Ni 1.0 μm MIN.
3	CONTACT	PHOSPHOR BRONZE	CONTACT AREA : Au 0.1 μm MIN. OVER Ni 1.0 μm MIN. SOLDERING AREA : Au 0.03 μm MIN. OVER Ni 1.0 μm MIN.
2	ACTUATOR	LCP	UL94V-0, BEIGE
1	HOUSING	LCP	UL94V-0, BEIGE

REV.	ECN	BY	DATE	APP.	APP.	ANGLE	±2°	6 OVER 30 MAX.	±0.3	PROJECTION	SERIES No.	TITLE	SCALE	UNIT	SIZE	SHEET	REV.
8	Z240625	W.L	2024/06/14	M.T		ANGLE	±2°	6 OVER 30 MAX.	±0.3		R4	DW-5 RECEPTACLE	10:1	mm	A3	1/5	8
7	Z191358	R.F	2019/10/08	H.I		6 MAX.	±0.2	30 OVER 120 MAX.	±0.5								
6	Z181430	K.T	2018/11/01	Y.S		GENERAL TOLERANCE.											
5	Z181301	K.T	2018/10/03	Y.S		DWG.		DATE									
4	Z170315	Y.O	2017/03/24	TAK		CHK.	Y.Fukumoto	2015/04/07									
3	Z170035	Y.O	2017/01/12	TAK		APP.	K.Narita										
REVISION RECORD						APP.	T.Takano			DWG. No.	20597						

NOTES  
1. CONTACT TAIL IS PROJECTION FROM HOUSING IN THE + DIRECTION. (0~0.06)

ITEMS	SPECIFICATION
RATING VOLTAGE	50V AC (PER CONTACT)
RATING AMPERAGE	0.5A DC [FPC] (PER CONTACT) 0.7A DC [AWG#34] (PER CONTACT)
OPERATING TEMPERATURE	233~358K(-40°C~85°C)
OPERATING HUMIDITY	80% MAX.
CONTACT RESISTANCE	INITIAL : 40mohm MAX. / AFTER TEST : $\triangle$ 20mohm MAX.
INSULATION RESISTANCE	INITIAL : 1000Mohm MIN. / AFTER TEST : 500Mohm MAX. (PLUG CABLE) 100Mohm MIN. (FPC)
DIELECTRIC WITHSTANDING VOLTAGE	AC200V 1min
DURABILITY	20TH CYCLES
ACTUATOR LOCKING FORCE (INITIAL / 20TH CYCLES)	INITIAL/ 20TH CYCLES : 0.6N(61gf) × (n + 2) MAX.
ACTUATOR UNLOCKING FORCE (INITIAL / 20TH CYCLES)	INITIAL/ 20TH CYCLES : 0.05N(5gf) × (n + 2) MIN.
PLUG AND FPC RETENTION FORCE (INITIAL / AFTER TEST)	INITIAL : 0.15N(15gf) × n + 2.0N MIN. / AFTER TEST : 0.15N(15gf) × n + 1.0N MIN.
COPLANARITY	0.08 MAX.
PRODUCT SPECIFICATION	PRS-1880
TEST REPORT	TR-13103
PACKING STANDARD	PST-13047
INSTRUCTION MANUAL	HIM-14010 (FOR MATING PLUG CABLE) HIM-12019 (FOR MATING FPC)
APPEARANCE CRITERIA No.	QLS-A***

※ "n" IS THE NUMBER OF PIN

ANGLE	±2°	6 OVER 30 MAX.	±0.3	PROJECTION 	SERIES No. R4	CUSTOMER COPY			
6 MAX.	±0.2	30 OVER 120 MAX.	±0.5			SCALE -	<b>I-PEX</b>		
GENERAL TOLERANCE.				TITLE DW-5 RECEPTACLE		UNIT mm			
DWG.	DATE			DWG. No. 20597		SIZE	SHEET	REV.	
CHK.						A3	2/5	8	
APP.									

PART No.	POS.	B	C	G	H
20597-006E-02	6	3.50	2.50	6.15	5.50
20597-008E-02	8	4.50	3.50	7.15	6.50
20597-010E-02	10	5.50	4.50	8.15	7.50
◆20597-020E-02	20	10.50	9.50	13.15	12.50

◆ MARK MEANS NOT AVAILABLE

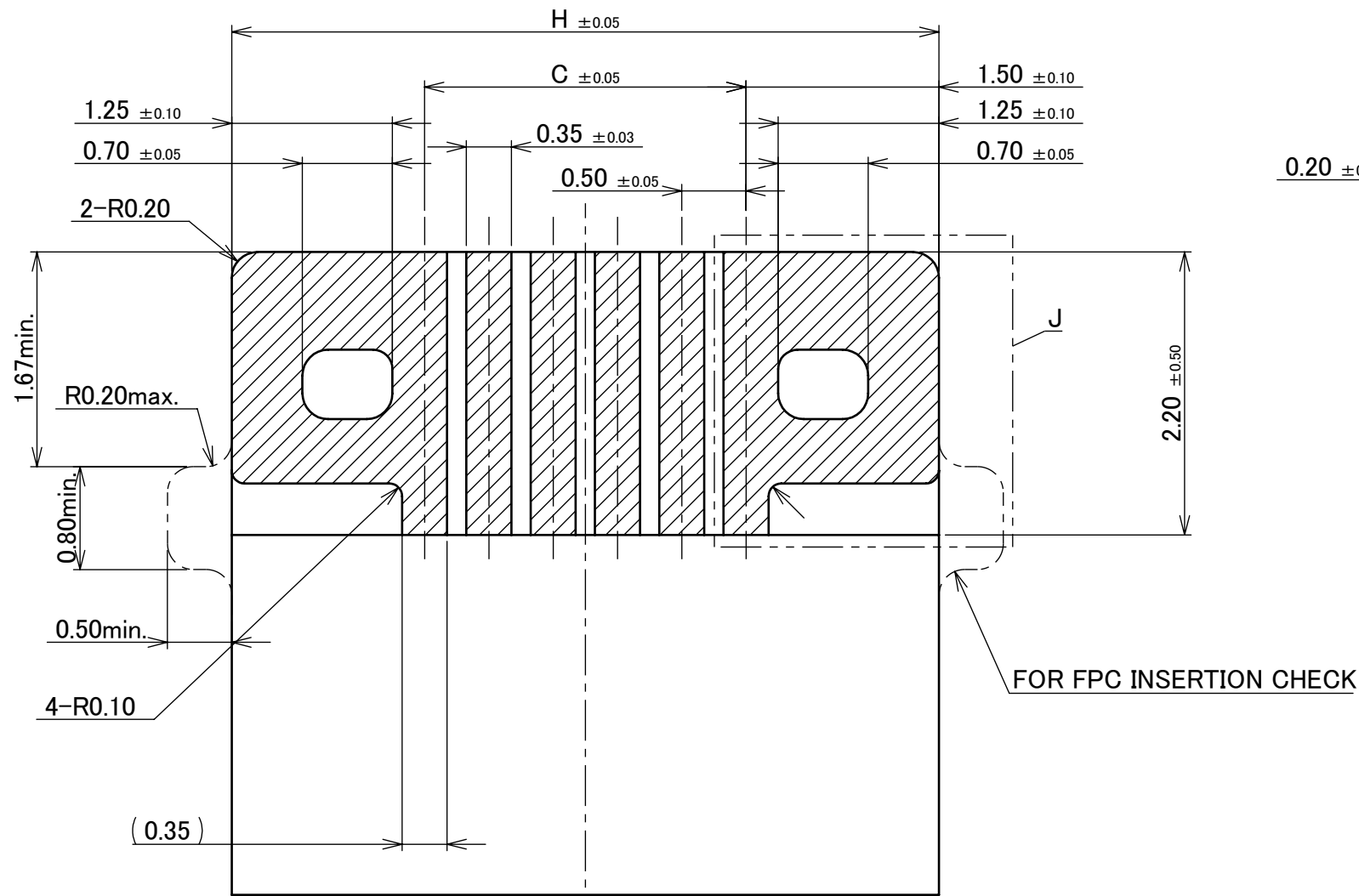

**RECOMMENDED FPC LAYOUT**

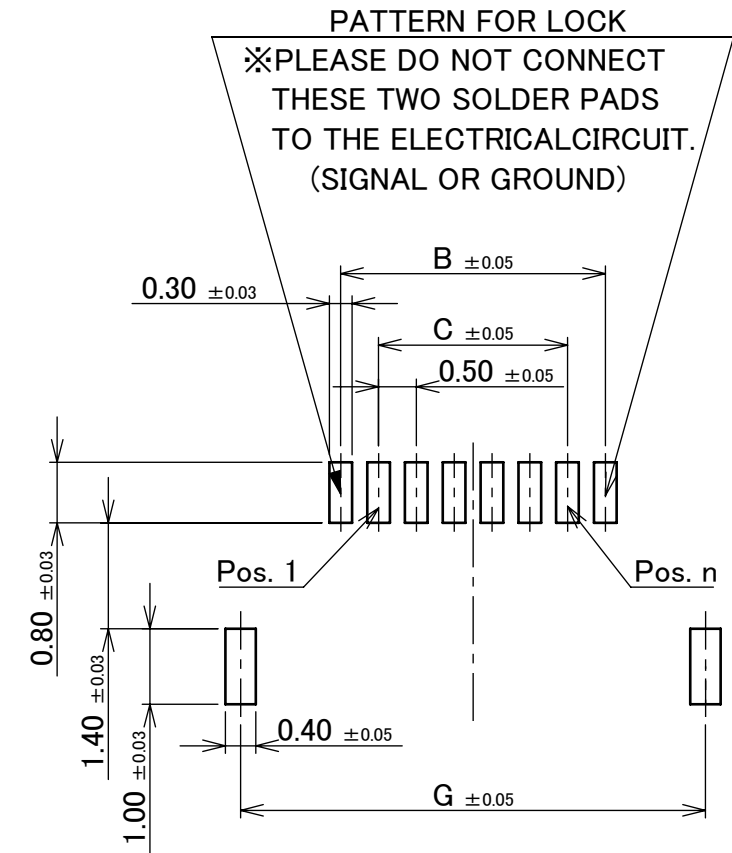
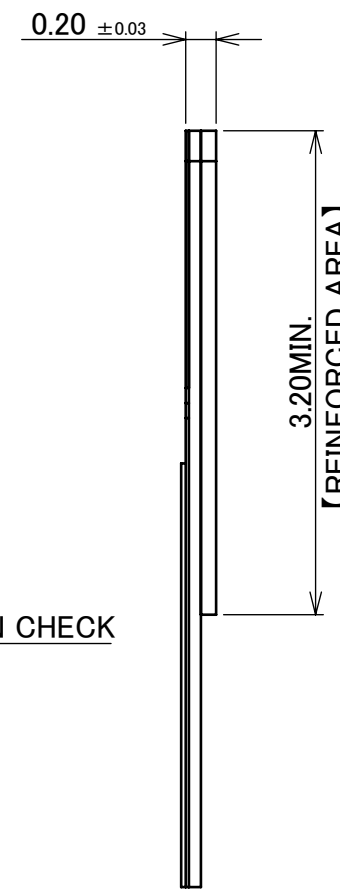

**RECOMMENDED PCB LAYOUT & METAL MASK LAYOUT**  
METAL MASK THICKNESS : t=0.12mm

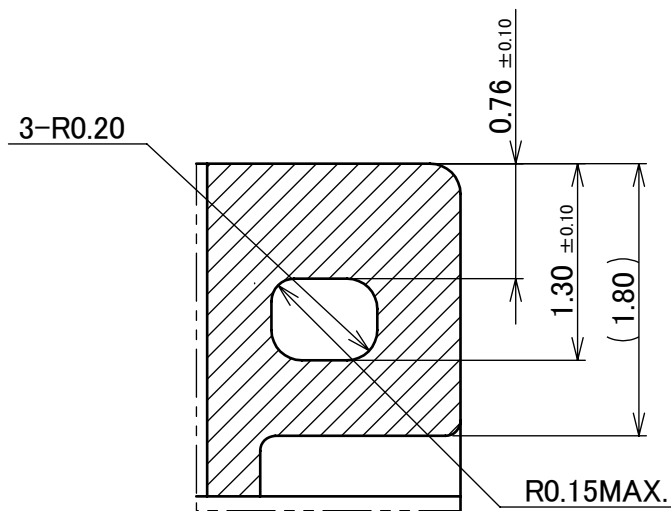

**DETAIL J**  
(S=20/1)

- NOTES**
- MATERIAL**  
COVER FILM : PI  
CONDUCTOR : COPPER(RARE)  
BASE FILM : PI  
STIFFENER : PI  
ADHESIVE : THERMOSETTING ADHESIVE
  - FINISH**  
Au OVER Ni PLATING.

ANGLE	±2°	6 OVER 30 MAX.	±0.3	PROJECTION ⊕	SERIES No. R4	CUSTOMER COPY			
6 MAX.	±0.2	30 OVER 120 MAX.	±0.5						
GENERAL TOLERANCE.				TITLE DW-5 RECEPTACLE		SCALE 10:1	<b>I-PEX</b>		
DWG.	DATE			DWG. No. 20597		UNIT mm			

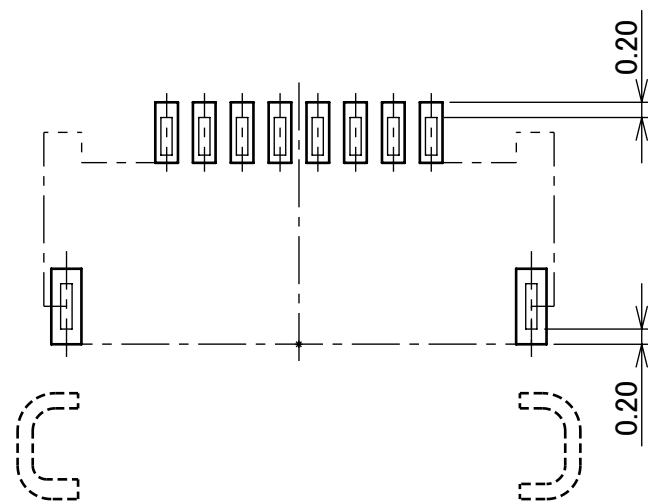

CONNECTOR ON RECOMMENDED FOOTPRINT PATTERN

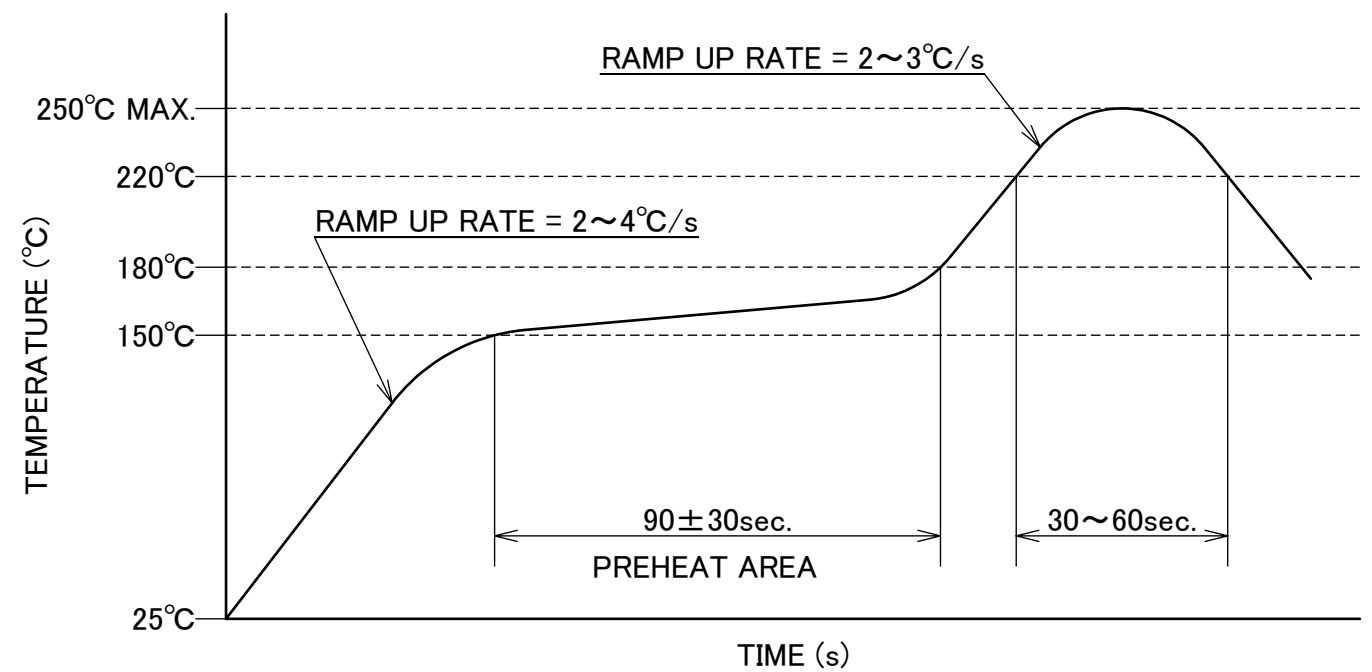

REFLOW TEMPERATURE PROFILE  
 SENJU METAL INDUSTRY CO., LTD. : M705-SHF(Sn96.5 Ag3.0 Cu0.5)

ANGLE	±2°	6 OVER 30 MAX.	±0.3	PROJECTION 	SERIES No. R4	CUSTOMER COPY		
6 MAX.	±0.2	30 OVER 120 MAX.	±0.5					
GENERAL TOLERANCE.				TITLE DW-5 RECEPTACLE	SCALE 10:1	UNIT <b>I-PEX</b>		
DWG.	DATE							
CHK.								
APP.								
				DWG. No.	20597	SIZE A3	SHEET 4/5	REV. 8

PART No.	K	L	M	N	P	Q	QTY. PER EMBOSS REEL (PIECES / REEL)	QTY. PER PACKING CARTON (REELS / CARTON)
20597-006E-02				7.0	5.5	5.0	5000 PIECES / REEL	7 REELS / CARTON ( 35000 PIECES / CARTON )
20597-008E-02	16.0	13.5	7.5	8.0	6.5	6.0		
20597-010E-02				9.0	7.5	7.0		
◆20597-020E-02	24.0	21.5	11.5	14.0	12.5	12.0	5000 PIECES / REEL	5 REELS / CARTON ( 25000 PIECES / CARTON )

◆ MARK MEANS NOT AVAILABLE

NOTES.

- TAPING SPECIFICATION FOLLOWS JIS C 0806 (IEC 60286-3).
- MAKE EMPTY SECTION OF LEADER AND END ON EACH END OF THE TAPE.
- TOP TAPE SHALL NOT STICK OUT FROM EMBOSS TAPE.
- TOP TAPE SHALL NOT COVER FEED HOLE.

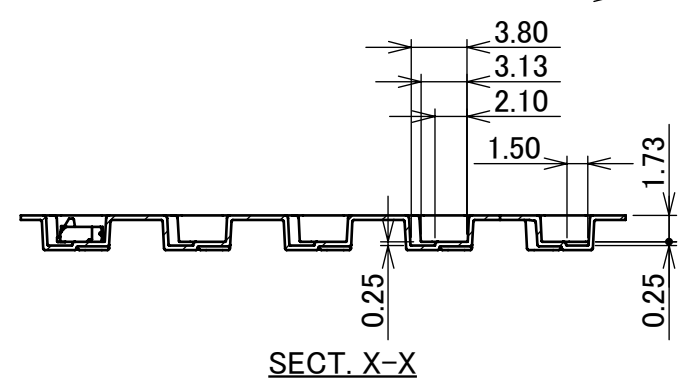
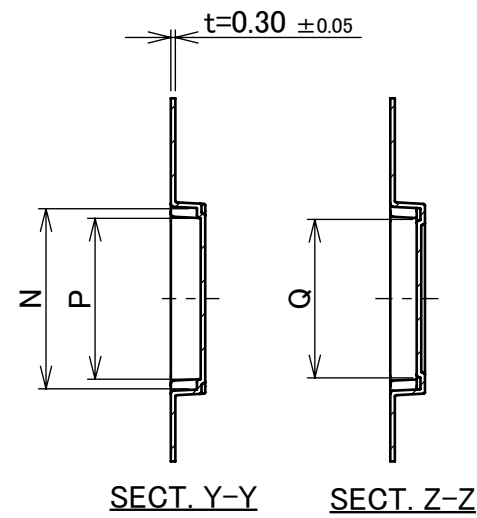
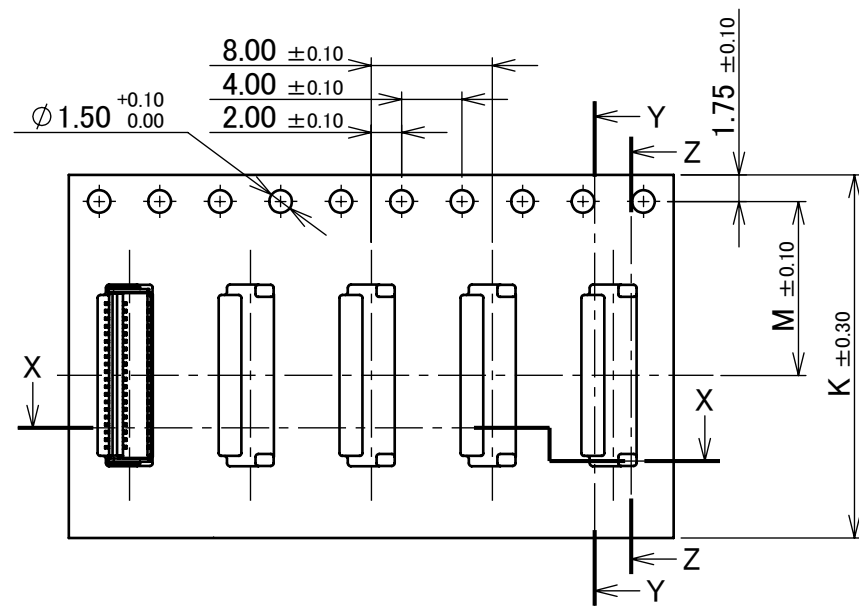
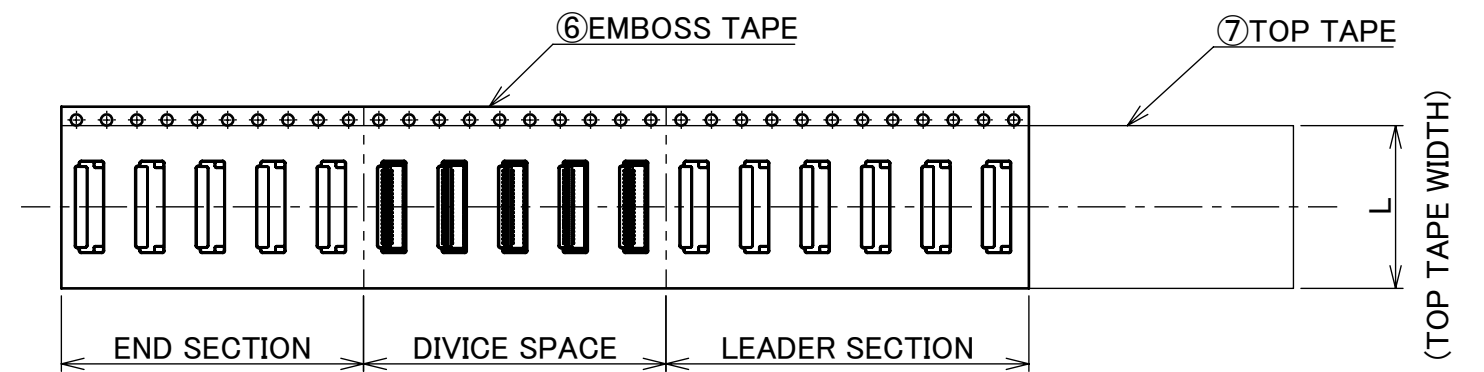
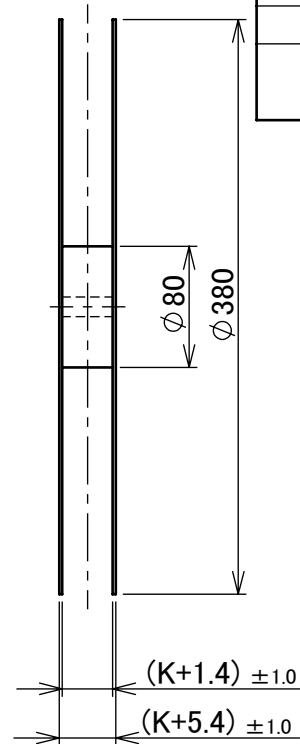
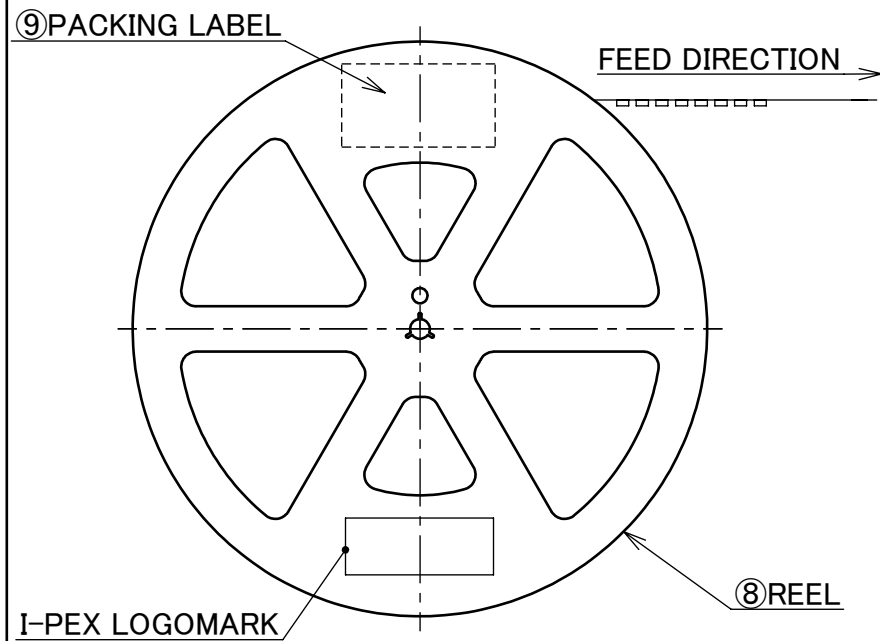

NO.	DISCRIPTION	MATERIAL	FINISH , REMARKS
9	PACKING LABEL	-	-
8	REEL	PS	BLACK
7	TOP TAPE	PET t=0.062 TRANSPARENCY	ANTI-STATIC TYPE HEAT WELDING TYPE
6	EMBOSS TAPE	PS t=0.3 TRANSPARENCY	ANTI-STATIC TYPE

ANGLE	±2°	6 OVER 30 MAX.	±0.3	PROJECTION	SERIES No.	CUSTOMER COPY				
6 MAX.	±0.2	30 OVER 120 MAX.	±0.5		R4	I-PEX				
GENERAL TOLERANCE.									TITLE	SCALE
DWG.	DATE				DW-5				-	
CHK.					RECEPTACLE				UNIT	
APP.					DWG. No.	20597	mm	SIZE	SHEET	REV.
							A3	5/5	8	