

Recommended P/N 20345-0**T-32R

PART NO.	POS.	A	B	C	D	E
20345-010T-32R	10	3.6	6.4	7.2	8.8	5.4
20345-015T-32R	15	5.6	8.4	9.2	10.8	7.4
20345-020T-32R	20	7.6	10.4	11.2	12.8	9.4
20345-025T-32R	25	9.6	12.4	13.2	14.8	11.4
20345-030T-32R	30	11.6	14.4	15.2	16.8	13.4
20345-035T-32R	35	13.6	16.4	17.2	18.8	15.4
20345-040T-32R	40	15.6	18.4	19.2	20.8	17.4

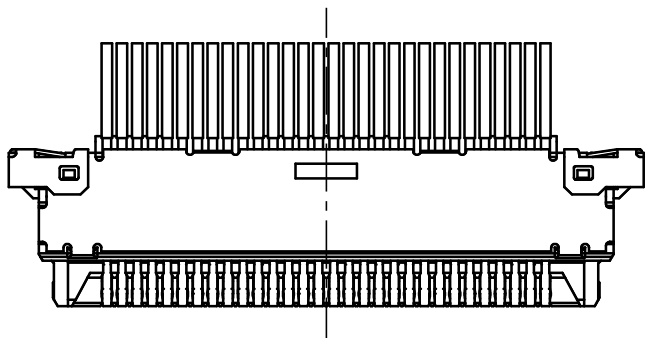

SECT. X-X (S=10/1)

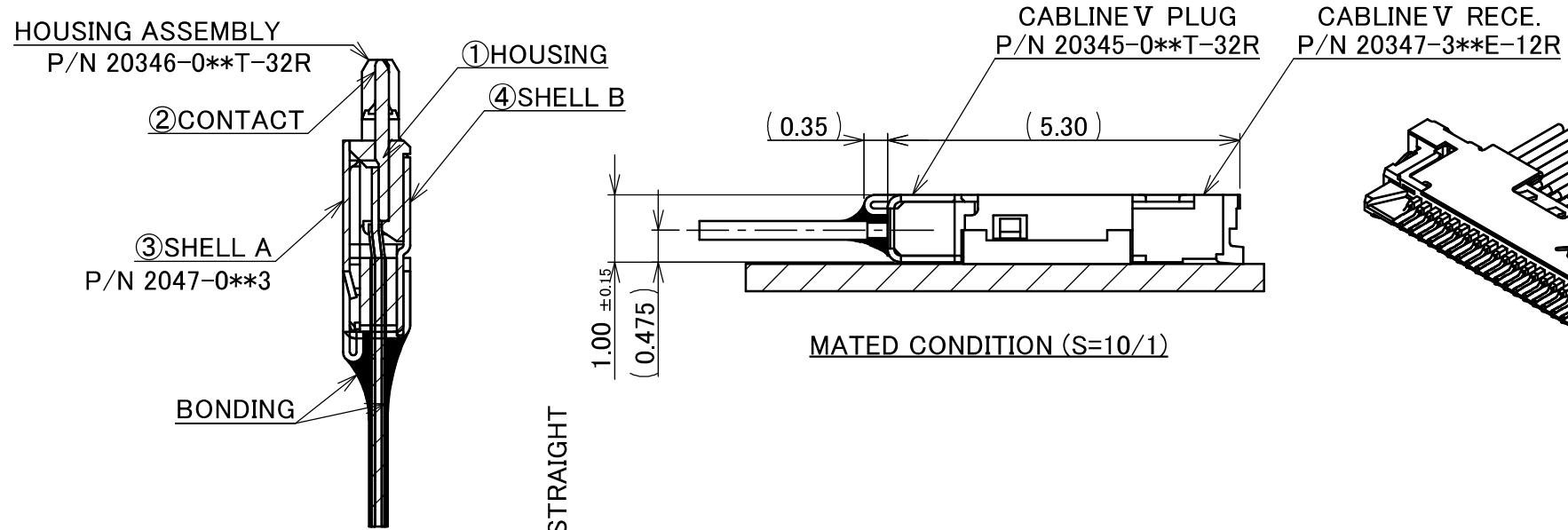
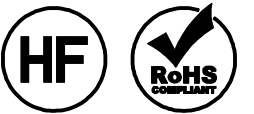
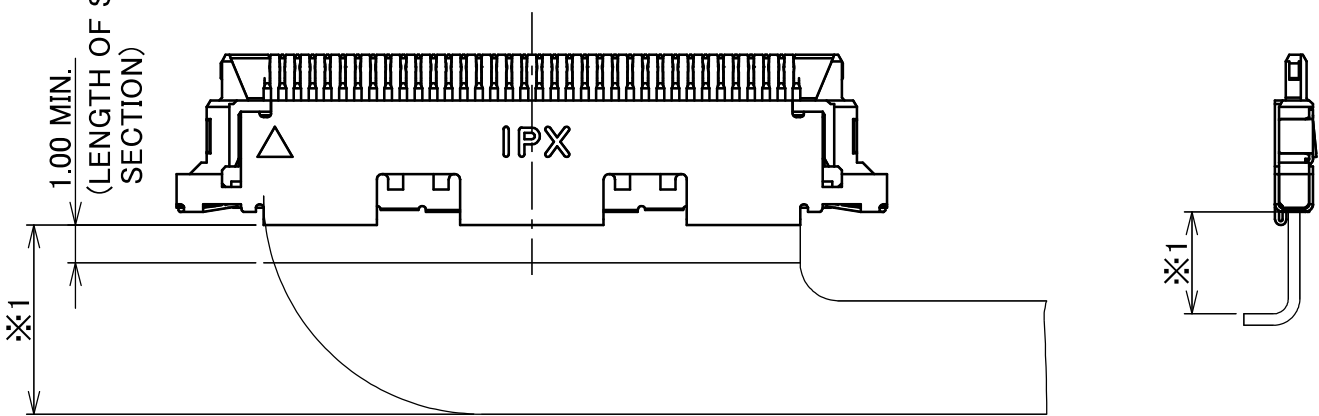

REFERENCE CABLE BENDING DIMENSIONS

※1 : THE BEND DIMENSIONS MAY VARY BASED ON THE SIZE AND QUANTITY OF CABLES. PLEASE CONFIRM THE MINIMUM BENDING RADIUS WITH I-PEX OR THE HARNESS MANUFACTURER.

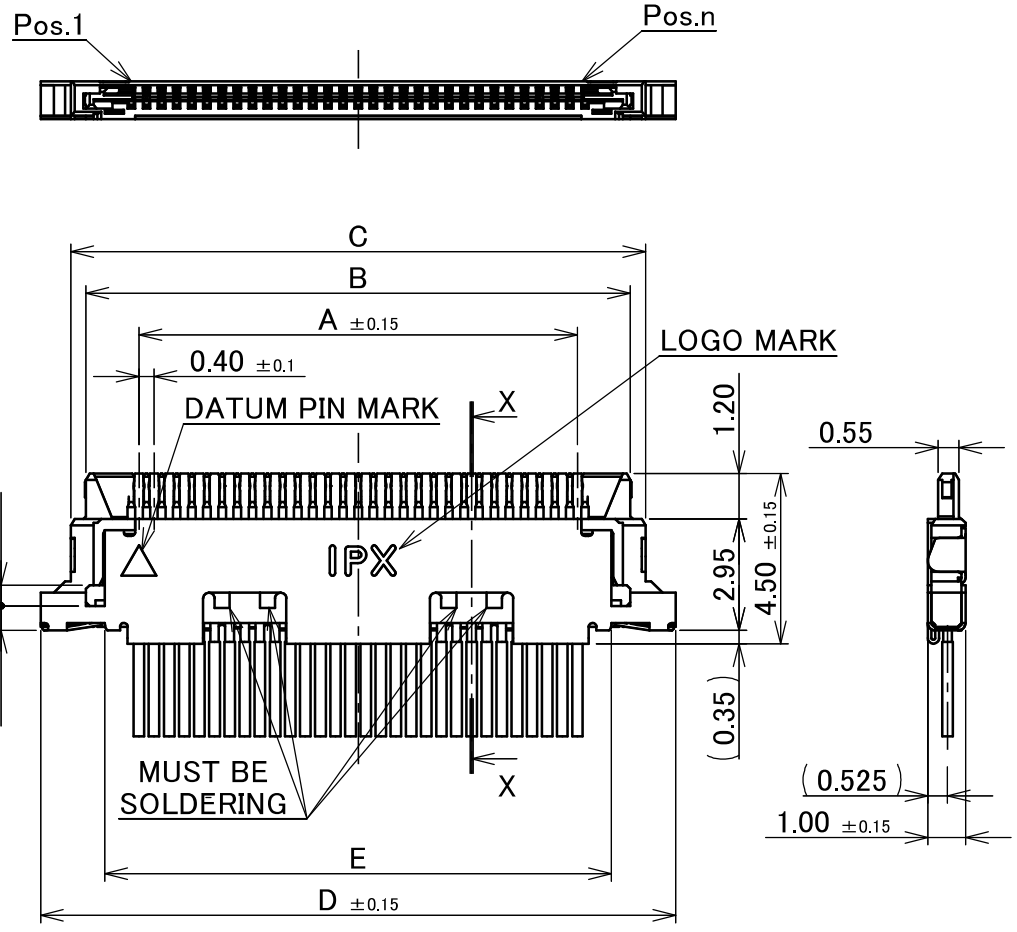

NO.	DISCRIPTION	MATERIAL	FINISH , REMARKS
4	SHELL B	PHOSPHOR BRONZE	Sn 1.00 μ m MIN. OVER Ni 1.00 μ m MIN.
3	SHELL A	SUS	Sn 1.00 μ m MIN. OVER Ni 0.50 μ m MIN.
2	CONTACT	BRASS	ALL OVER : Ni 1.00 μ m MIN. UNDER PLATING CONTACT AREA : Au 0.10 μ m MIN. SOLDERING AREA : Au 0.03 μ m MIN.
1	HOUSING	LCP	UL94V-0, BRACK

REV.	ECN	BY	DATE	APP.	APP.	DATE	DWG. No.	20345	SIZE	SHEET	REV.				
30	Z250427	RYO	Mar./13/'25	H.I	ANGLE	±2°	6 OVER 30 MAX.	±0.3	PROJECTION SERIES No. R10R4	CUSTOMER COPY	SCALE 5:1				
29	Z241434	T.T	Oct./17/'24	H.I	6 MAX.	±0.2	30 OVER 120 MAX.	±0.5							
28	Z240028	RYO	Jan./10/'24	H.I	GENERAL TOLERANCE.										
27	Z210585	A.K	June/07/'21	H.I	DWG.	H.Mashima	DATE	2003/03/07	TITLE CABLINE® V PLUG FOR CABLE ASSEMBLY	UNIT mm	I-PEX				
26	Z181369	K.H	Oct./19/'18	H.I	CHK.	Y.H	DATE	2003/03/12							
25	Z181269	K.H	Sept./28/'18	H.I	APP.	K.K	DATE	2003/03/13							
REVISION RECORD								DWG. No.	20345	SIZE	A3	SHEET	1/3	REV.	30

ITEMS	SPECIFICATION
APPLICABLE CABLE	MICRO-COAXIAL CABLE : AWG# 44,42,40 DISCRETE WIRE : AWG# 36 TWINAX CABLE : AWG# 40
RATING VOLTAGE	100V AC (PER CONTACT PIN) ※THIS IS THE RATED VOLTAGE OF THE CONNECTOR. PLEASE NOTE THAT THE RATED VOLTAGE MAY VARY IN THE HARNESS DEPENDING ON THE CABLES USED.
RATING AMPERAGE (FOR CONTACT)	0.1A AC/DC [AWG#44] (PER CONTACT PIN / UP TO 40 CONTACTS) 0.24A AC/DC [AWG#42] (PER CONTACT PIN / UP TO 40 CONTACTS) 0.3A AC/DC [AWG#40] (PER CONTACT PIN / UP TO 40 CONTACTS) 0.8A AC/DC [AWG#36] (PER CONTACT PIN / UP TO 12 CONTACTS) ※TESTING BY A REAL MACHINE IS RECOMMENDED BECAUSE TEMPERATURE RISE MAY AFFECTED BY ACTUAL SITUATION.
OPERATING TEMPERATURE	233~358K(-40°C~+85°C)
OPERATING HUMIDITY	85% MAX.(NON-CONDENSING)
CONTACT RESISTANCE	INITIAL : 235mohm MAX.(AWG#36) / AFTER TEST : \triangle 40mohm MAX. 560mohm MAX.(AWG#40) 650mohm MAX.(AWG#42) 1040mohm MAX.(AWG#44)
GROUND SHELL RESISTANCE	INITIAL : 50mohm MAX. / AFTER TEST : \triangle 40mohm MAX.
INSULATION RESISTANCE	INITIAL : 1000Mohm MIN. / AFTER TEST : 500Mohm MIN.
DIELECTRIC WITHSTANDING VOLTAGE	AC250V 1min
DURABILITY	30 CYCLES
MATING FORCE (INITIAL / AFTER TEST)	10P : 20.0N MAX. 15P : 22.5N MAX. 20P : 25.0N MAX. 25P : 27.5N MAX. 30P : 30.0N MAX. 35P : 32.5N MAX. 40P : 35.0N MAX.
UNMATING FORCE (INITIAL / AFTER TEST)	10P : 4.0N MIN. 15P : 5.0N MIN. 20P : 5.5N MIN. 25P : 6.0N MIN. 30P : 7.0N MIN. 35P : 8.0N MIN. 40P : 8.5N MIN.
CABLE RETENTION FORCE	10P : 4.90N MIN. 15P : 7.35N MIN. 20P : 9.80N MIN. 25P : 12.25N MIN. 30P : 14.70N MIN. 35P : 17.15N MIN. 40P : 19.60N MIN.
PRODUCT SPECIFICATION	P/N : 20345-0**T-32R *** PRS-1461
TEST REPORT	P/N : 20345-0**T-32R *** TR-08068
INSTRUCTION MANUAL	HIM-03005
ASSEMBLY MANUAL	ASM-03002
APPEARANCE CRITERIA NO.	QLS-A***

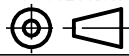
ANGLE	$\pm 2^\circ$	6 OVER 30 MAX.	± 0.3	PROJECTION 	SERIES No. R10R4	CUSTOMER COPY		
	6 MAX.	± 0.2	30 OVER 120 MAX.					
GENERAL TOLERANCE.				TITLE CABLIN [®] V PLUG FOR CABLE ASSEMBLY	SCALE	I-PEX		
DWG.	DATE				-			
CHK.					UNIT			
APP.					mm			
				DWG. No.	20345	SIZE	SHEET	REV.
						A3	2/3	30

PART NO.	POS.	A	F
20345-010T-32R	10	3.6	4.6
20345-015T-32R	15	5.6	6.6
20345-020T-32R	20	7.6	8.6
20345-025T-32R	25	9.6	10.6
20345-030T-32R	30	11.6	12.6
20345-035T-32R	35	13.6	14.6
20345-040T-32R	40	15.6	16.6

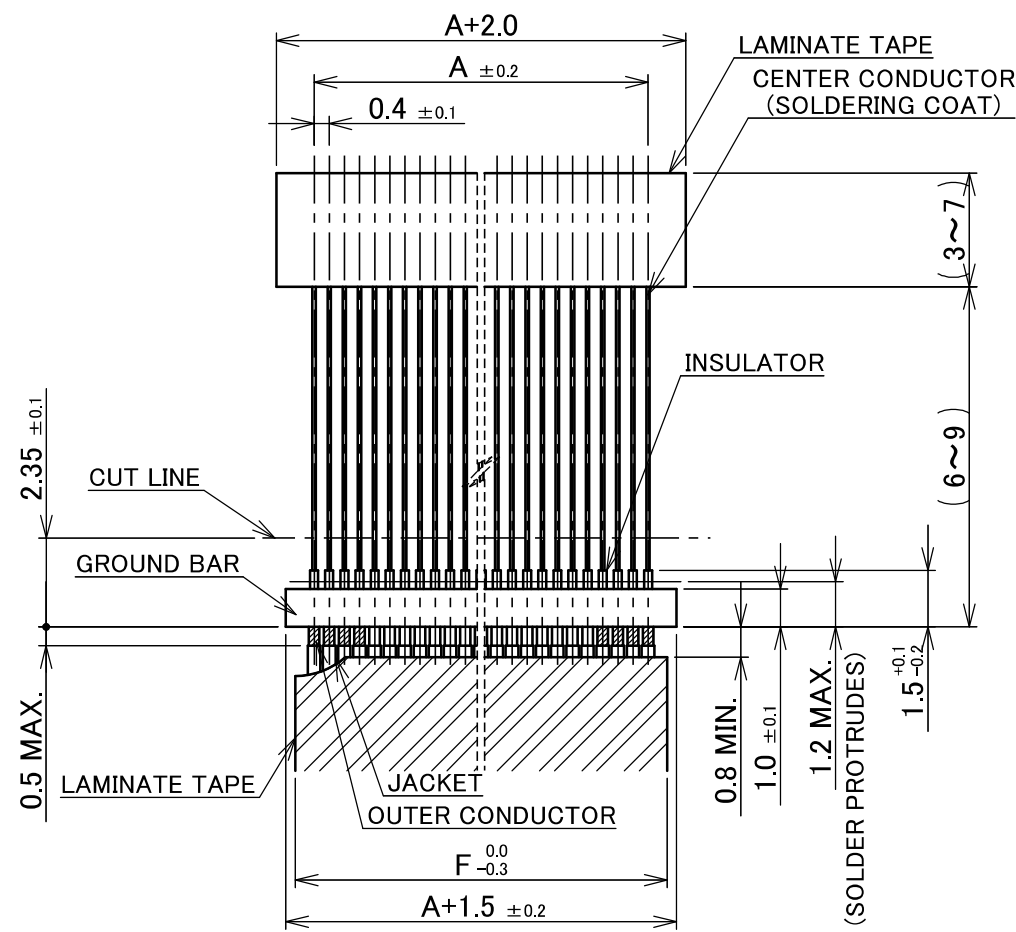

RECOMMENDED MICRO-COAXIAL CABLE CABLE

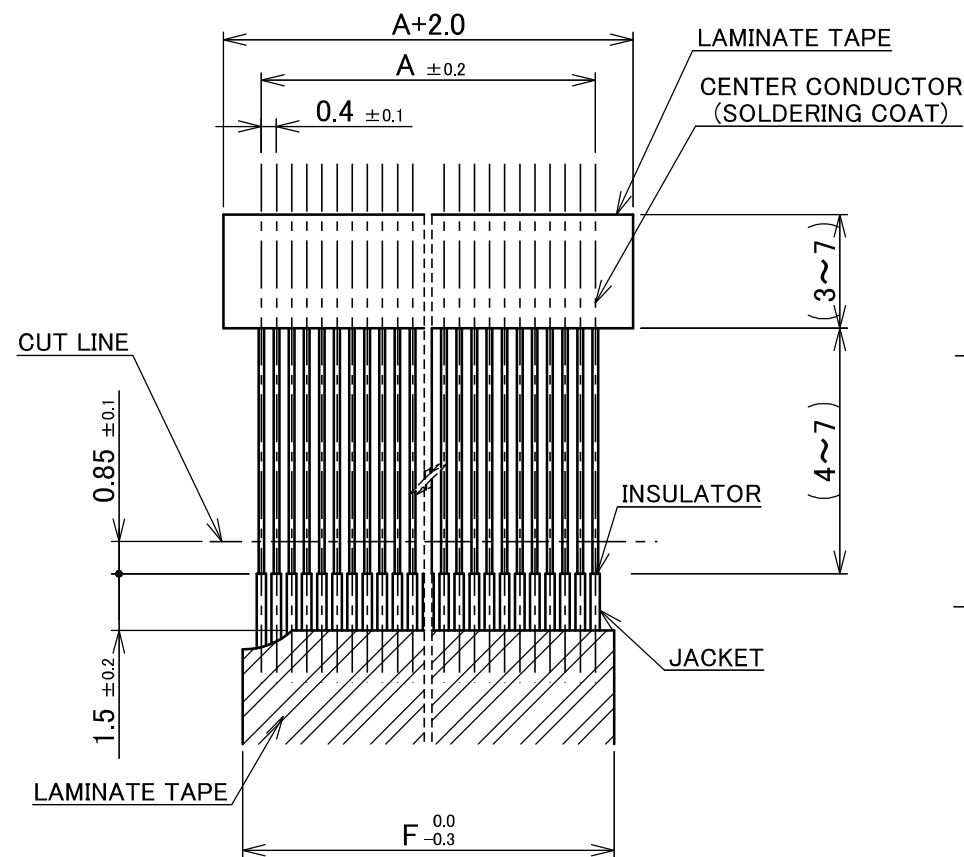

RECOMMENDED DISCRETE WIRE (AWG#36)

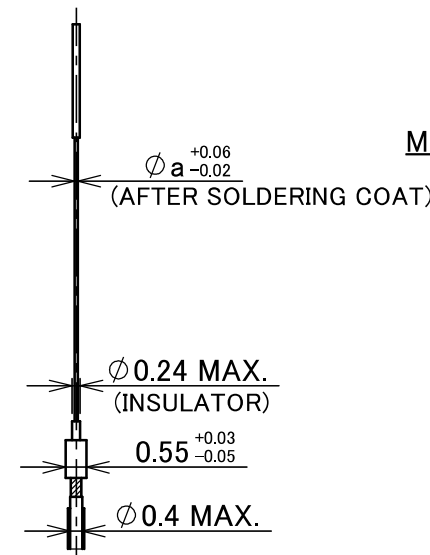

MICRO-COAXIAL CABLE DIMENSION

	a
#40	0.09
#42	0.075
#44	0.063

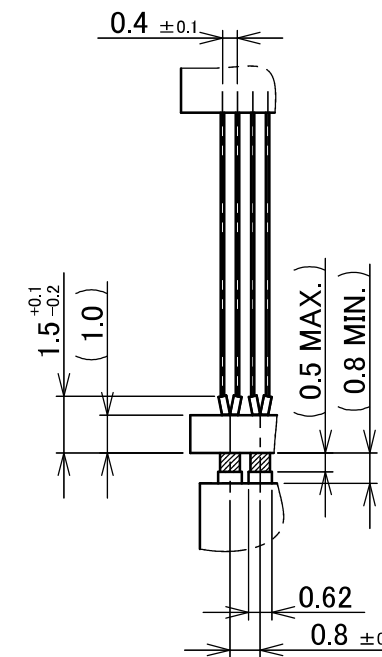

RECOMMENDED TWINAX CABLE DIM. (AWG#40)

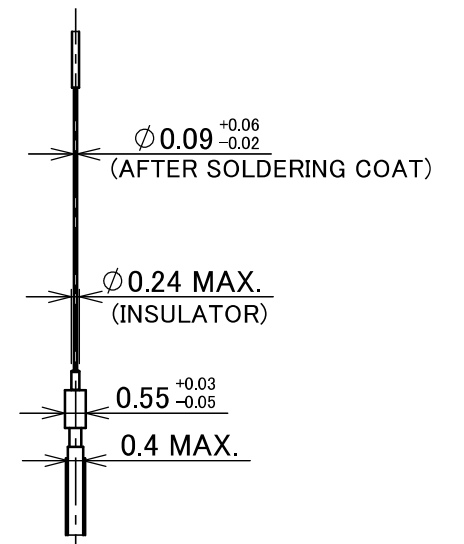

ANGLE	±2°	6 OVER 30 MAX.	±0.3	PROJECTION ⊕ ▽	SERIES No. R10R4	CUSTOMER COPY		
	6 MAX.	±0.2	30 OVER 120 MAX.					±0.5
GENERAL TOLERANCE.				TITLE CABLIN [®] V PLUG FOR CABLE ASSEMBLY	SCALE 5:1	UNIT I-PEX		
DWG.	DATE							
CHK.								
APP.								
				DWG. No.	20345	SIZE A3	SHEET 3/3	REV. 30