

Recommended P/N 3488-0\*\*1

PART No.	Pos.	A	B	C	D	E
3488-0301	30	16.20	13.88	4.00	13.65	9.36
3488-0401	40	20.20	17.88	8.00	17.65	13.36

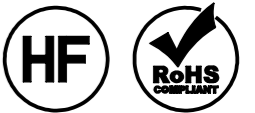

**PATENT PENDING**

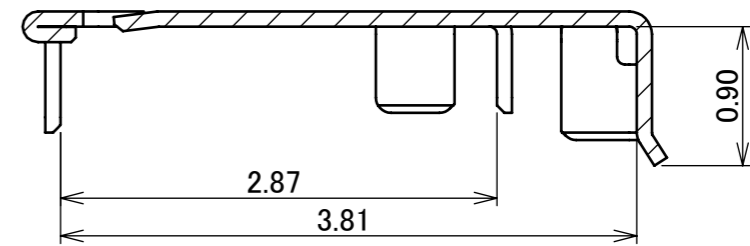
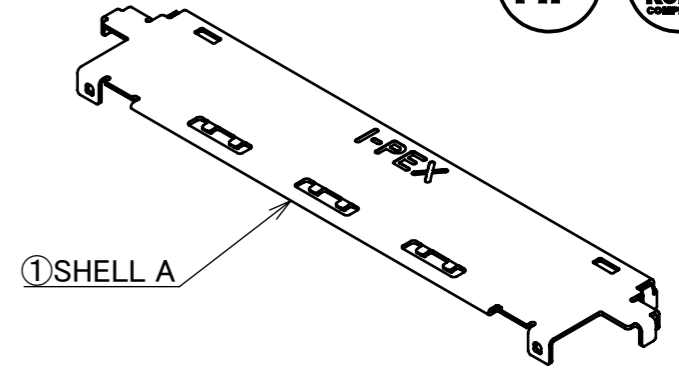
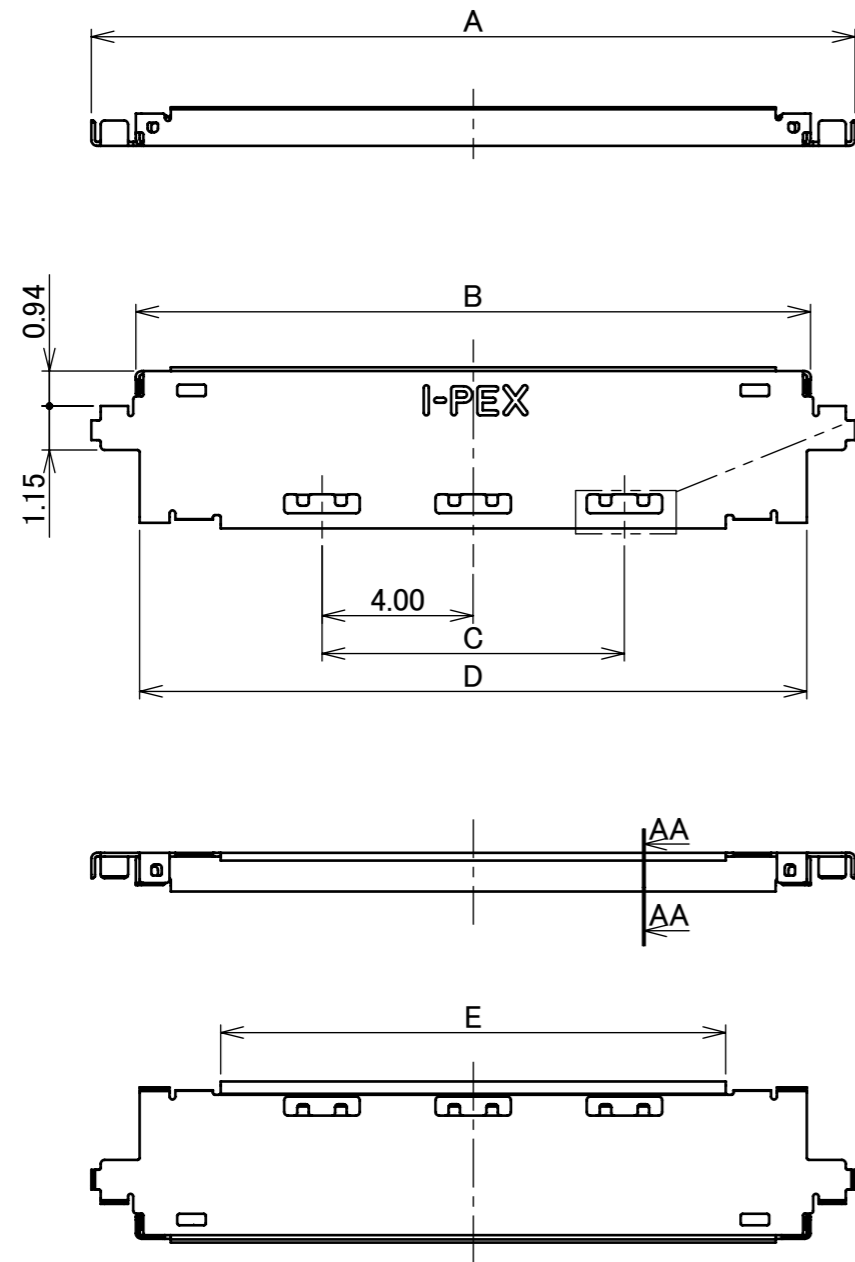

SECT.AA-AA  
(S=20/1)

NO.	DISCRIPTION	MATERIAL	FINISH , REMARKS
1	SHELL A	PHOSPHOR BRONZE	PARTIAL Au 0.003 μ m MIN. OVER Ni 1.00 μ m MIN.

REV.	ECN	BY	DATE	APP.	APP.	DATE	DWG. No.	SIZE	SHEET	REV.
1	Z200040	T.M	Jan./14/'20	H.I	T.Masunaga	2019/01/10	3488	A3	1/2	1
0	Z190029	T.M	Jan./10/'19							
REVISION RECORD					H.Ikari	2019/01/11				

PART No.	Pos.	F	G	QTY. PER EMBOSS REEL (PIECES / REEL)	QTY. PER PACKING CARTON (REELS / CARTON)	PACKING STANDARD
3488-0301	30	40.00	37.00	5000 / REEL	3 / CARTON = 15000	PST-18045
3488-0401	40	40.00	37.00			

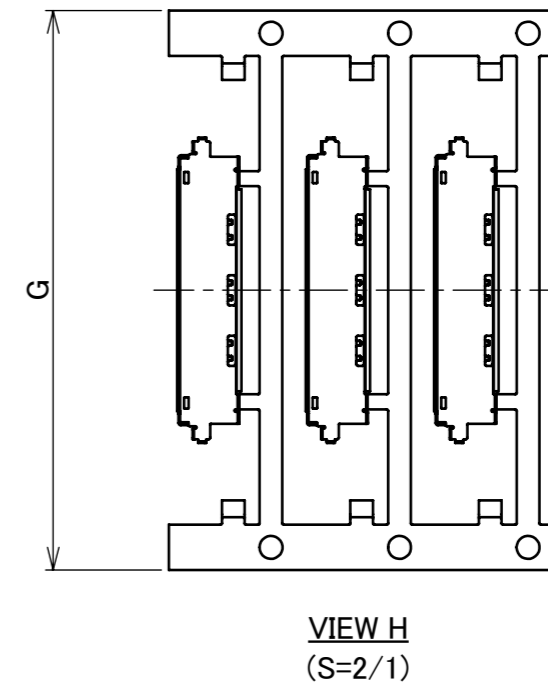
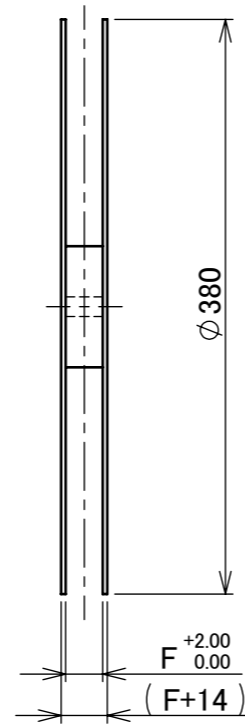
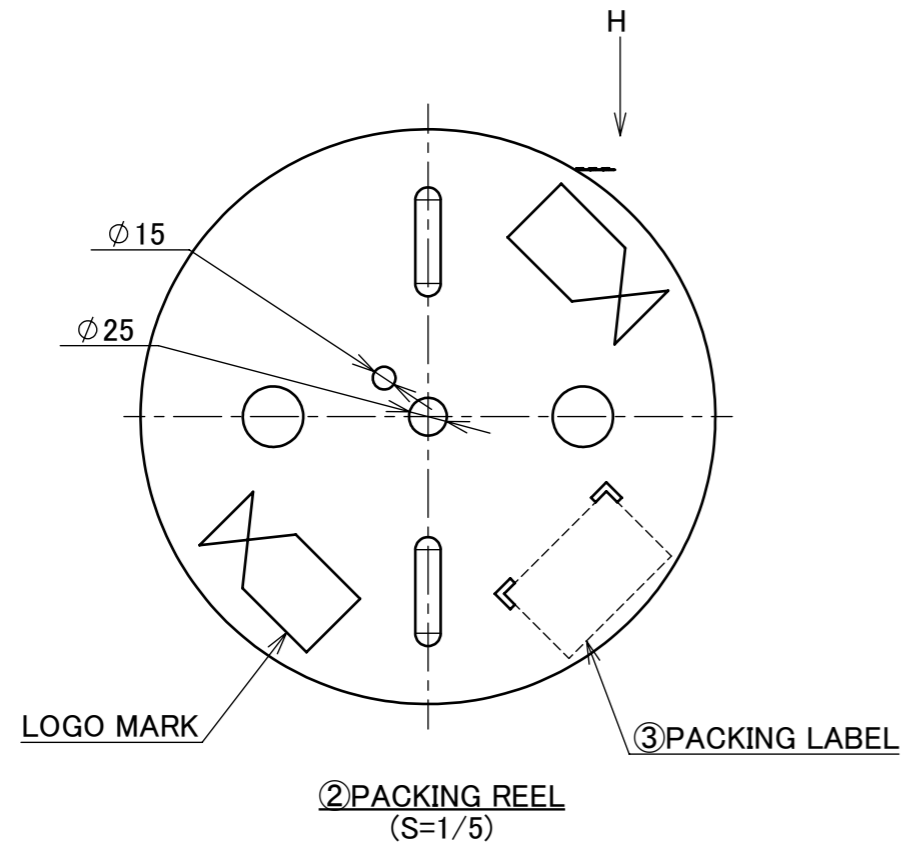

NO.	DISCRIPTION	MATERIAL	FINISH , REMARKS
3	PACKING LABEL	-	-
2	PACKING REEL	CARDBOARD	-

ANGLE	$\pm 2^\circ$	6 OVER 30 MAX.	$\pm 0.3$	PROJECTION 	SERIES No. R2	CUSTOMER COPY	
6 MAX.	$\pm 0.2$	30 OVER 120 MAX.	$\pm 0.5$			TITLE CABLIN <sup>®</sup> -UM PLUG SHELL A	SCALE 5:1
GENERAL TOLERANCE.				DWG. No. 3488	SIZE A3	SHEET 2/2	REV. 1
DWG.	DATE						
CHK.	DATE						
APP.	DATE						