

Recommended P/N

20790-060E-02

PART NO.	Pos.
20790-060E-##	60

P/N : 20790-0\*\*E-##



Halogen Free RoHS Compliant

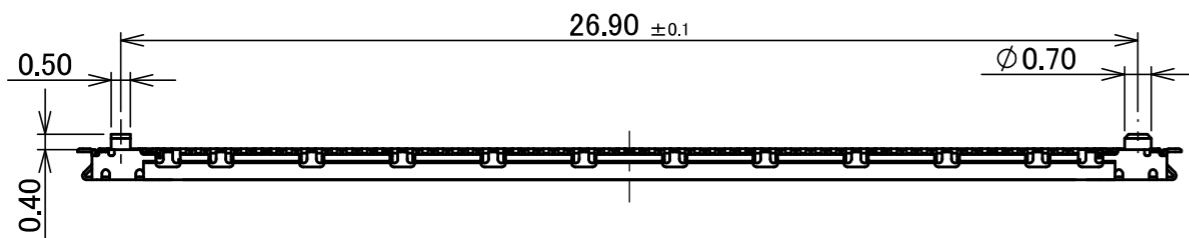
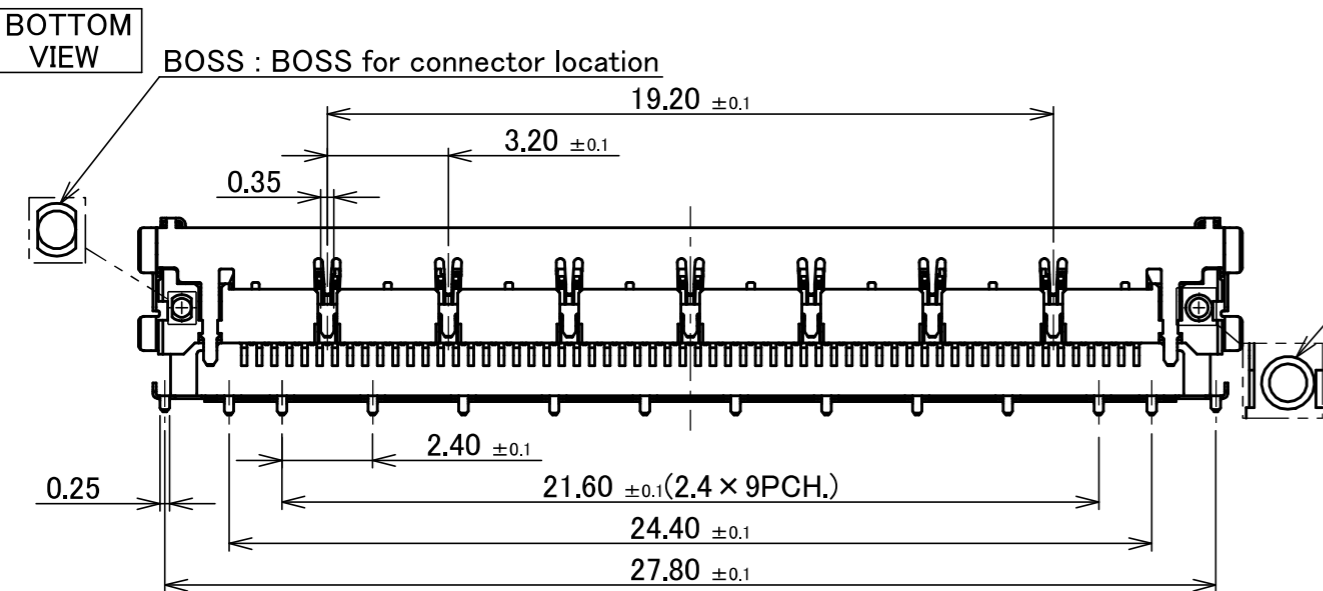
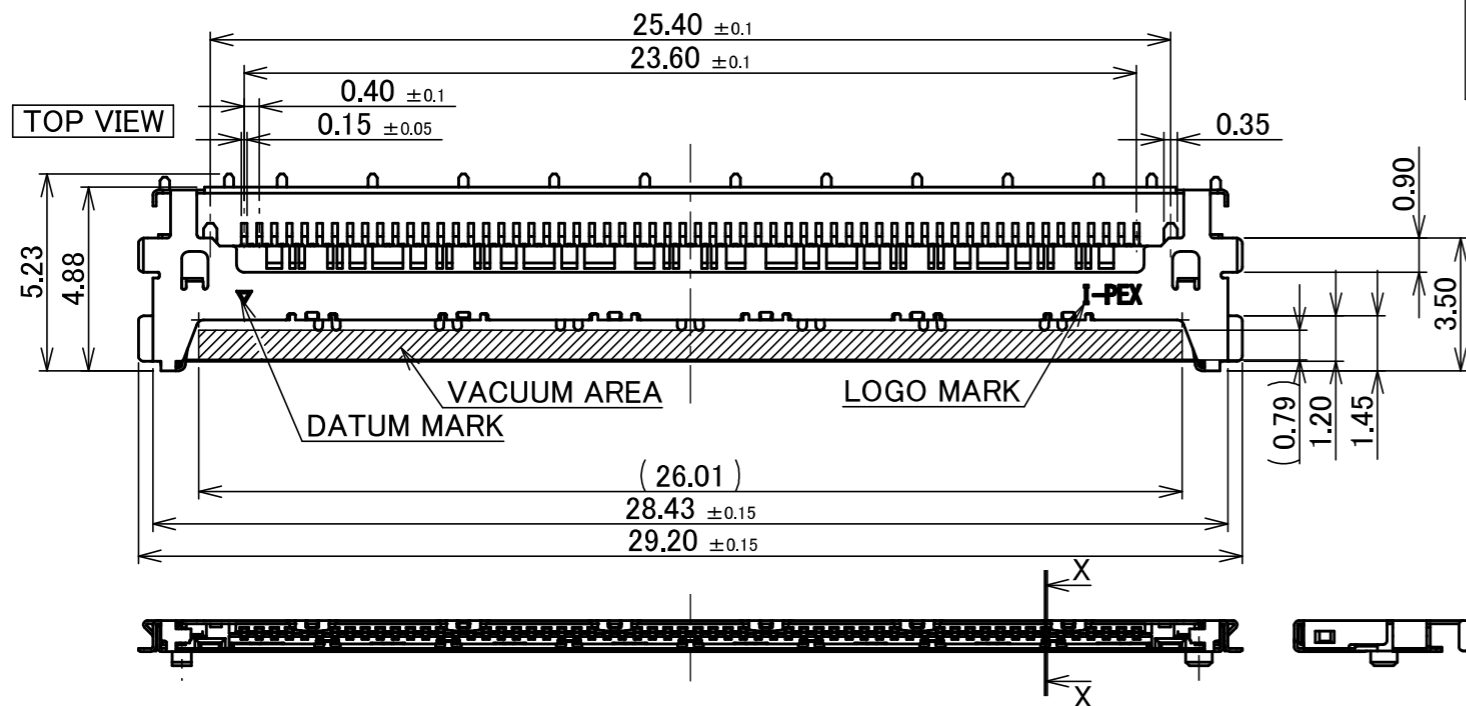

- 1 : WITH BOSS
  - 2 : WITHOUT BOSS
- SEE TABLE 1

Pos. 135° MAX.

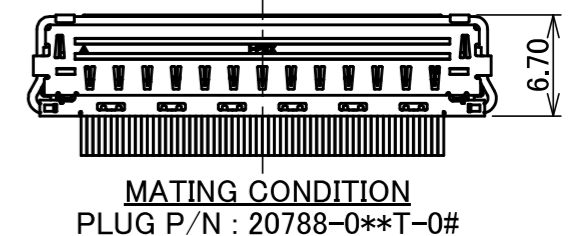
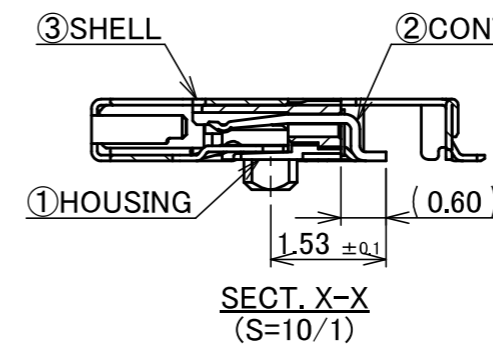
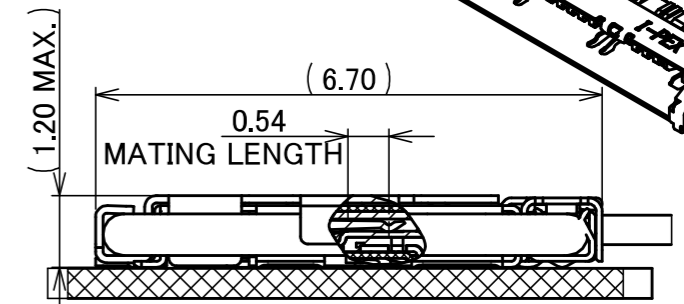
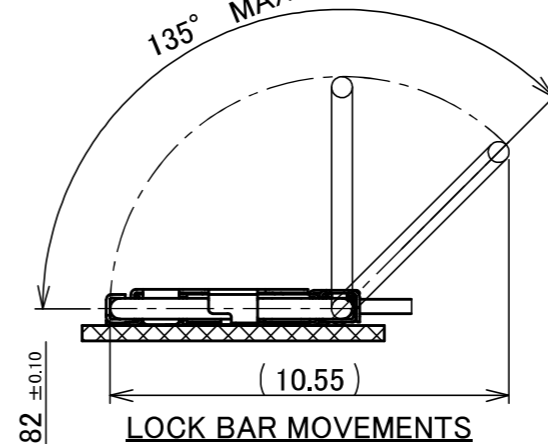

TABLE 1

PART NO.	CONTACT FINISH
20790-0**E-0#	CONTACT & SOLDERING AREA : Au 0.03 μ m MIN. OVER Ni 1.00 μ m MIN.
20790-0**E-1#	CONTACT AREA : Au 0.38 μ m MIN. OVER Ni 1.00 μ m MIN. SOLDERING AREA : Au 0.03 μ m MIN. OVER Ni 1.00 μ m MIN.

NO.	DISCRIPTION	MATERIAL	FINISH , REMARKS
3	SHELL	PHOSPHOR BRONZE	ALL OVER Ni 1.00 μ m MIN. SOLDERING AREA : Au 0.03 μ m MIN.
2	CONTACT	PHOSPHOR BRONZE	SEE TABLE 1
1	HOUSING	LCP	UL94V-0 ,BLACK

REV.	ECN	BY	DATE	APP.	PROJECTION	SERIES No.	TITLE	SCALE	CUSTOMER COPY	
16	Z250091	K.Hara	Jan./24/'25	H.I	ANGLE ±2°	6 OVER 30 MAX.	±0.3	5:1	I-PEX	
15	Z241786	K.Hara	Dec./13/'24	H.I	6 MAX. ±0.2	30 OVER 120 MAX.	±0.5	UNIT		
14	Z241307	K.Hara	Sept./24/'24	H.I	GENERAL TOLERANCE.			mm		
13	Z240025	K.Hara	Jan./12/'24	H.I	DWG. T.Masunaga	DATE 2016/11/14		SIZE		
12	Z230042	K.B	Jan./13/'23	H.I	CHK. T.Kurachi	DATE 2016/11/14		SHEET		
11	Z220151	K.Hara	Feb./14/'22	H.I	APP. J.Tateishi	DATE 2016/11/14		REV.		
REVISION RECORD					DWG. No.	20790		A3	1/6	16

**PATENT REGISTERED**

FOR CABLINE-CA II PLUS PLUG CABLE ASSEMBLY (DWG. NO. 20788)

ITEMS	SPECIFICATION
APPLICABLE CABLE	MICRO-COAXIAL CABLE : AWG# 44 , 42 , 40 , 38 , 36 DISCRETE WIRE : AWG# 36 , 34 TWINAX CABLE : AWG# 40 , 42
RATING VOLTAGE	100V AC (PER CONTACT PIN) ※THIS IS THE RATED VOLTAGE OF THE CONNECTOR. PLEASE NOTE THAT THE RATED VOLTAGE MAY VARY IN THE HARNESS DEPENDING ON THE CABLES USED.
RATING AMPERAGE (FOR CONTACT)	0.1A AC/DC [AWG#44] PER CONTACT PIN/UP TO 60 CONTACTS 0.24A AC/DC [AWG#42] PER CONTACT PIN/UP TO 60 CONTACTS 0.3A AC/DC [AWG#40] PER CONTACT PIN/UP TO 60 CONTACTS 0.5A AC/DC [AWG#38] PER CONTACT PIN/UP TO 18 CONTACTS 0.8A AC/DC [AWG#36] PER CONTACT PIN/UP TO 6 CONTACTS 1.0A AC/DC [AWG#34] PER CONTACT PIN/UP TO 6 CONTACTS ※TESTING BY REAL MACHINE IS RECOMMENDED BECAUSE TEMPERATURE RISE MAY AFFECTED BY ACTUAL SITUATION.
OPERATING TEMPERATURE	233~378K(-40°C~105°C)
OPERATING HUMIDITY	85% MAX.(NON-CONDENDING)
CONTACT RESISTANCE	INITIAL : 180mohm MAX.(AWG#34) / AFTER TEST : $\triangle$ 40mohm MAX. 275mohm MAX.(AWG#36) 360mohm MAX.(AWG#38) 600mohm MAX.(AWG#40) 700mohm MAX.(AWG#42) 1080mohm MAX.(AWG#44)
GROUND SHELL RESISTANCE	INITIAL : 50mohm MAX. / AFTER TEST : $\triangle$ 40mohm MAX.
INSULATION RESISTANCE	INITIAL : 1000Mohm MIN. / AFTER TEST : 500Mohm MIN.
DIELECTRIC WITHSTANDING VOLTAGE	AC250V 1min
DURABILITY	30 CYCLES
MATING FORCE (INITIAL / AFTER 30 CYCLES)	29.10N MAX.
UN-MATING FORCE (INITIAL / AFTER 30 CYCLES)	6.0N MIN.
CABLE RETENTION FORCE	29.40N MIN.
COPLANARITY	0.10 MAX.
PRODUCT SPECIFICATION	PRS-2261
TEST REPORT	TR-16075, TR-23031
INSTRUCTION MANUAL	HIM-16028
PACKING STANDARD	PST-16078
APPEARANCE CRITERIA NO.	QLS-A***

ANGLE	$\pm 2^\circ$	6 OVER 30 MAX.	$\pm 0.3$	PROJECTION 	SERIES No. R0	CUSTOMER COPY		
	6 MAX.	$\pm 0.2$	30 OVER 120 MAX.					
GENERAL TOLERANCE.				TITLE CABLINE®-CA II PLUS RECEPTACLE ASSEMBLY	SCALE 5:1 UNIT mm			
DWG.	DATE							
CHK.								
APP.								
				DWG. No.	20790	SIZE A3	SHEET 2/6	REV. 16

FOR CABLINE-CA IIF PLUS PLUG SHELL ASSEMBLY (DWG. NO. 20901)

ITEMS	SPECIFICATION
RATING VOLTAGE	100V AC (PER CONTACT PIN)
RATING AMPERAGE (FOR SIGNAL CONTACT)	0.3A AC/DC (PER CONTACT PIN) ※TESTING BY REAL MACHINE IS RECOMMENDED BECAUSE TEMPERATURE RISE MAY AFFECTED BY ACTUAL SITUATION.
OPERATING TEMPERATURE	233~358K(-40°C~+85°C)
OPERATING HUMIDITY	85% MAX.(NON-CONDENSING)
CONTACT RESISTANCE (FOR SIGNAL CONTACT)	INITIAL : 60mohm MAX. / AFTER TEST : $\triangleleft$ 40mohm MAX.
GROUND SHELL RESISTANCE	INITIAL : 60mohm MAX. / AFTER TEST : $\triangleleft$ 40mohm MAX.
INSULATION RESISTANCE	INITIAL : 1000Mohm MIN. / AFTER TEST : 500Mohm MIN.
DIELECTRIC WITHSTANDING VOLTAGE	AC250V 1min
DURABILITY	30 CYCLES
MATING FORCE (INITIAL / AFTER TEST)	27.0N MAX.
UNMATING FORCE (INITIAL / AFTER TEST)	2.88N MIN.
PRODUCT SPECIFICATION	PRS-2893
TEST REPORT	TR-24034
PACKING STANDARD	PST-24023
INSTRUCTION MANUAL	HIM-24010
ASSEMBLY MANUAL	ASM-24004
APPEARANCE CRITERIA No.	QLS-A***

ANGLE	$\pm 2^\circ$	6 OVER 30 MAX.	$\pm 0.3$	PROJECTION 	SERIES No. R0	CUSTOMER COPY		
	6 MAX.	$\pm 0.2$	30 OVER 120 MAX.			$\pm 0.5$	SCALE 5:1	<b>I-PEX</b>
GENERAL TOLERANCE.				TITLE CABLINE®-CA II PLUS RECEPTACLE ASSEMBLY	UNIT mm	SIZE A3	SHEET 3/6	
DWG.	DATE			DWG. No.	20790			
CHK.								
APP.								

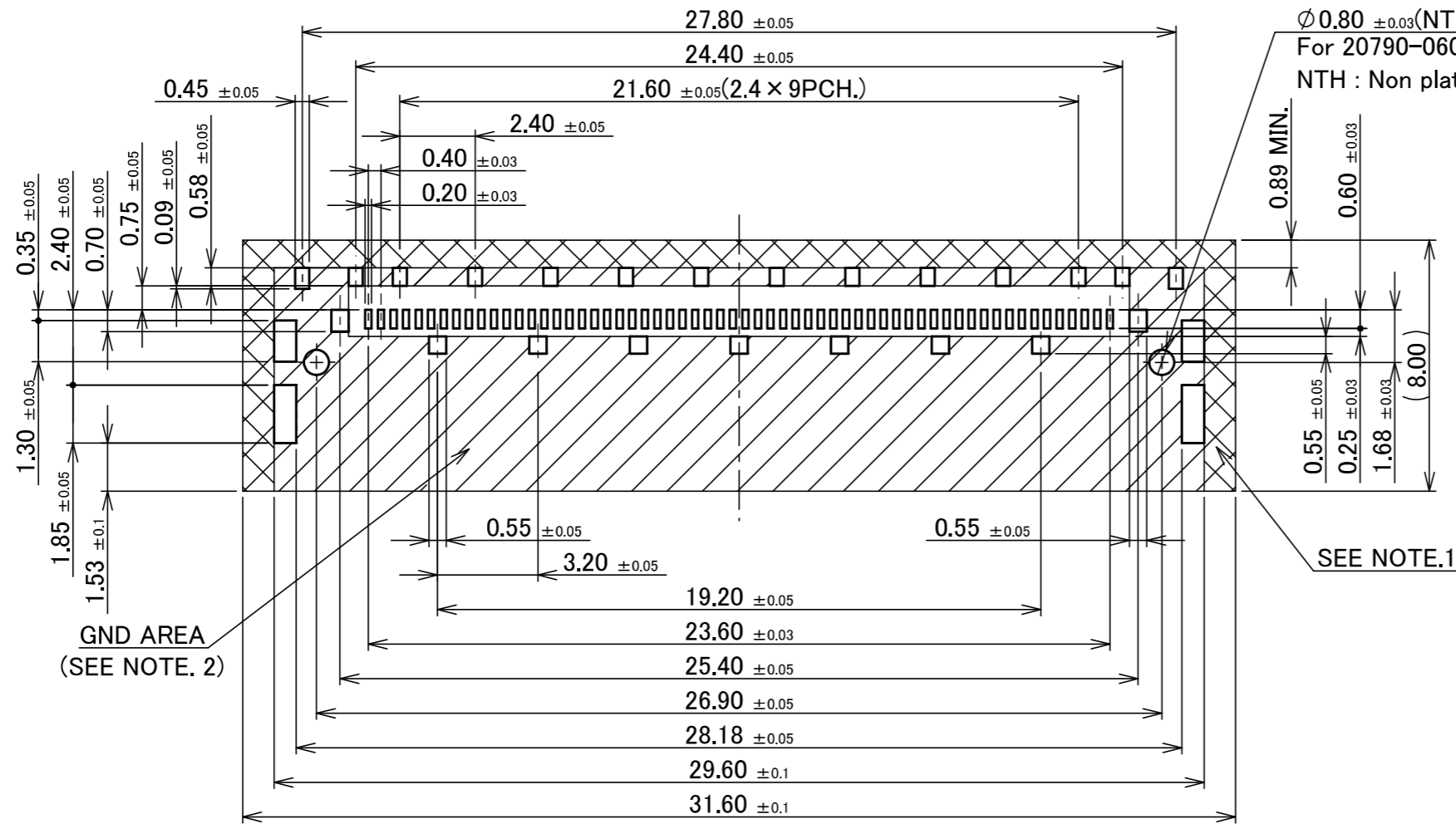

$\varnothing 0.80 \pm 0.03$  (NTH)  
 For 20790-060E-#1  
 NTH : Non plated Through Hole for BOSS inserts

GND AREA  
(SEE NOTE. 2)

SEE NOTE.1

**RECOMMENDED FOOTPRINT PATTERN LAYOUT**

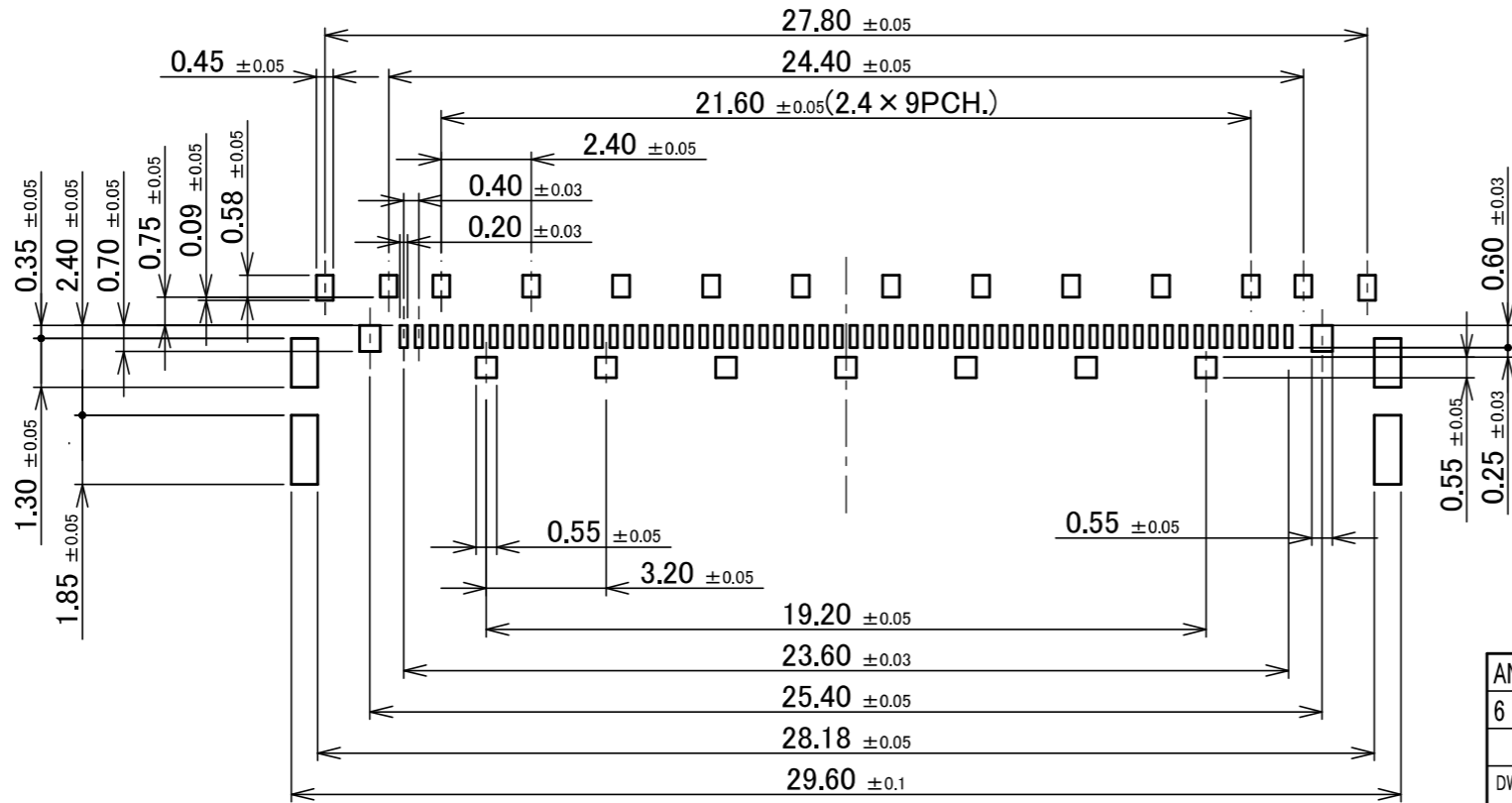

**RECOMMENDED METAL MASK LAYOUT**  
**METAL MASK THICKNESS : t=0.12mm**

NOTES.  
 1. DO NOT MOUNT ANOTHER COMPONENT IN THIS AREA.  
 2. SOLDER RESIST MUST BE APPLIED TO THIS AREA.

ANGLE	$\pm 2^\circ$	6 OVER 30 MAX.	$\pm 0.3$	PROJECTION	SERIES No.	CUSTOMER COPY	
	6 MAX.	$\pm 0.2$	30 OVER 120 MAX.	$\pm 0.5$	R0		
GENERAL TOLERANCE.				TITLE	SCALE		
DWG.	DATE			CABLIN <sup>®</sup> -CA II PLUS RECEPTACLE ASSEMBLY	5:1		
CHK.					UNIT		
APP.				DWG. No.	20790	SIZE	SHEET
						A3	4/6
							REV.
							16

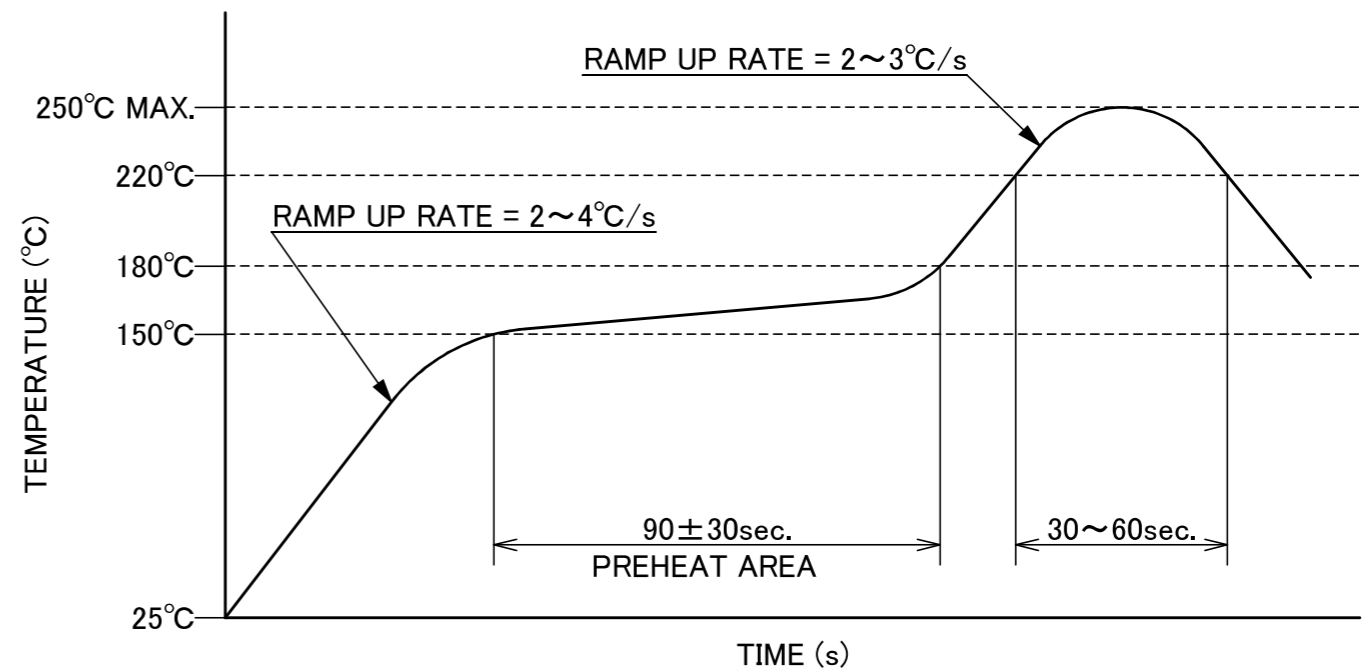
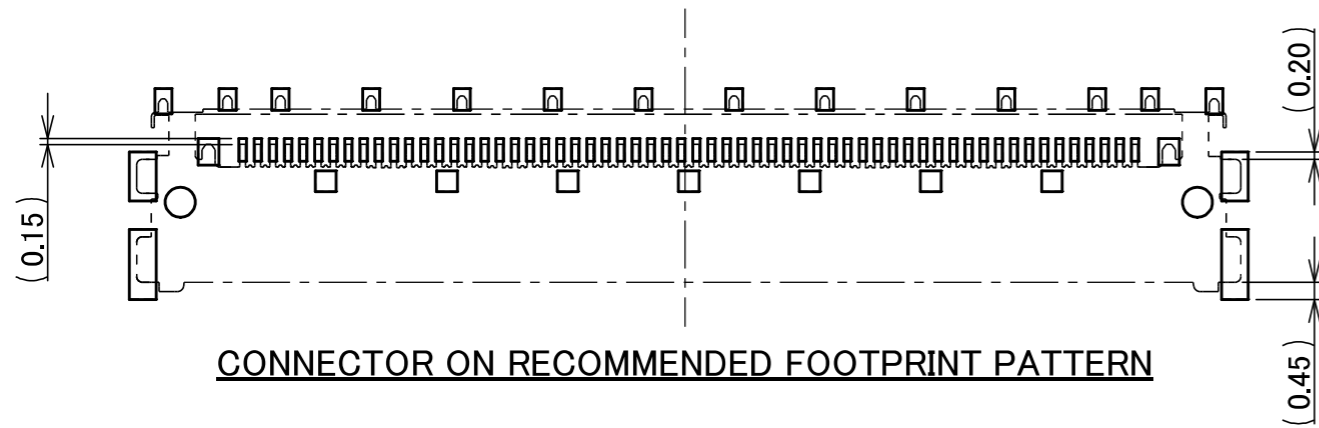

ANGLE	±2°	6 OVER 30 MAX.	±0.3	PROJECTION ⊕	SERIES No. R0	CUSTOMER COPY			
6 MAX.	±0.2	30 OVER 120 MAX.	±0.5						
GENERAL TOLERANCE.				TITLE		SCALE	<b>I-PEX</b>		
DWG.	DATE			CABLIN <sup>®</sup> -CA II PLUS RECEPTACLE ASSEMBLY		5:1			
CHK.						UNIT			
APP.						mm			
				DWG. No.	20790	SIZE	SHEET	REV.	
						A3	5/6	16	

PART NO.	QTY. PER EMBOSS REEL (PIECES / REEL)	QTY. PER PACKING CARTON (REELS / CARTON)
20790-060E-##	5500 / REEL	3 / CARTON = 16500

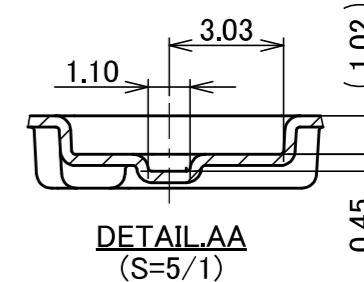
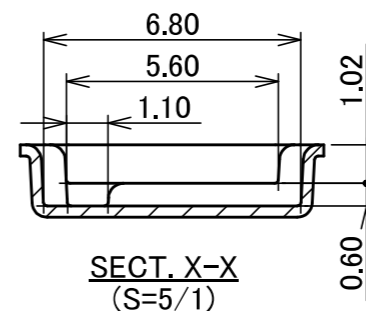
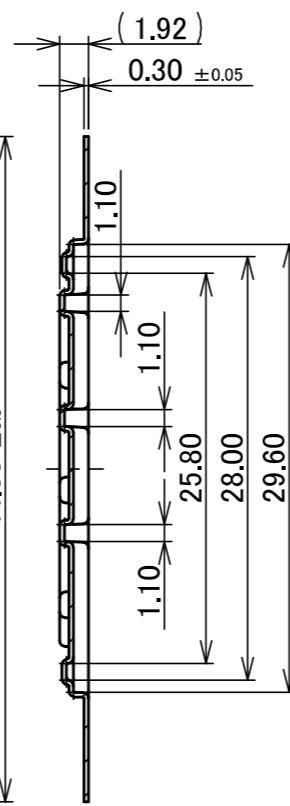
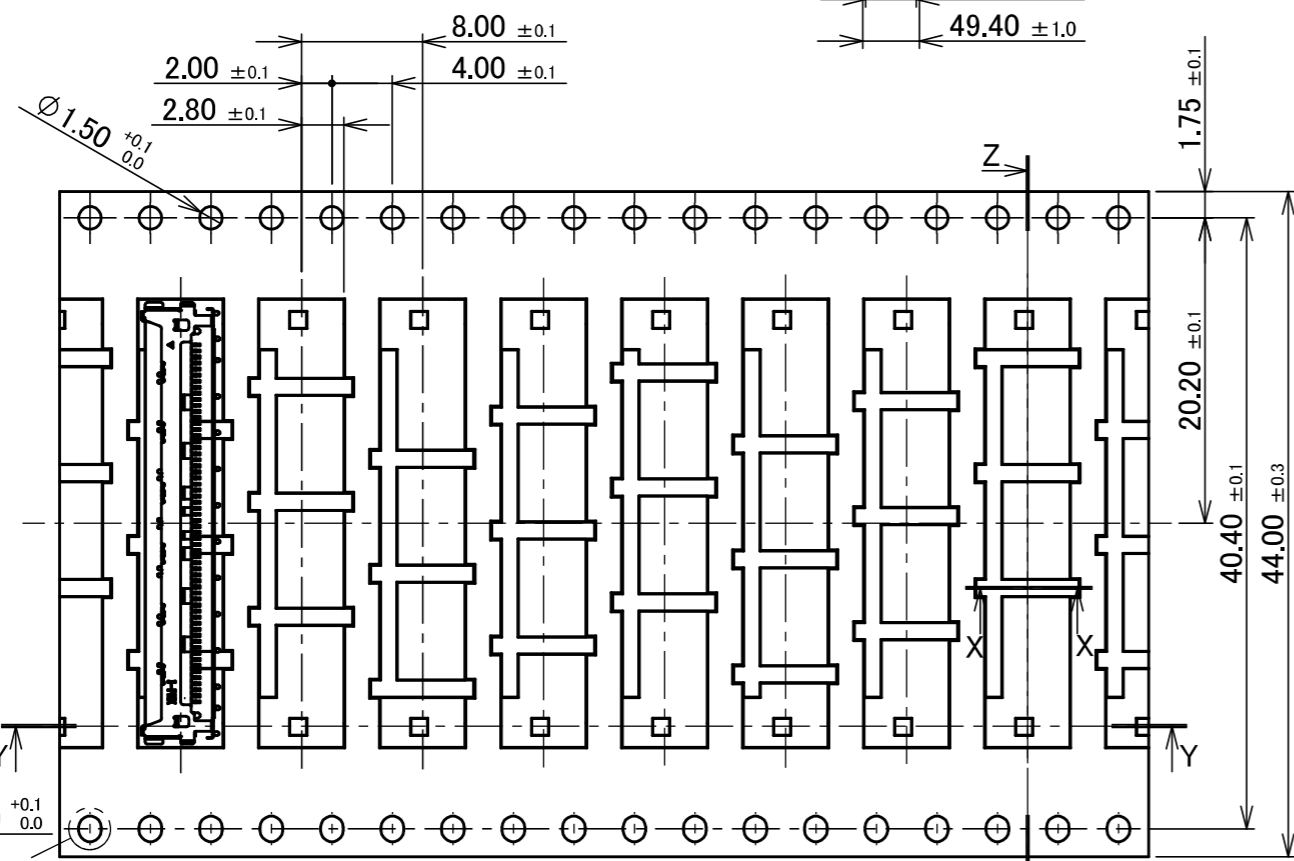
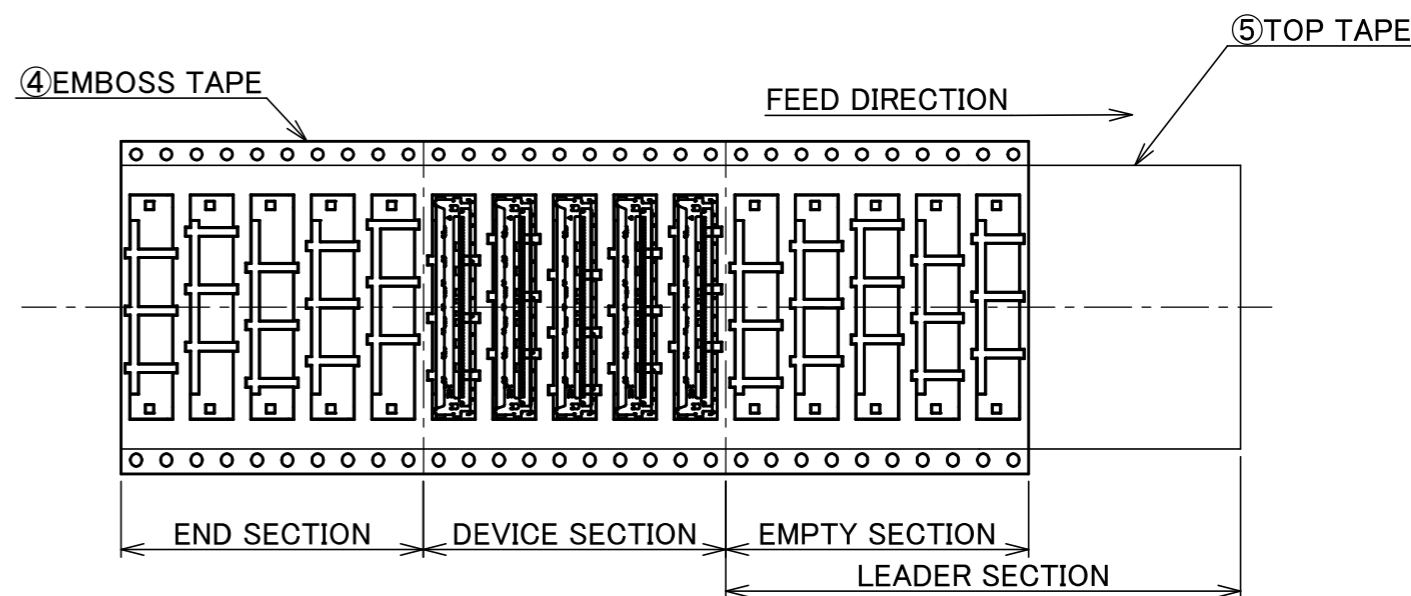
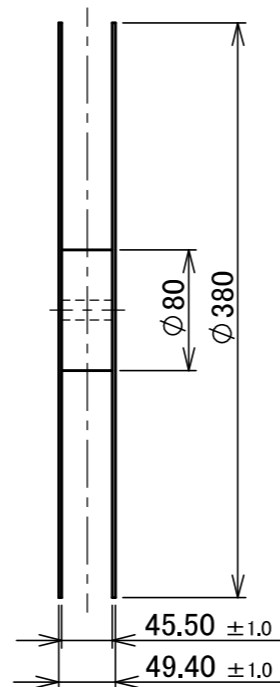
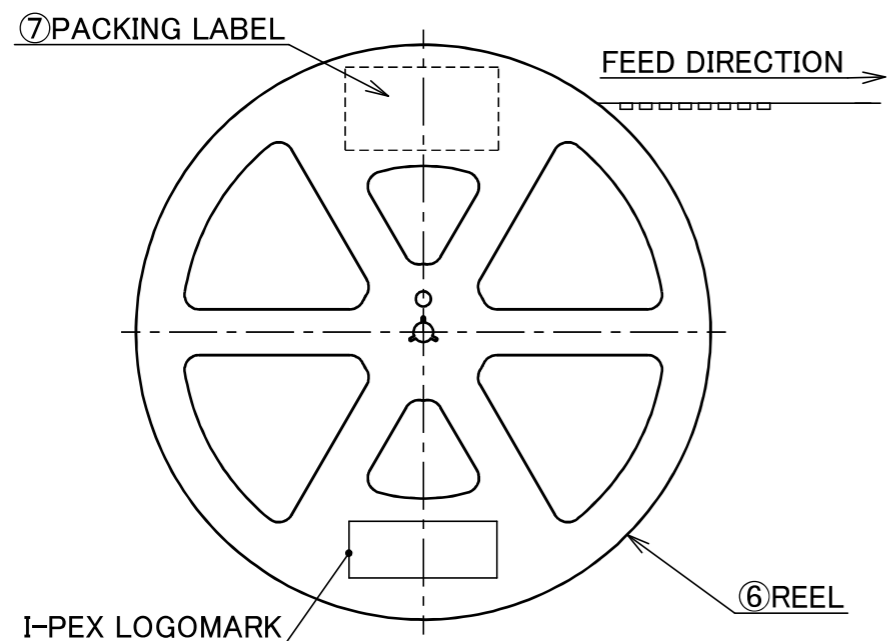

NOTES.

- TAPING SPECIFICATION FOLLOWS JIS C 0806 (IEC 60286-3).
- MAKE EMPTY SECTION OF LEADER AND END ON EACH END OF THE TAPE.
- TOP TAPE SHALL NOT STICK OUT FROM EMBOSS TAPE.
- TOP TAPE SHALL NOT COVER FEED HOLE.

NO.	DISCRIPTION	MATERIAL	FINISH , REMARKS
7	PACKING LABEL	-	-
6	REEL	PS	ANTI-STATIC TYPE BLACK
5	TOP TAPE	PET $t=0.062$ TRANSPARENCY	ANTI-STATIC TYPE
4	EMBOS TAPE	PS $t=0.3$ TRANSPARENCY	ANTI-STATIC TYPE

ANGLE	$\pm 2^\circ$	6 OVER 30 MAX.	$\pm 0.3$	PROJECTION	SERIES No.	CUSTOMER COPY
	6 MAX.	$\pm 0.2$	30 OVER 120 MAX.	$\pm 0.5$	R0	
GENERAL TOLERANCE.				TITLE	SCALE	I-PEX
DWG.	DATE			CABLIN <sup>®</sup> -CA II PLUS RECEPTACLE ASSEMBLY	2:1	
CHK.					UNIT	
APP.					mm	
				DWG. No.	20790	SIZE
						A3
						SHEET
						6/6
						REV.
						16