

Recommended P/N 20680-0**T-01

PART NO.	Pos.	A	B	C	D	E	F	G	H	J
20680-020T-01	20	9.10	8.65	8.30	7.60	8.40	10.66	13.40	-	5.00
20680-030T-01	30	13.10	12.65	12.30	11.60	12.40	14.66	17.40	4.00	8.00
20680-040T-01	40	17.10	16.65	16.30	15.60	16.40	18.66	21.40	8.00	12.00
20680-050T-01	50	21.10	20.65	20.30	19.60	20.40	22.66	25.40	12.00	16.00
20680-060T-01	60	25.10	24.65	24.30	23.60	24.40	26.66	29.40	16.00	20.00

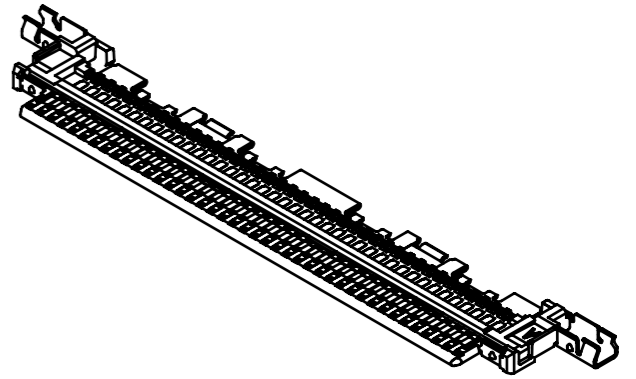

BOTTOM VIEW

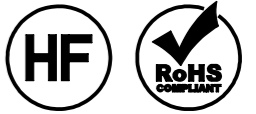
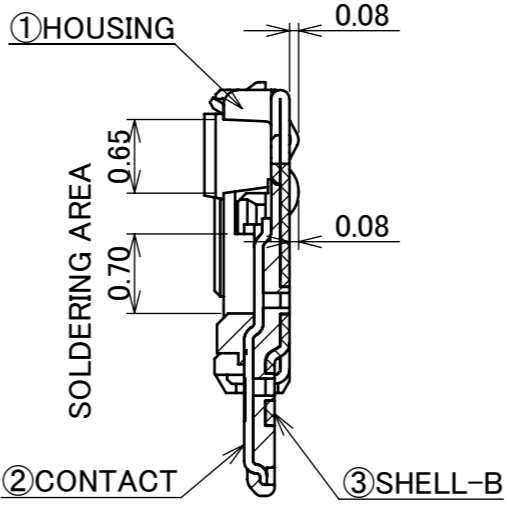
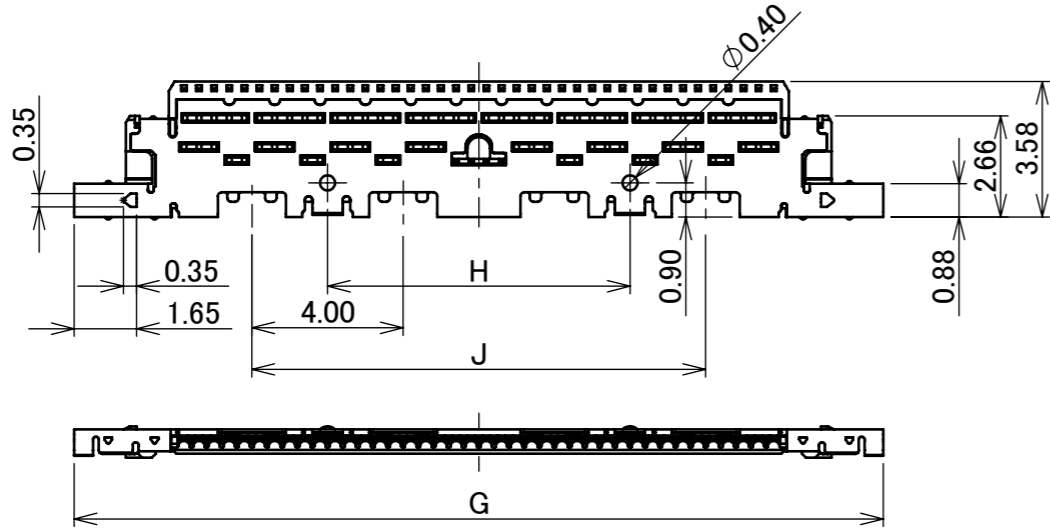

SECT. X-X (S=15/1)

TOP VIEW

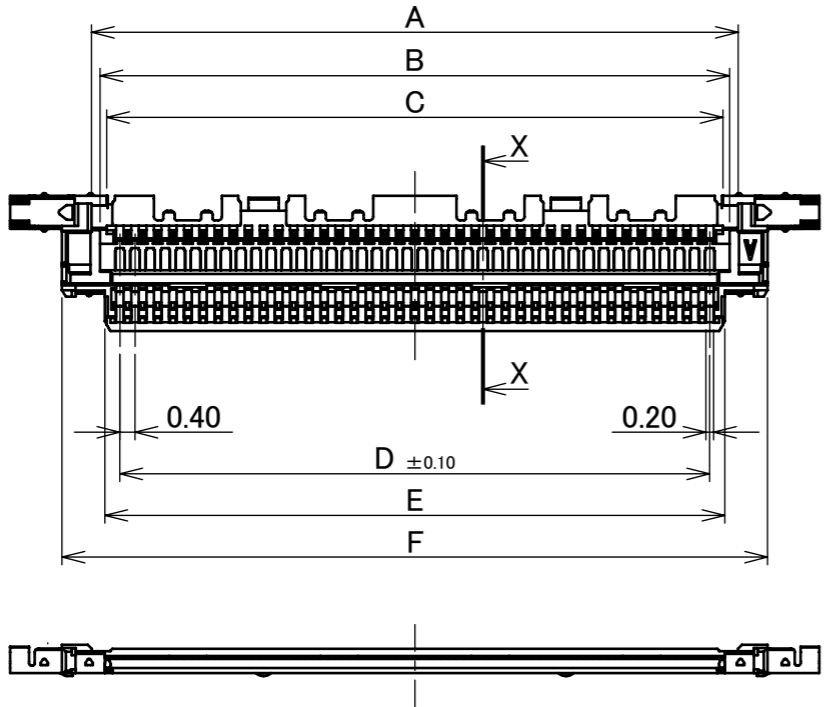

- NOTES.
1. THIS PART IS ASSEMBLED WITH SHELL A(P/N 3204-0**1) AND LOCK BAR ASS'Y(P/N 20681-0**T-01) AFTER SOLDERED THE CABLE, AND IT BECOMES P/N 20679-0**T-01
 2. THIS PART IS ASSEMBLED WITH SHELL A(P/N 3204-0**1) AND LOCK BAR ASS'Y(P/N 20789-0**T-01) AFTER SOLDERED THE CABLE, AND IT BECOMES P/N 20788-0**T-01

NO.	DISCRIPTION	MATERIAL	FINISH , REMARKS
3	SHELL-B	PHOSPHOR BRONZE	PARTIAL Au 0.003 μ m MIN. OVER Ni 1.00 μ m MIN.
2	CONTACT	PHOSPHOR BRONZE	ALL OVER Ni 1.00 μ m MIN. CONTACT & SOLDERING AREA : Au 0.03 μ m MIN.
1	HOUSING	LCP	UL94V-0 ,BLACK

REV.	ECN	BY	DATE	APP.	ANGLE	±2°	6 OVER 30 MAX.	±0.3	PROJECTION	SERIES No.	CUSTOMER COPY
7	Z191208	A.K	Sept./12/'19	H.I	6 MAX.	±0.2	30 OVER 120 MAX.	±0.5		R1	CUSTOMER COPY
6	Z180338	A.K	July/6/'18	H.I	GENERAL TOLERANCE.			TITLE CABLINE®-CA II CABLINE®-CA II PLUS PLUG HOUSING ASSY			
5	Z170732	T.M	June/27/'17	H.I	DWG.	DATE	T.Masunaga Mar./24/'15		5:1		
4	Z170200	T.M	Feb./27/'17	H.I	CHK.	DATE	J.Tateishi Mar./24/'15		UNIT		
3	Z161426	T.M	Nov./14/'16	J.T	APP.	DATE	E.Kawabe Mar./25/'15		mm		
REV.	ECN	BY	DATE	APP.	DWG. No.	20680	SIZE	A3	SHEET 1/3		REV. 7

PATENT REGISTERED

PART NO.	QTY. IN DITCH (PIECES / DITCH)	QTY. IN TRAY (PIECES / TRAY)	QTY. IN SHIPPING CARTON (TRAY / S CARTON)	QTY. IN PACKING CARTON (S CARTON / P CARTON)	PACKING STANDARD
20680-020T-01	1	100 / TRAY	20 / S CARTON = 2000	4 / P CARTON = 8000	PST-15025
20680-030T-01					
20680-040T-01					
20680-050T-01					

FOR 20,30,40,50P

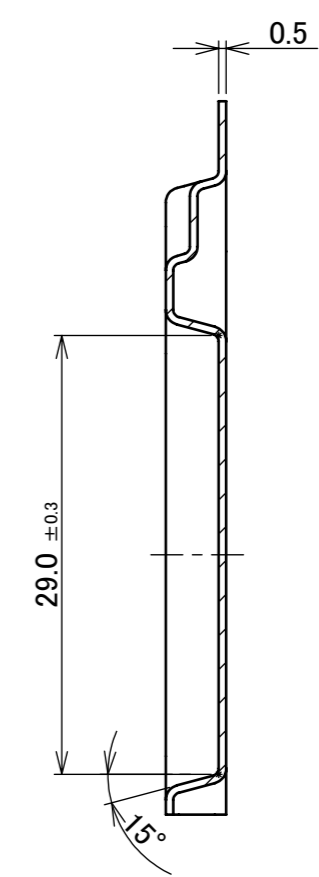
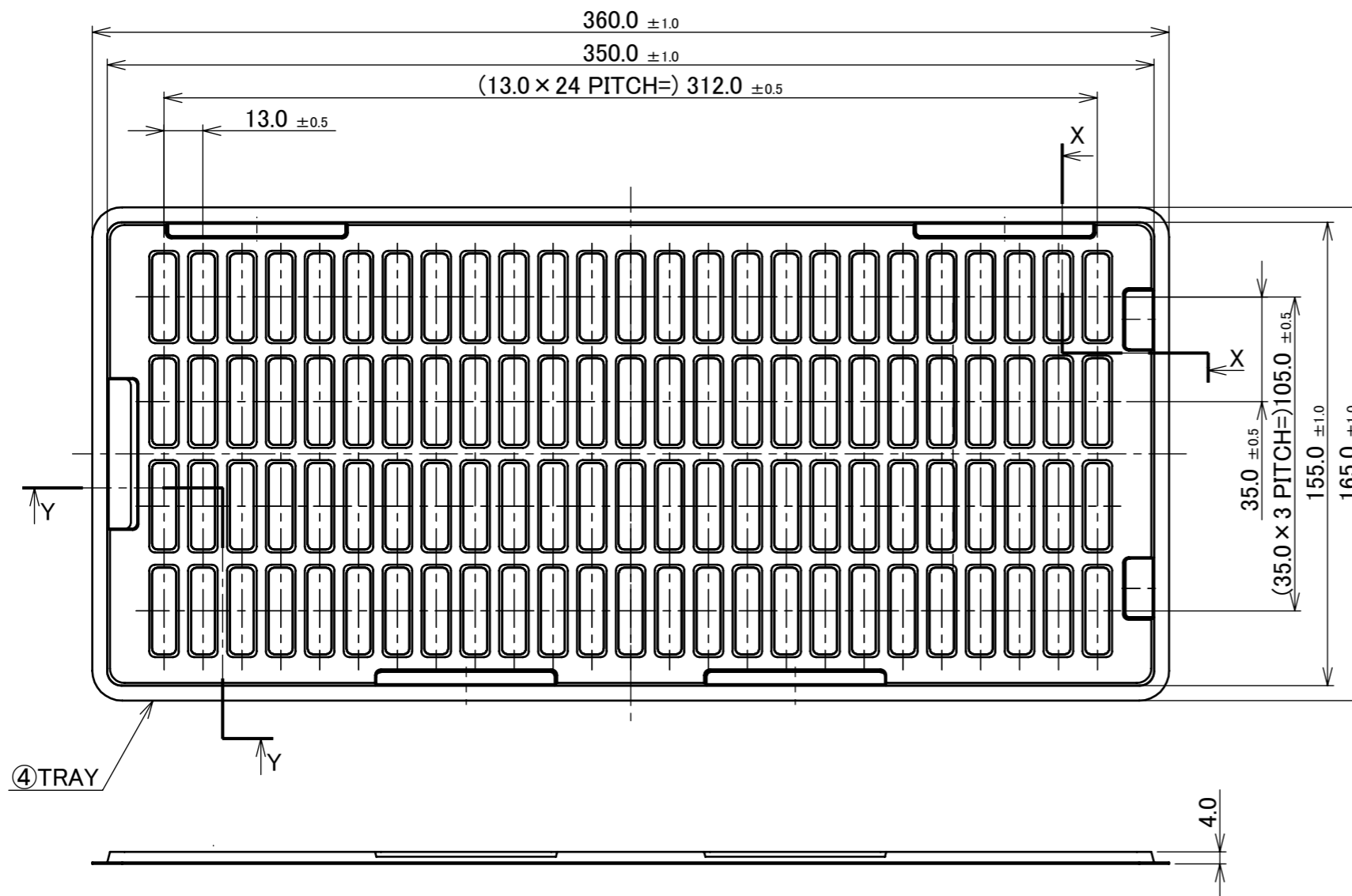

SECT. X-X
(S=2/1)

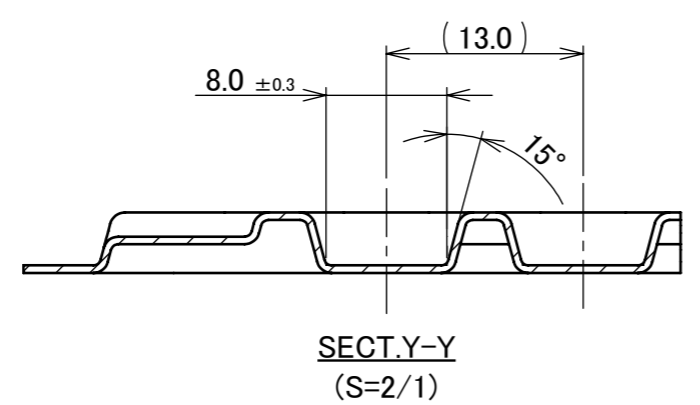

SECT. Y-Y
(S=2/1)

NO.	DESCRIPTION	MATERIAL	FINISH, REMARKS
4	TRAY	PP	ANTI-STATIC TYPE

ANGLE	±2°	6 OVER 30 MAX.	±0.3	PROJECTION ⊕	SERIES No. R1	CUSTOMER COPY	
6 MAX.	±0.2	30 OVER 120 MAX.	±0.5				
GENERAL TOLERANCE.				TITLE	SCALE	I-PEX	
DWG.	DATE			CABLIN [®] -CA II CABLIN [®] -CA II PLUS PLUG HOUSING ASSY	1:2		
CHK.	DATE				UNIT		mm
APP.	DATE				DWG. No.		20680
				SIZE	A3	SHEET 2/3 REV. 7	

PART NO.	QTY. IN DITCH (PIECES / DITCH)	QTY. IN TRAY (PIECES / TRAY)	QTY. IN SHIPPING CARTON (TRAY / S CARTON)	QTY. IN PACKING CARTON (S CARTON / P CARTON)	PACKING STANDARD
20680-060T-01	1	100 / TRAY	20 / S CARTON = 2000	4 / P CARTON = 8000	PST-15025

FOR 60P

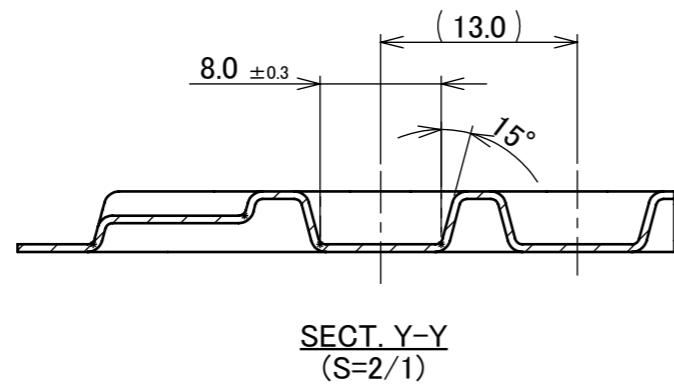
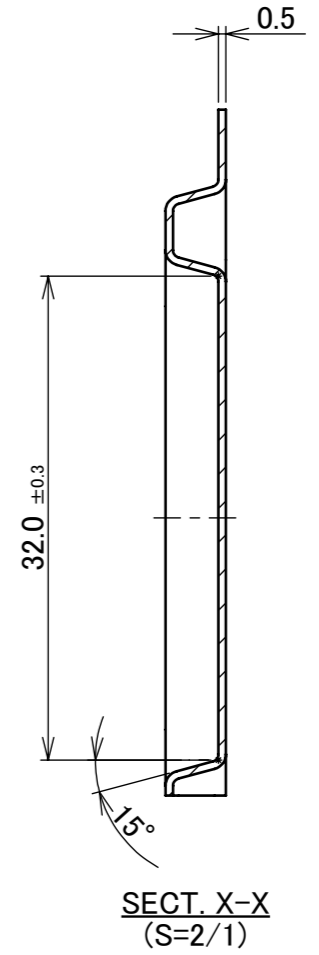
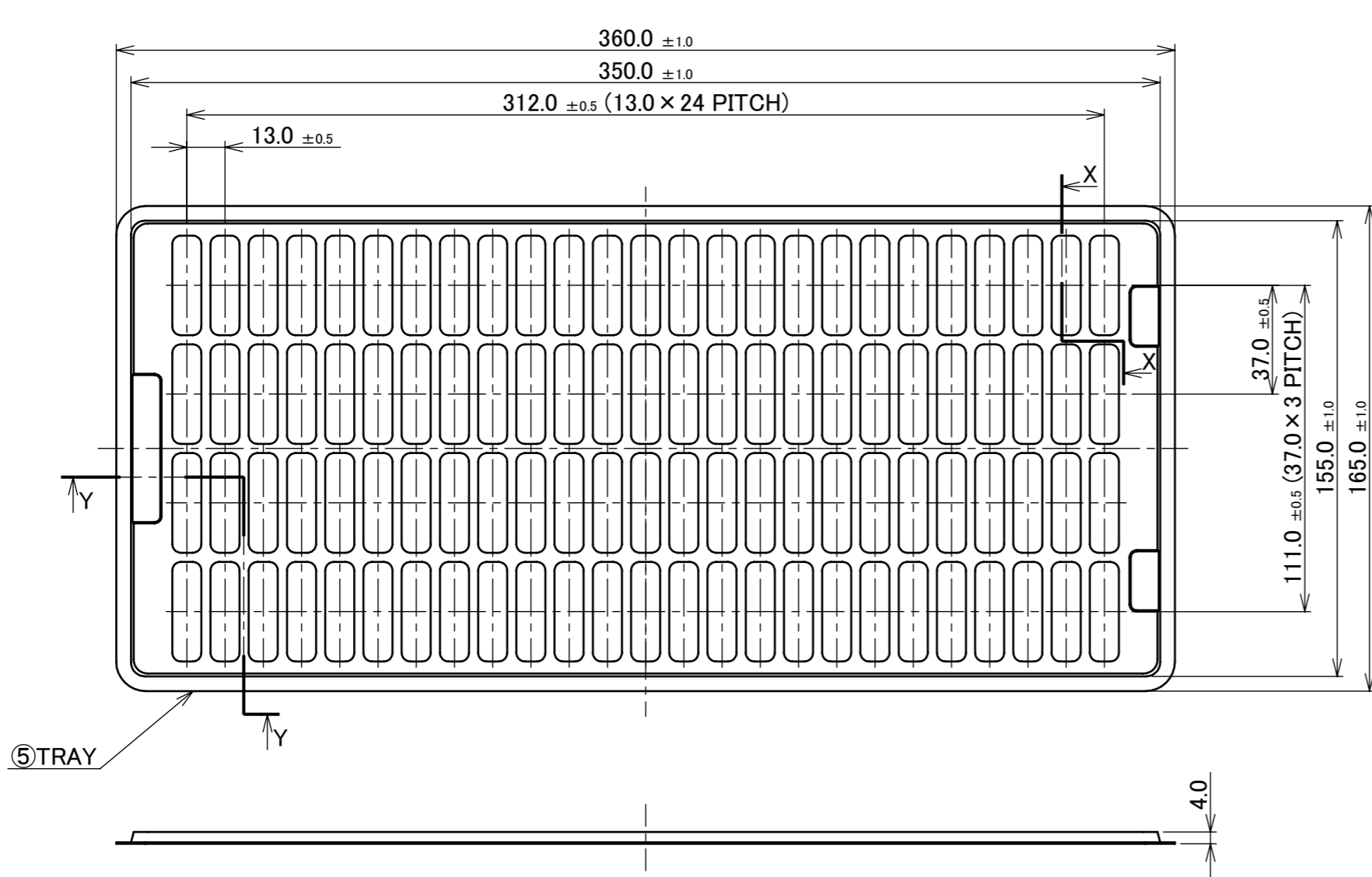

NO.	DISCRIPTION	MATERIAL	FINISH , REMARKS
5	TRAY	PS	ANTI-STATIC TYPE

ANGLE	±2°	6 OVER 30 MAX.	±0.3	PROJECTION ⊕	SERIES No. R1	CUSTOMER COPY
6 MAX.	±0.2	30 OVER 120 MAX.	±0.5			
GENERAL TOLERANCE.				TITLE	SCALE	I-PEX
DWG.	DATE			CABLIN [®] -CA II	1:2	
CHK.	DATE			CABLIN [®] -CA II PLUS	UNIT	
APP.	DATE			PLUG HOUSING ASS'Y	mm	
				DWG. No.	SIZE	SHEET 3/3 REV. 7
				20680	A3	