

Recommended P/N 20858-0\*\*T-01

PART NO.	Pos.	A	B	C
20858-040T-01	40	20.65	18.66	20.40
20858-060T-01	60	28.65	26.66	28.40



Halogen Free



RoHS Compliant

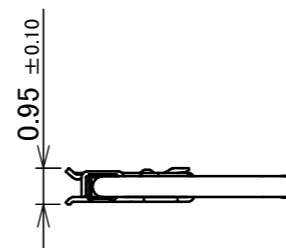
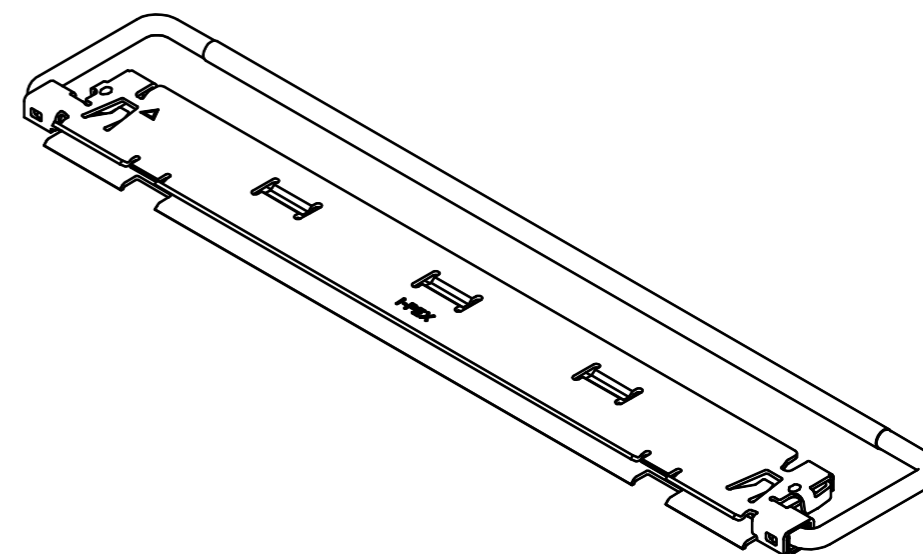
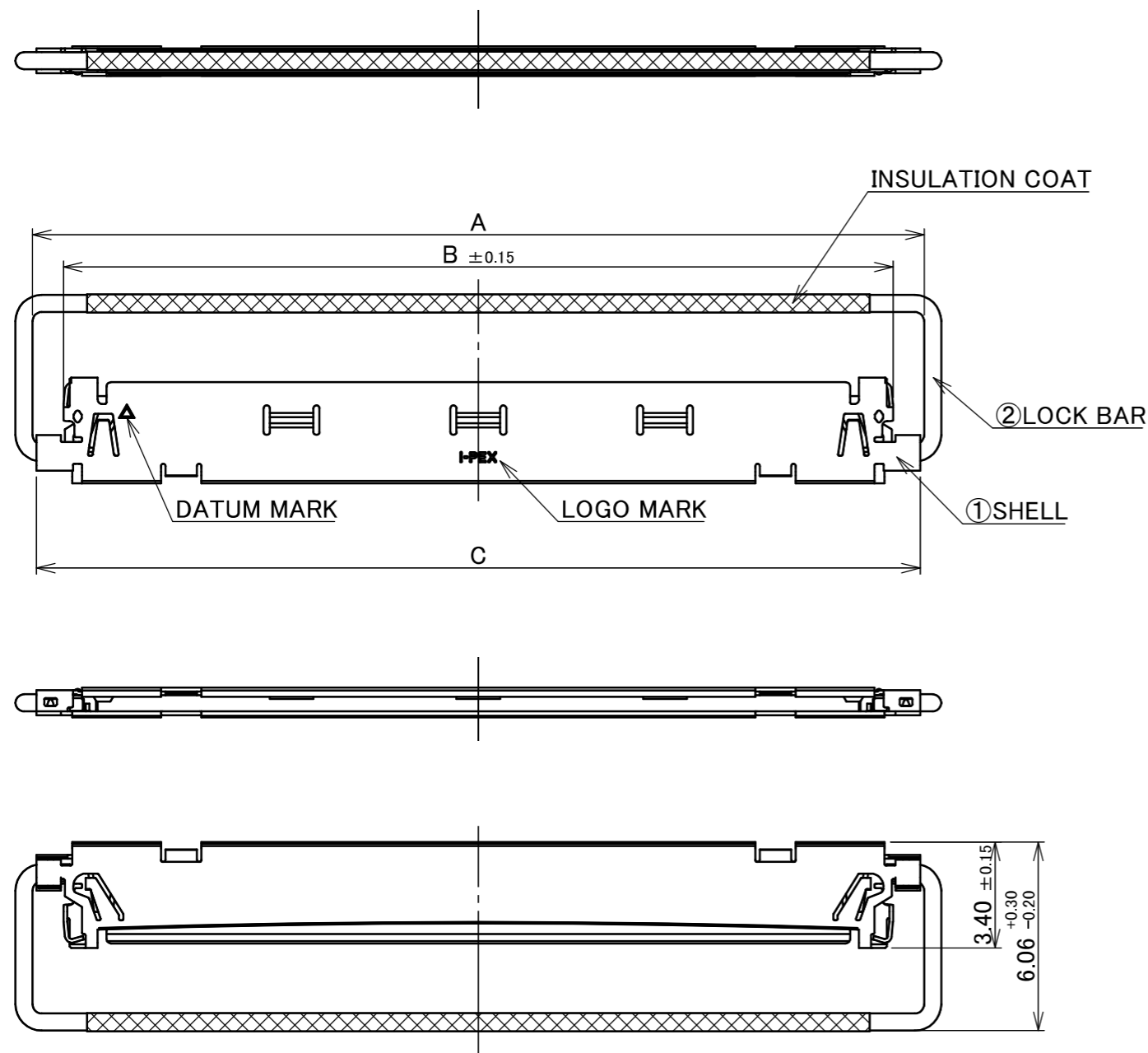

2	LOCK BAR	SUS	-
1	SHELL	PHOSPHOR BRONZE	PARTIAL Au 0.003 μm MIN. OVER Ni 1.00 μm MIN.
NO.	DISCRIPTION	MATERIAL	FINISH , REMARKS

9	Z250410	T.O	2025/03/12	T.M	ANGLE	±2°	6 OVER 30 MAX.	±0.3	PROJECTION ⊕	SERIES No. R1	CUSTOMER COPY			
8	Z240413	T.O	2024/04/04	T.M	6 MAX.	±0.2	30 OVER 120 MAX.	±0.5						
7	Z240332	T.O	2024/03/18	T.M	GENERAL TOLERANCE.				TITLE CABLIN <sup>®</sup> -CAF SHELL ASSEMBLY	SCALE 5:1 UNIT mm	I-PEX			
6	Z230865	T.O	2023/07/26	H.I	DWG.	Y.Sasa	DATE	2018/12/25						
5	Z230463	T.O	2023/04/21	H.I	CHK.	T.Masunaga								
4	Z230351	T.O	2023/03/27	H.I	APP.	H.Ikari								
REV.	ECN	BY	DATE	APP.	APP.	REVISION RECORD				DWG. No.	20858	SIZE A3	SHEET 1/6	REV. 9

PART NO.	Pos.	B	C	D	E	F
20858-040T-01	40	18.66	20.40	21.75	16.40	15.60
20858-060T-01	60	26.66	28.40	29.75	24.40	23.60

# FPC ASSEMBLY STATE



Halogen Free



RoHS Compliant

PLUG SHELL ASSEMBLY : CABLINE-CAF  
P/N : 20858-0\*\*T-01

RECEPTACLE : CABLINE-CA  
P/N : 20525-\*\*\*E-0##

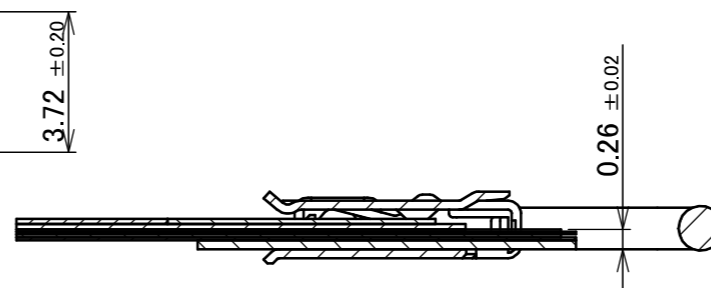
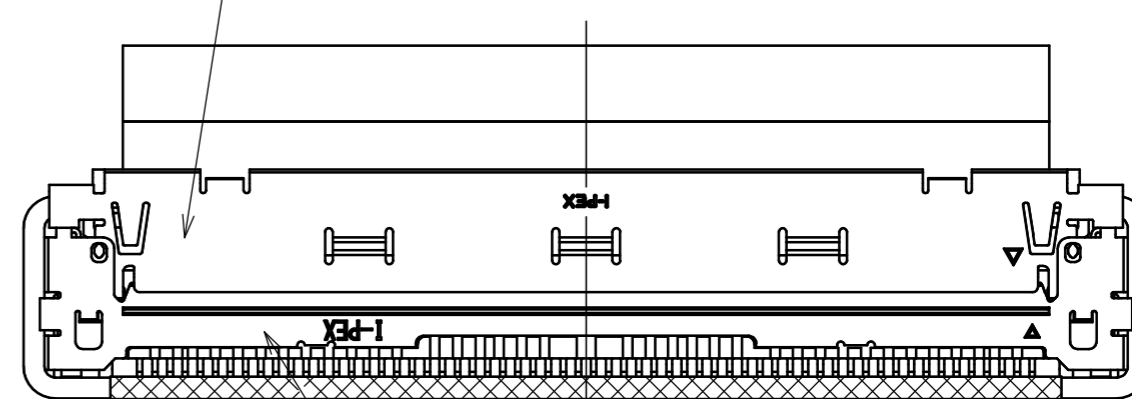
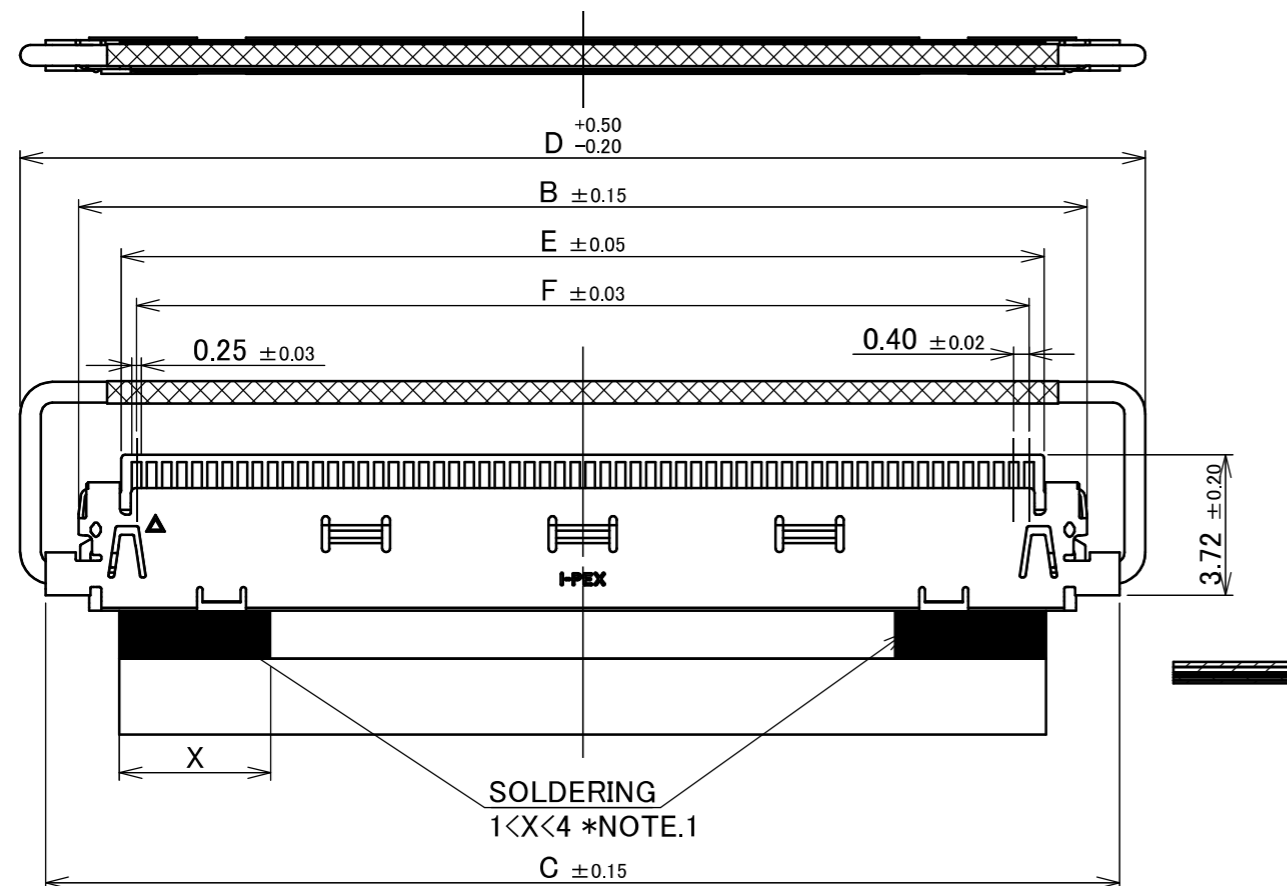

SECT A-A  
(S=10/1)

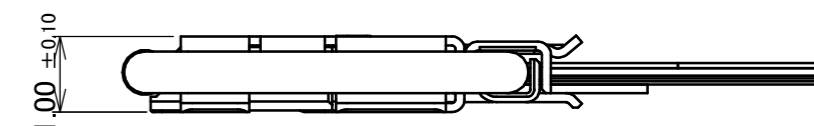

MATING CONDITION  
(S=10/1)

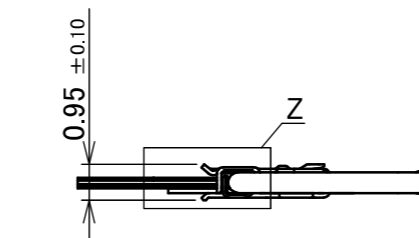
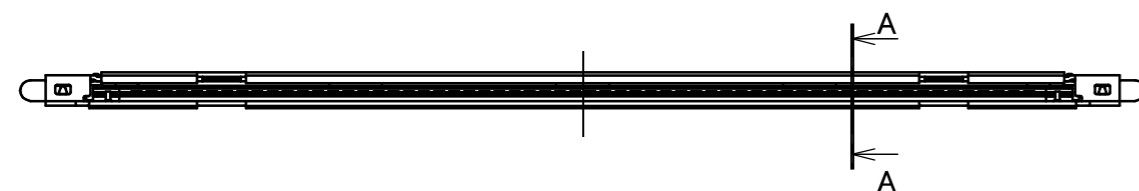

SOLDERING



DETAIL Z  
(S=20/1)

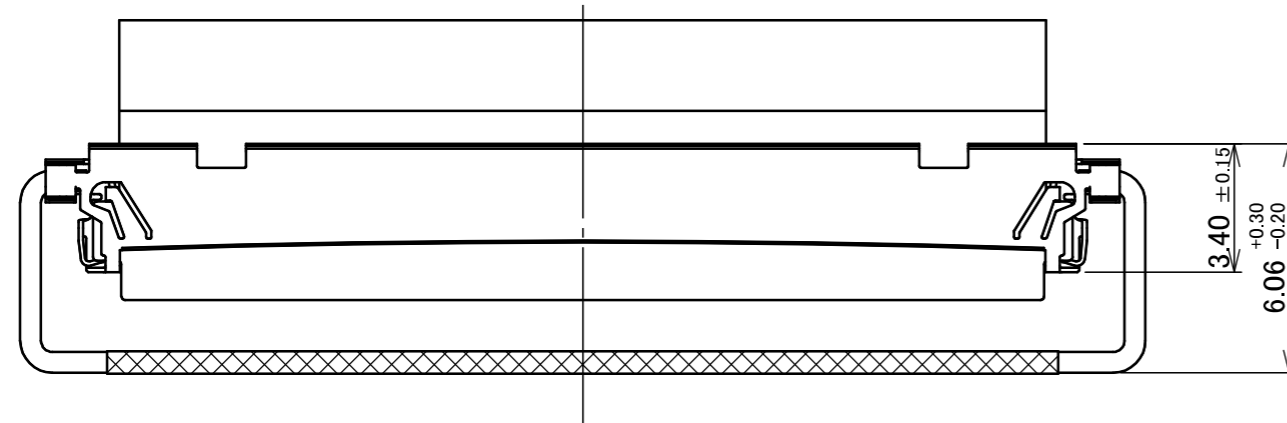
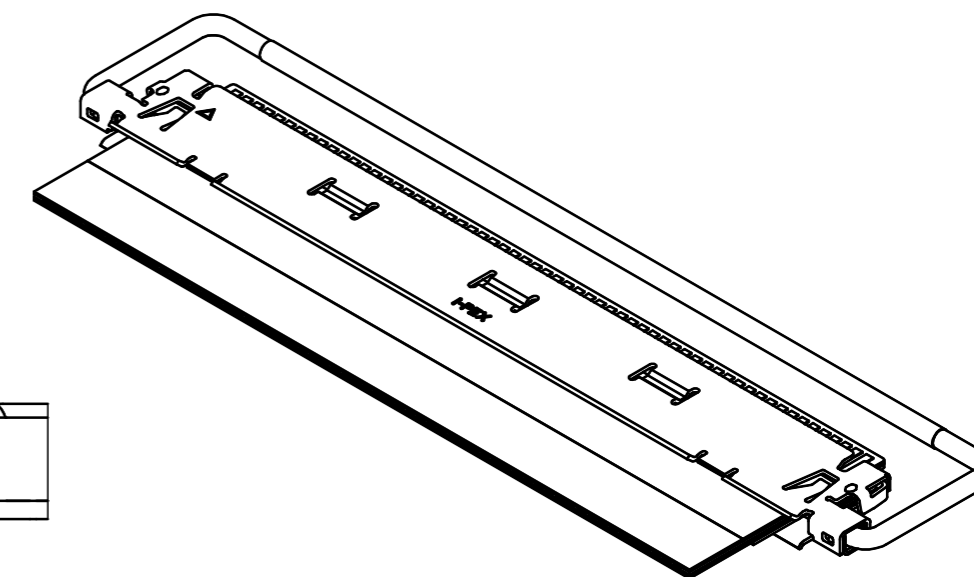

NOTES.

- SOLDERING AREA X IS RECOMMENDED DIMENSION. IT DOES NOT MATTER IF IT MIGHT BE EXCEED THE DIMENSION.

ANGLE	±2°	6 OVER 30 MAX.	±0.3	PROJECTION 	SERIES No. R1	CUSTOMER COPY			
	6 MAX.	±0.2	30 OVER 120 MAX.						±0.5
GENERAL TOLERANCE.				TITLE CABLINE® -CAF SHELL ASSEMBLY		SCALE 5:1	I-PEX		
DWG.	DATE			DWG. No. 20858		UNIT mm			

ITEMS	SPECIFICATION
RATING VOLTAGE	100V AC (PER CONTACT)
RATING AMPERAGE (FOR SIGNAL CONTACT)	0.5A AC/DC (PER CONTACT) ※AVAILABLE UP TO 14PIN 0.3A AC/DC (PER CONTACT) ※AVAILABLE UP TO ALL PIN
OPERATING TEMPERATURE	233~358K(-40°C~+85°C)
OPERATING HUMIDITY	85% MAX.(NON-CONDENSING)
CONTACT RESISTANCE (FOR SIGNAL CONTACT)	INITIAL : 60mohm MAX. / AFTER TEST : $\triangleleft$ 40mohm MAX.
GROUND SHELL RESISTANCE	INITIAL : 60mohm MAX. / AFTER TEST : $\triangleleft$ 40mohm MAX.
INSULATION RESISTANCE	INITIAL : 1000Mohm MIN. / AFTER TEST : 500Mohm MIN.
DIELECTRIC WITHSTANDING VOLTAGE	AC250V 1min
DURABILITY	30 CYCLES
MATING FORCE (INITIAL / AFTER TEST)	40P : 11.07N MAX. 60P : 16.61N MAX.
UNMATING FORCE (INITIAL / AFTER TEST)	40P : 1.44N MIN. 60P : 2.16N MIN.
PRODUCT SPECIFICATION	PRS-2465
TEST REPORT	TR-18016
PACKING STANDARD	PST-17138
INSTRUCTION MANUAL	HIM-18016
ASSEMBLY MANUAL	ASM-18005
APPEARANCE CRITERIA No.	QLS-A***

ANGLE	$\pm 2^\circ$	6 OVER 30 MAX.	$\pm 0.3$	PROJECTION 	SERIES No. R1	CUSTOMER COPY				
6 MAX.	$\pm 0.2$	30 OVER 120 MAX.	$\pm 0.5$			SCALE -	<b>I-PEX</b>	UNIT mm	SIZE A3	SHEET 3/6
GENERAL TOLERANCE.				TITLE CABLIN <sup>®</sup> -CAF SHELL ASSEMBLY						
DWG.	DATE									
CHK.										
APP.				DWG. No. 20858						

PART NO.	Pos.	E	F	G	H
20858-040T-01	40	16.40	15.60	17.90	16.50
20858-060T-01	60	24.40	23.60	25.90	24.50

## RECOMMENDED FPC LAYOUT 【SHIELDED FPC】

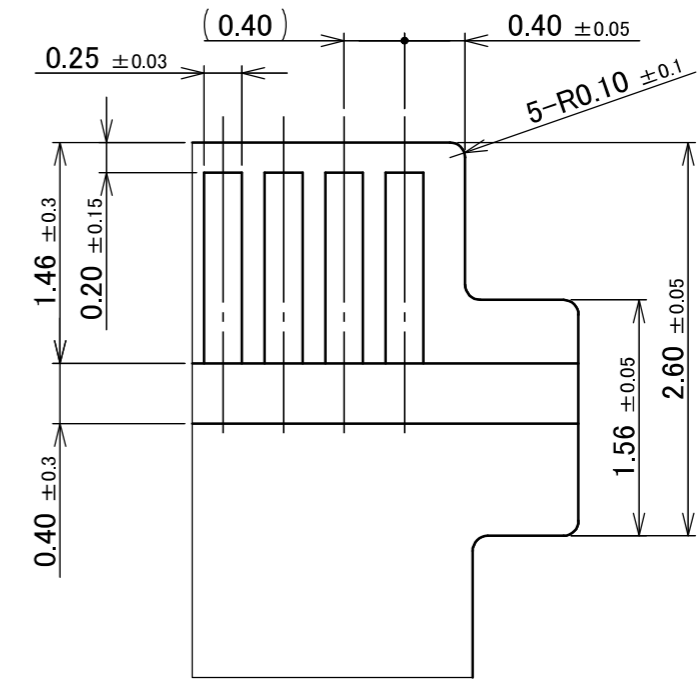
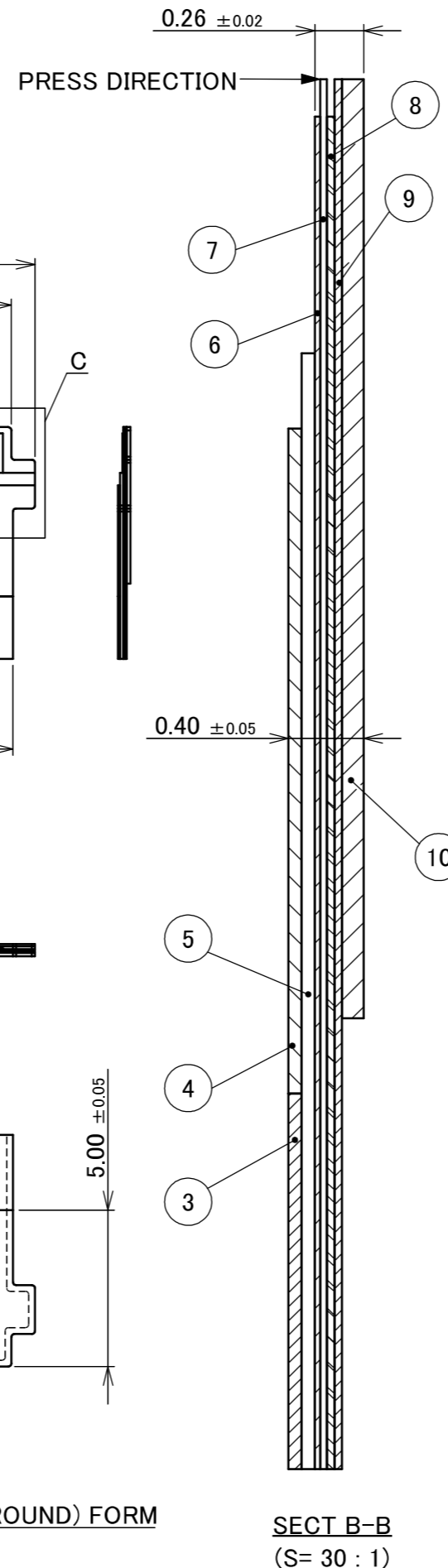
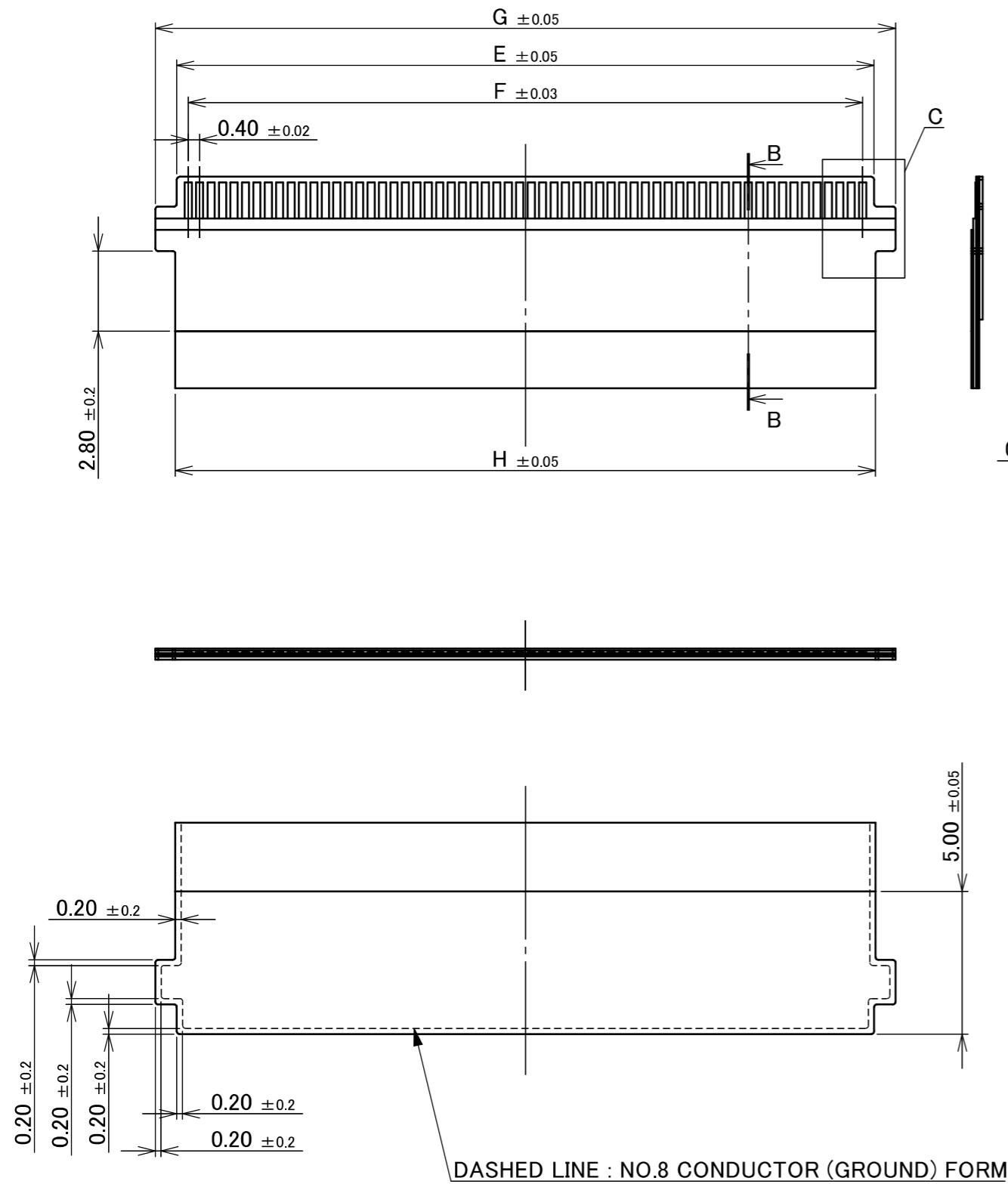

DETAIL C  
(S=20:1)

NOTES.

- ADHESIVE SHOULD USE THERMOSETTING.
- NO.3 : SHIELD FILM AND NO.4, NO.8 : CONDUCTOR (GROUND) ARE CARRYING OUT THE ELECTRICAL CONNECTION.
- NO.4 : CONDUCTOR (GROUND) AND NO.8 : CONDUCTOR (GROUND) ARE CARRYING OUT THE ELECTRICAL CONNECTION.
- NO.3 : SHIELD FILM AND NO.6 : CONDUCTOR (SIGNAL) ARE NOT CONTACTING.
- NO.4, NO.8 : CONDUCTOR (GROUND) AND NO.6 : CONDUCTOR (SIGNAL) ARE NOT CONTACTING.

No.	DESCRIPTION	MATERIAL	PLATING
3	SHIELD FILM	-	-
4	CONDUCTOR (GROUND)	Cu	Ni, Au
5	INSULATOR	-	-
6	CONDUCTOR (SIGNAL)	Cu	Ni, Au
7	INSULATOR	-	-
8	CONDUCTOR (GROUND)	Cu	Ni
9	INSULATOR	-	-
10	REINFORCING TAPE	-	-

ANGLE	±2°	6 OVER 30 MAX.	±0.3	PROJECTION ⊕	SERIES No. R1	CUSTOMER COPY					
	6 MAX.	±0.2	30 OVER 120 MAX.						±0.5		
GENERAL TOLERANCE.				TITLE CABLINER® -CAF SHELL ASSEMBLY	SCALE 5:1	I-PEX					
DWG.	DATE								UNIT mm		
CHK.									SIZE A3	SHEET 4/6	REV. 9
APP.									DWG. No. 20858		

PART NO.	Pos.	E	F	G	H
20858-040T-01	40	16.40	15.60	17.90	16.50
20858-060T-01	60	24.40	23.60	25.90	24.50

## RECOMMENDED FPC LAYOUT 【NON SHIELDED FPC】

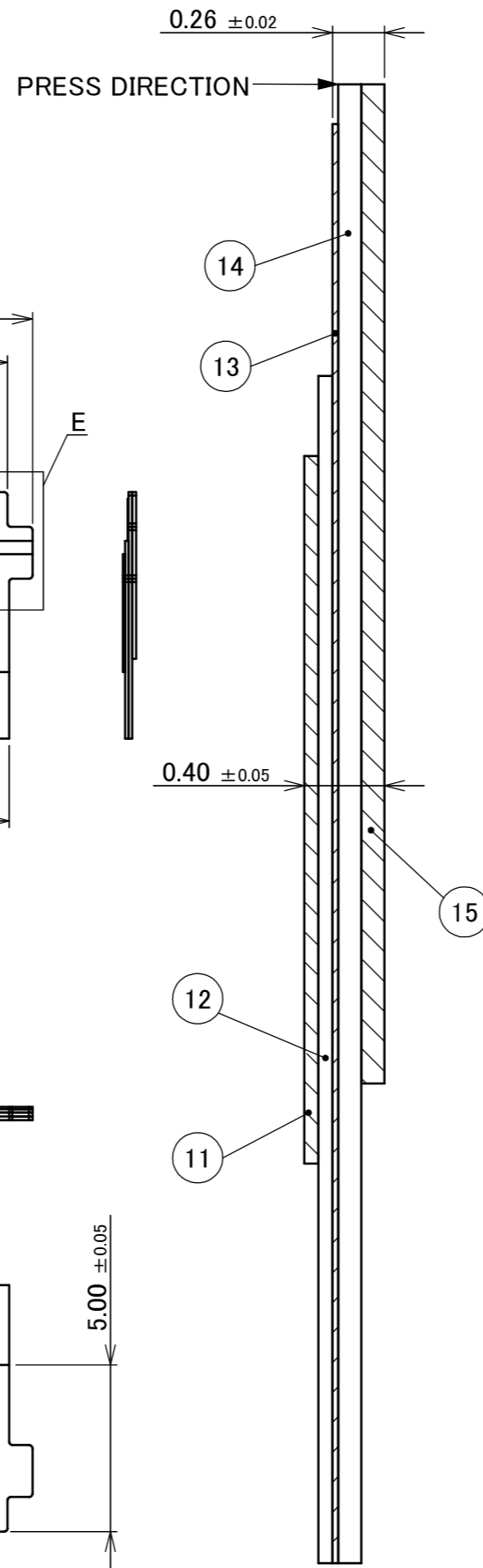
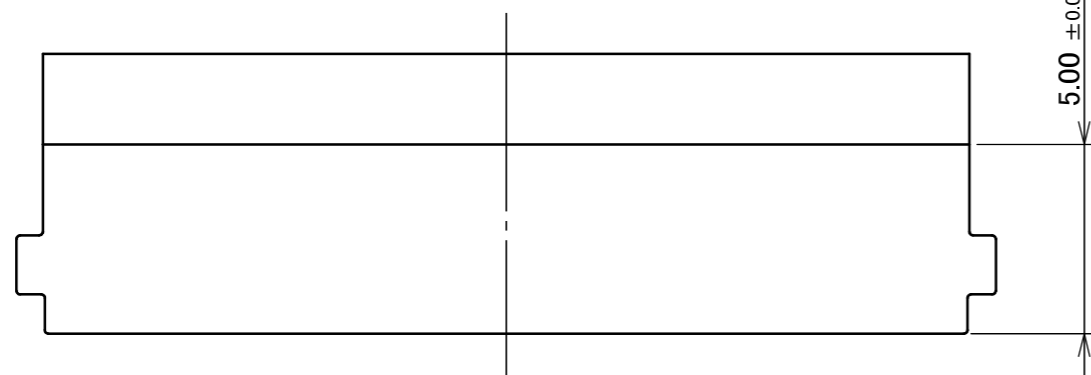
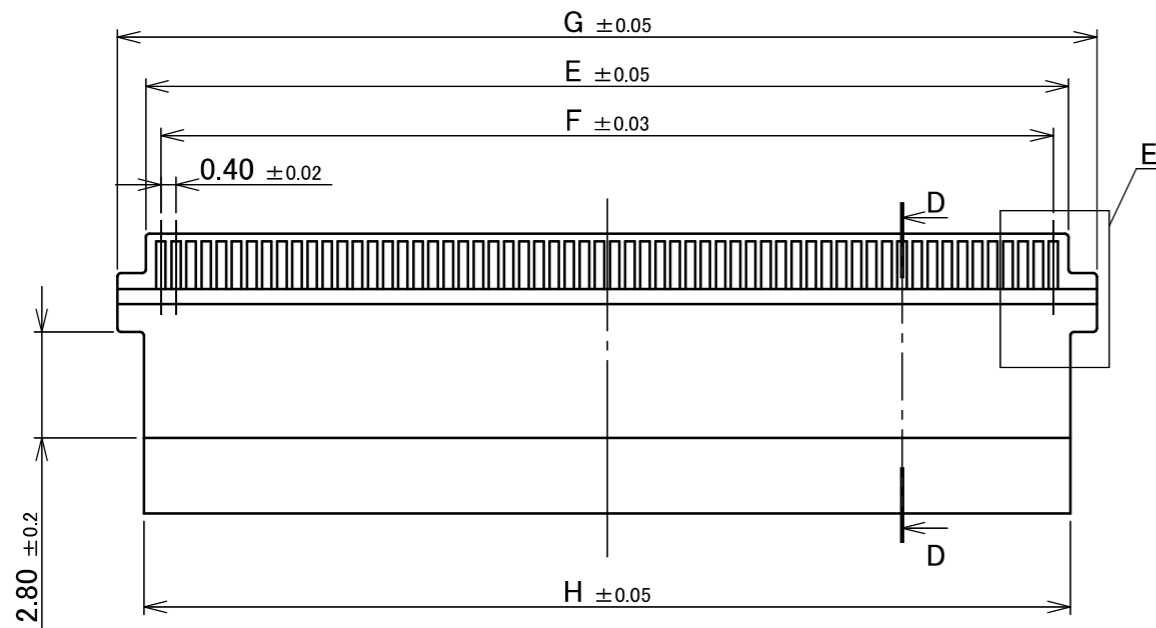

SECT D-D  
(S= 30 : 1)

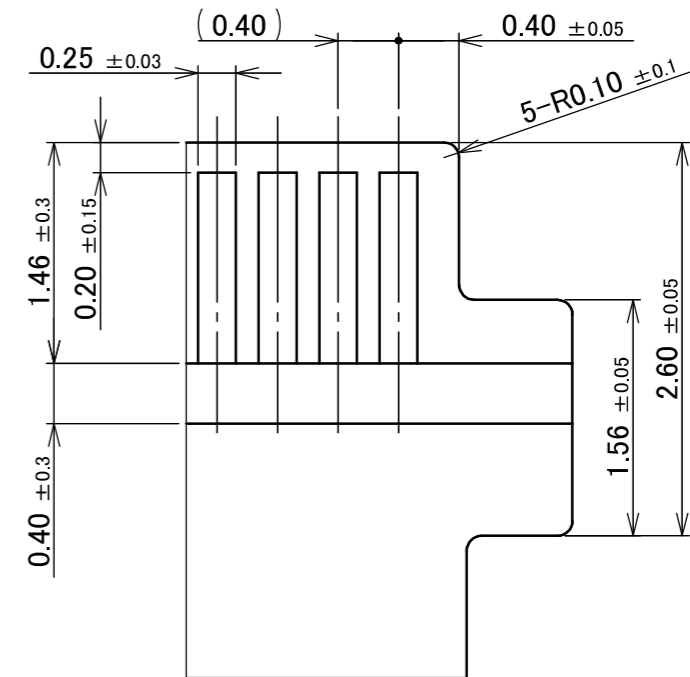

DETAIL E  
(S=20:1)

### NOTES.

- ADHESIVE SHOULD USE THERMOSETTING.
- NO.11 : CONDUCTOR (GROUND) AND NO.1: SHELL ARE CARRYING OUT THE ELECTRICAL CONNECTION BY SOLDERING.
- NO.11 : CONDUCTOR (GROUND) AND NO.13 : CONDUCTOR (SIGNAL) ARE NOT CONTACTING.

No.	DESCRIPTION	MATERIAL	PLATING
11	CONDUCTOR (GROUND)	Cu	Ni, Au
12	INSULATOR	-	-
13	CONDUCTOR (SIGNAL)	Cu	Ni, Au
14	INSULATOR	-	-
15	REINFORCING TAPE	-	-

ANGLE	$\pm 2^\circ$	6 OVER 30 MAX.	$\pm 0.3$	PROJECTION	SERIES No.	CUSTOMER COPY		
6 MAX.	$\pm 0.2$	30 OVER 120 MAX.	$\pm 0.5$		R1			
GENERAL TOLERANCE.				TITLE	SCALE	<b>I-PEX</b>		
DWG.	DATE			CABLIN <sup>®</sup> -CAF SHELL ASSEMBLY	5:1			
CHK.					UNIT			
APP.					mm			
				DWG. No.	20858	SIZE	SHEET	REV.
						A3	5/6	9

PART NO.	J	QTY. IN DITCH (PIECES / DITCH)	QTY. IN TRAY (PIECES / TRAY)	QTY. PER SHIPPING CARTON (TRAYS / S CARTON)	QTY. PER PACKING CARTON (S CARTON / P CARTON)
20858-040T-01	29.00	1	100	20 / S CARTON =2000	4 / P CARTON = 8000
20858-060T-01	32.00	1	100	20 / S CARTON =2000	4 / P CARTON = 8000

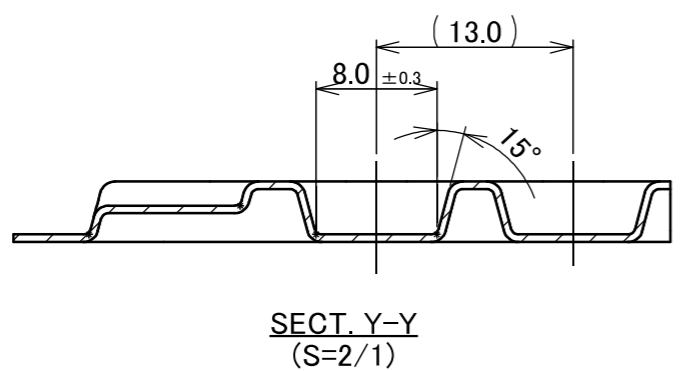
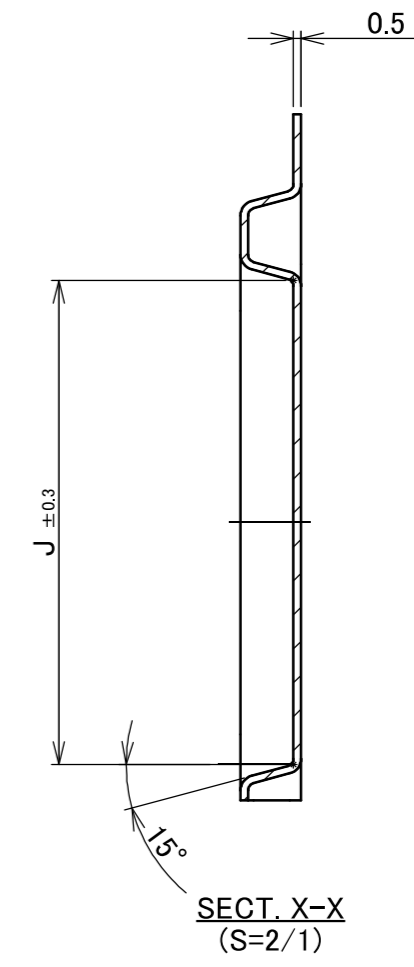
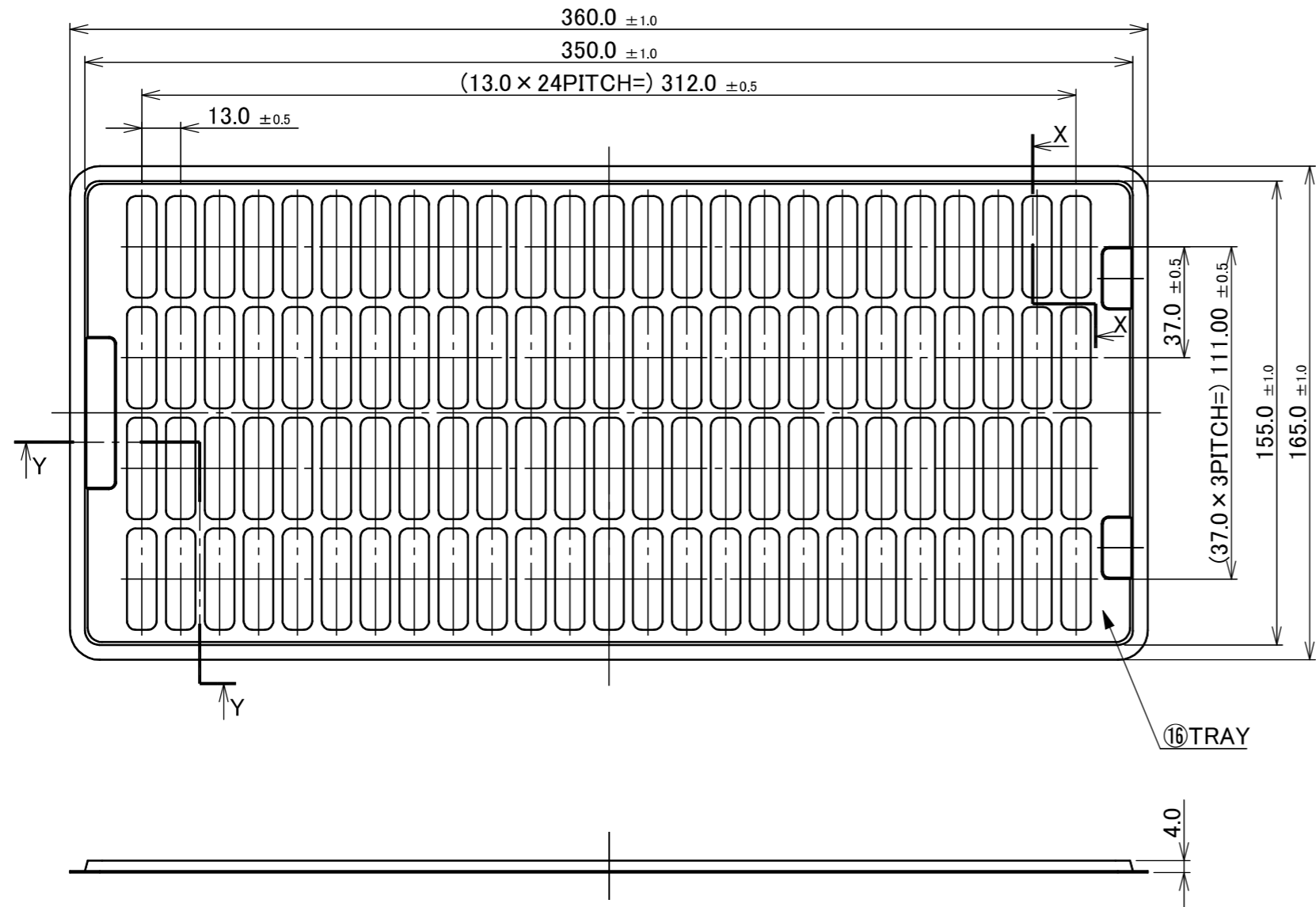

16	TRAY	PP	ANTI-STATIC TYPE
NO.	DISCRIPTION	MATERIAL	FINISH , REMARKS
ANGLE	±2°	6 OVER 30 MAX.	±0.3
6 MAX.	±0.2	30 OVER 120 MAX.	±0.5
GENERAL TOLERANCE.		PROJECTION	SERIES No.
DWG.	DATE		R1
CHK.		TITLE	
APP.		CABLIN® -CAF SHELL ASSEMBLY	
		DWG. No.	20858
		SCALE	1:2
		UNIT	mm
		SIZE	A3
		SHEET	6/6
		REV.	9

Confidential C

I-PEX Inc.

QKE-DFE06-02 REV.12